

**400 Series**  
**Engine & Equipment**  
**Model**

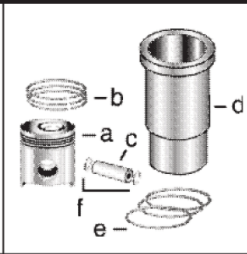

**4.270**

> 280,000

4 Cyl

Bore: 4.25 in  
 108 mm  
 Pin Ø: 1.50 in  
 38 mm

**Block (m):**  
 R26160, R32020,  
 R40850

**APPLICATIONS:**

**AGRICULTURAL**  
 3010  
 3020

**CONSTRUCTION**

500  
 500A  
 500B  
 500C  
 510

**1) Engine O/H Kit**      **Piston-Liner Kit**      **Main Bearing**      **Thrust Bearing**      **Con Rod Bearing**

<b>2) Engine I/F Kit</b>	<b>TRE23173</b> Consists of:	<b>TAR49243</b> Std.	<b>TAR49242</b> Std.	<b>TAR45723</b> Std.
<b>1) TRG17899</b>	a) <b>TRE23172</b>	<b>TAR49245</b> .010	<b>TAR49238</b> .010	<b>TAR46396</b> .010
<b>2) TIK17899</b>	b) <b>TAR55630</b>	<b>TAR49246</b> .020	<b>TAR49239</b> .020	<b>TAR46397</b> .020
	c) <b>TR44161</b>	<b>TAR49247</b> .030	<b>TAR49240</b> .030	<b>TAR46398</b> .030
	d) <b>TR32050</b>			
	e) <b>TAR40155</b>			
	f) <b>TH80753</b>			
		<b>Use 4</b>	<b>Use 1</b>	<b>Use 4</b>

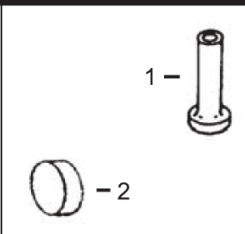
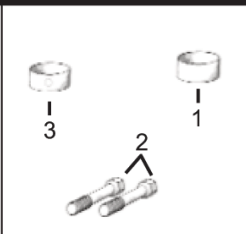
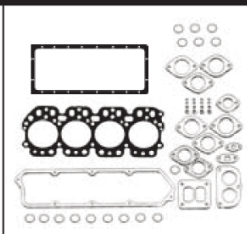
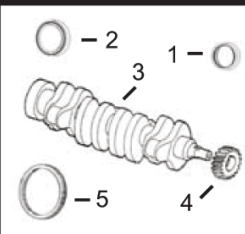

**1) Front Seal**      **1) O/H Gasket Set**      **1) Bush, Con Rod**  
**2) Rear Seal**      **2) Bolt, Con Rod**      **2) Bolt, Con Rod**  
**3) Bushing, Cam**

**3) Crankshaft**      **2) Head Gasket Set**  
**4) Crankshaft, Gear**      **3) Head Gasket**  
**5) Ring Gear**      **4) Oil Pan Gasket**

1) <b>TAR49025</b>	1) <b>TAR53033</b>	1) <b>TR30939</b> x4	1) <b>TR26342</b>	
2) <b>TRE520036</b>	2) <b>TAR53032</b>	2) <b>TR66452</b> x8	2) <b>TR26115</b>	
3) <b>TAR40485</b> (1)	3) <b>TR45616</b>	3) <b>TR46903</b> x3		
c/s (m) R40570				
4) <b>TR26049</b> (23T)	4) <b>TR71917</b>			
5) <b>TR28811</b> (129T)				

**Valve, Intake**      **Valve, Exhaust**      **Insert, Valve**  
 1) Intake      1) Intake      1) Intake  
 2) Exhaust      2) Exhaust      2) Exhaust

1) <b>TR26124</b> Std.	1) <b>TR26123</b> Std.	1) <b>TR43680</b> Std.	1) N/A	1) <b>TR26125</b>
ES > 157,001	ES > 157,001	2) <b>TR43681</b> Std.	2) N/A	2) <b>TR28654</b>
1) <b>TR44174</b> Std.	1) <b>TR44175</b> Std.			3) <b>TR87627</b>
ES 157,002-280,000	ES 157,002-280,000			

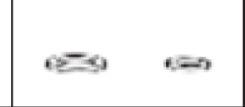

<b>Thermostat</b>	<b>Fuel Transfer Pump</b>	<b>Water Pump Repair Kit</b>		<b>Injector, Pencil</b>	<b>Seal, Injector</b>
		Without Impeller	With Impeller		
<b>TR36846</b> 180° F	<b>TAR53567</b> <b>TRE42211</b>	<b>See Chart</b>		<b>TAR50781</b>	<b>TR60746</b> <b>TR48000</b>

(1) New style crankshaft. To adapt to old style center hole needs to be enlarged 2.835 in. (72.0009 mm). Extra bolt holes need to be plugged with Allen head screws and tread lock.