

**300 Series**  
**Engine & Equipment**  
**Model**

**6.329**

> 277,548

O'rings on liner

Small Pin

6 Cyl

Bore: 4.02 in  
 102 mm  
 Pin Ø: 1.185 in  
 30 mm

Con Rod (m):  
 T20007, R81410

**APPLICATIONS:**

**AGRICULTURAL**  
 699  
 3120

**CONSTRUCTION**  
 540A

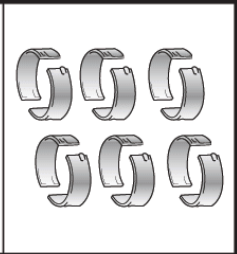
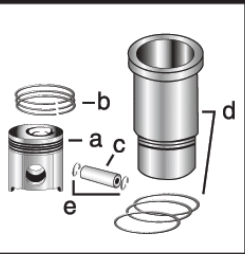
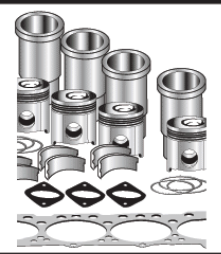

<b>1) Engine O/H Kit</b>	<b>Piston-Liner Kit</b>	<b>Main Bearing</b>	<b>Thrust Bearing</b>	<b>Con Rod Bearing</b>
--------------------------	-------------------------	---------------------	-----------------------	------------------------



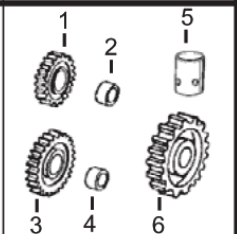
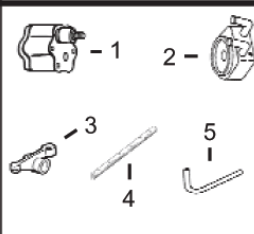
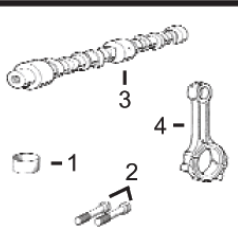
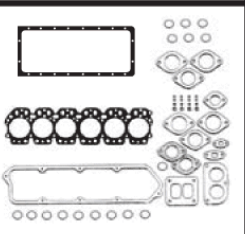
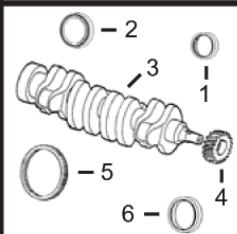

<b>2) Engine I/F Kit</b>	<b>TPLK310</b> Consists of: a) <a href="#">TAR78310</a> b) <a href="#">TAR55759</a> c) <a href="#">TT26149</a> d) <a href="#">TAR51903</a> e) <a href="#">TR51112</a>	<a href="#">TRE27352</a> Std.  <a href="#">TRE27353</a> .010 <a href="#">TRE27360</a> .020 <a href="#">TRE27368</a> .030	<a href="#">TAT21139</a> Std.  <a href="#">TAT21132</a> .010 <a href="#">TAT21134</a> .020 <a href="#">TAT21136</a> .030	<a href="#">TRE27348</a> Std.  <a href="#">TRE27349</a> .010 <a href="#">TRE27358</a> .020 <a href="#">TRE27364</a> .030
<b>1) <a href="#">TOK6310</a></b>				
<b>2) <a href="#">TIK6310</a></b>		<b>Use 6</b>	<b>Use 1</b>	<b>Use 6</b>



<b>1) Front Seal</b> <b>2) Rear Seal</b>	<b>1) O/H Gasket Set</b>	<b>1) Bush, Con Rod</b> <b>2) Bolt, Con Rod</b>	1) Pump, Oil 2) Oil Cooler 3) Rocker Arm 4) Rocker Shaft 5) Pump, Oil Tube	1) Lower Gear 2) Lower Bushing 3) Upper Gear 4) Upper Bushing 5) Cam. Follower 6) Cam. Gear
3) Crankshaft 4) Crankshaft, Gear 5) Ring Gear 6) Sleeve, Front	2) Head Gasket Set 3) Head Gasket 4) Oil Pan Gasket 5) Rocker Cover Gsk	3) Camshaft 4) Con Rod		

1) <a href="#">TAR67942</a> 2) <a href="#">TRE44574</a> 3) <a href="#">TAT22562</a> 4) <a href="#">TT20094</a> 5) <a href="#">TR114282</a> (142T) 6) <a href="#">TR81989</a>	1) <a href="#">TRE501580</a> 2) <a href="#">TRE38852</a> 3) <a href="#">TR114157</a> 4) <a href="#">TR97344</a> 5) <a href="#">TR75728</a>	1) <a href="#">TT23471</a> x6 2) <a href="#">TR74194</a> x12 (1) 3) <a href="#">TR82821</a> (2) 4) <a href="#">TAT18005</a>	1) <a href="#">TRE55343</a> 2) <a href="#">TRE31929</a> 3) <a href="#">TRE31973</a> 4) <a href="#">TR54986</a> 5) <a href="#">TR113752</a>	1) <a href="#">TAT24252</a> 2) <a href="#">TT26321</a> 3) <a href="#">TAT18009</a> 4) <a href="#">TT20034</a> 5) <a href="#">TT20073</a> 6) <a href="#">TT20070</a>
---	--	--	--	--

	Valve, Intake	Valve, Exhaust	Insert, Valve 1) Intake 2) Exhaust	1) Cap, Valve 2) Lock, Valve	1) Spring, Valve 2) Rotator, Valve 3) O'ring, Valve
	<a href="#">TR79623</a> Std. <a href="#">TR79628</a> .003 <a href="#">TR79629</a> .015	<a href="#">TR79624</a> Std. <a href="#">TR79625</a> .003 <a href="#">TR79626</a> .015	1) <a href="#">TR73064</a> Std. 2) <a href="#">TR51734</a> Std.	1) <a href="#">TT20129</a> 2) <a href="#">TT20077</a>	1) <a href="#">TR26125</a> 2) <a href="#">TRE11410</a> 3) <a href="#">TR87627</a>

					
Thermostats	Fuel Transfer Pump	Water Pump Repair Kit		Injector, Pencil	Seal
<a href="#">TAR70601</a> 180 °F (*) <a href="#">TAR77411</a> 195 °F (*)	<a href="#">TRE42211</a>	Without Impeller <a href="#">TMX9398</a>	With Impeller <a href="#">TMX131</a>	<a href="#">TAR89564</a>	<a href="#">TR60746</a> <a href="#">TR48000</a>

(\*) Verify JD parts manual.  
 (1) Use [TR74194](#) with C.Rod (m) T20007; use [TR80033](#) with C.Rod (m) R81410.  
 (2) Threaded Type.