

300 Series
Engine & Equipment
Model
6.359T

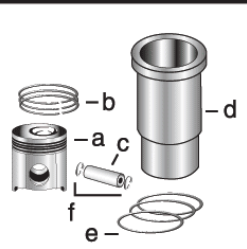

6 Cyl

Bore: 4.19 in
 106.5 mm

Pin Ø: 1.62 in
 41 mm

1) Engine O/H Kit

Piston-Liner Kit

Main Bearing

Thrust Bearing

Con Rod Bearing

2) Engine I/F Kit

TRE33115
 Consists of:
 a) [TRE19278](#)
 b) [TRE66820](#)
 c) [TR124230](#)
 d) [TR116281](#)
 e) [TAR65507](#)
 f) [TR54114](#)

[TRE27352](#) Std.
[TRE27353](#) .010
[TRE27360](#) .020
[TRE27368](#) .030
Use 6

[TAT21139](#) Std.
[TAT21132](#) .010
[TAT21134](#) .020
[TAT21136](#) .030
Use 1

[TRE27348](#) Std.
[TRE27349](#) .010
[TRE27358](#) .020
[TRE27364](#) .030
Use 6

APPLICATIONS:

AGRICULTURAL
 3140C 7445
 3540 7484
 3550 9400
 4050 9930
 7200

CONSTRUCTION
 444D
 544E/EH/G
 570B
 710B/C

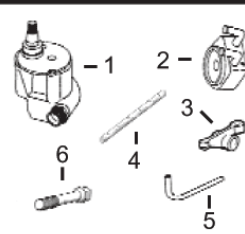
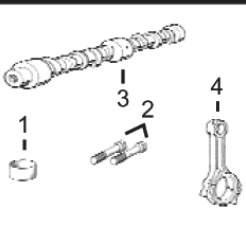
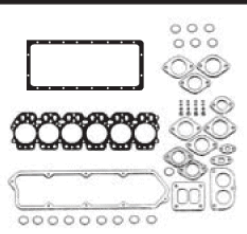
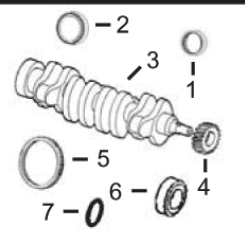

1) Front Seal
2) Rear Seal

1) O/H Gasket Set

1) Bush, Con Rod
2) Bolt, Con Rod

1) Pump, Oil
 2) Oil Cooler
 3) Rocker Arm
 4) Rocker Shaft
 5) Pump, Oil Tube
 6) Cyl Hd Cap Screw

1) Lower Gear
 2) Lower Bushing
 3) Upper Gear
 4) Upper Bushing
 5) Cam. Follower
 6) Cam. Gear

3) Crankshaft
 4) Crankshaft, Gear
 5) Ring Gear
 6) Sleeve, Front
 7) Packing, Sleeve

2) Head Gasket Set
 3) Head Gasket
 4) Oil Pan Gasket
 5) Rocker Cover Gsk

3) Camshaft
 4) Con Rod

1) [TAR67942](#)
 2) [TRE44574](#)
 3) [TAT22562](#)
 4) [TT20094](#)
 5) [TR28811](#) (129T)
 or
[TR114282](#) (142T)
 6) [TR81989](#)
 7) [TH35244](#)

1) [TRE501580](#)
 2) [TRE38852](#)
 3) [TR114157](#)
 4) [TR97344](#)
 5) [TR75728](#)

1) [TR57451](#) x6
 2) [TR80033](#) x12
 3) [TR82821](#) (6)
 4) [TRE58347](#)

1) [TRE65580](#) (3)
 2) [TRE31929](#)
 3) [TRE31973](#) (5)
 4) [TR54986](#)
 5) [TR113752](#)
 6) [TR85363](#) x26 (1)

1) [TAT24252](#)
 2) [TT26321](#)
 3) [TAT18009](#)
 4) [TT20034](#)
 5) [TT20073](#)
 6) [TT20070](#)



Valve, Intake
[TR83071](#) Std.
[TR89223](#) .003
[TR89224](#) .015

Valve, Exhaust (4)
[TR79624](#) Std.
[TR79625](#) .003
[TR79626](#) .015

Insert, Valve
 1) Intake
 2) Exhaust
 1) [TR73064](#) Std.
 2) [TR51734](#) Std.

1) Cap, Valve
 2) Lock, Valve
 1) [TT20129](#)
 2) [TT20077](#)

1) Spring, Valve
 2) Rotator, Valve
 3) O'ring, Valve
 1) [TR26125](#)
 2) [TRE11410](#)
 3) [TR87627](#)

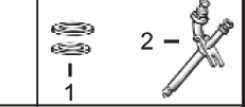
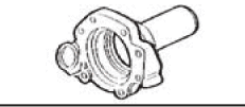
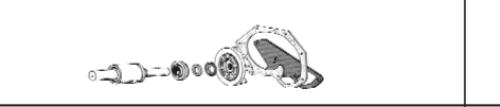
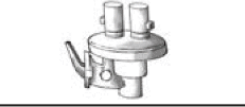

Thermostat
[TAR48675](#) 180° F (2)

Fuel Transfer Pump
[TRE42211](#)

Water Pump Repair Kit
 Without Impeller With Impeller
 See Chart

Transmission Oil Pump
[TAL120106](#)
 Verify P/N for your application

1) Seal
 2) Injector, Pencil
 1) [TR60746](#)
[TR48000](#)
 2) [TRE37503](#)

(1) Replace all R78558 Cap Screws with Flanged Head Cap Screw [TR85363](#).
 (2) Saran engines may use [TRE64354](#).
 (3) Some Engine Models may use Standard Capacity Pump, Oil [TRE55343](#).
 (4) Do not use 45° Valves with RE56545 Head.
 (5) To ESN 379968.
 (6) Threaded Type.