

300 Series
Engine & Equipment
Model
6.359D

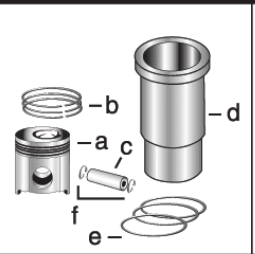

6 Cyl

Bore: 4.19 in
 106.5 mm

Pin Ø: 1.375 in
 35 mm

1) Engine O/H Kit

Piston-Liner Kit

Main Bearing

Thrust Bearing

Con Rod Bearing

2) Engine I/F Kit

TRE30250
 Consists of:

TRE27352 Std.

TAT21139 Std.

TRE27348 Std.

1) TRE50784

a) **TRE19282**

TRE27353 .010

TAT21132 .010

TRE27349 .010

2) TIK50784

b) **TRE66820**

TRE27360 .020

TAT21134 .020

TRE27358 .020

c) **TR125754**

TRE27368 .030

TAT21136 .030

TRE27364 .030

d) **TR116281**

Use 6

Use 1

Use 6

e) **TAR65507**

f) **TM41029**

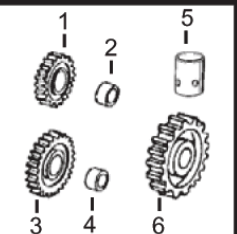
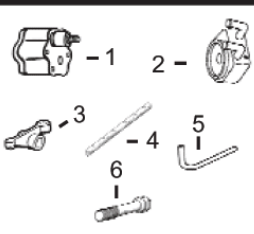
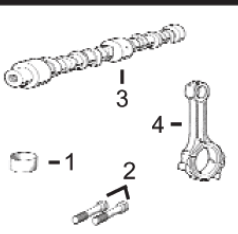
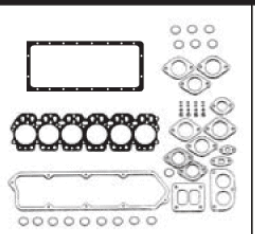
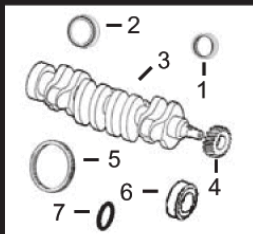

1) Front Seal
2) Rear Seal

1) O/H Gasket Set

1) Bush, Con Rod
2) Bolt, Con Rod

1) Pump, Oil
2) Oil Cooler
3) Rocker Arm
4) Rocker Shaft
5) Pump, Oil Tube
6) Cyl Hd Cap Screw

1) Lower Gear
2) Lower Bushing
3) Upper Gear
4) Upper Bushing
5) Cam. Follower
6) Cam. Gear

3) Crankshaft
4) Crankshaft, Gear
5) Ring Gear
6) Sleeve, Front
7) Packing, Sleeve

2) Head Gasket Set
3) Head Gasket
4) Oil Pan Gasket
5) Rocker Cover Gsk

3) Camshaft
4) Con Rod

1) TAR67942
2) TRE44574
3) TAT22562
4) TT20094
5) TR28811 (129T)
6) TR81989
7) TH35244

1) TRE55343 (2)
2) TRE31929
3) TRE31973
4) TR54986
5) TR113752
6) TR85363 x26 (4)

1) TR79623 Std. .003
TR79628 .015
TR79629 .015

1) TR79624 Std. .003
TR79625 .003
TR79626 .015

1) TR73064 Std.
2) TR51734 Std.

1) TT20129
2) TT20077

1) TR26125
2) TRE11410
3) TR87627

Valve, Intake

Valve, Exhaust

Insert, Valve
1) Intake
2) Exhaust

1) Cap, Valve
2) Lock, Valve

1) Spring, Valve
2) Rotator, Valve
3) O'ring, Valve

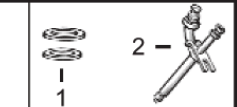
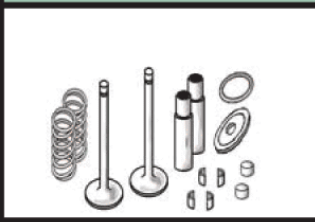

Thermostat

TAR48675 180° F (1)

Fuel Transfer Pump

TRE42211

Water Pump Repair Kit

Without Impeller With Impeller

See Chart

Transmission Oil Pump

TAL120106 **TAL68094**

1) Seal
2) Injector, Pencil

1) TR60746
TR48000
2) TAR89564

Verify P/N for your application

(1) Saran engines may use [TRE64354](#).
 (2) Some Engines Models may use High Capacity Pump, Oil [TRE65580](#).
 (3) Threaded Type.
 (4) Replace all R78558 Cap Screws with Flanged Head Cap Screw [TR85363](#).