

300 Series
Engine & Equipment
Model

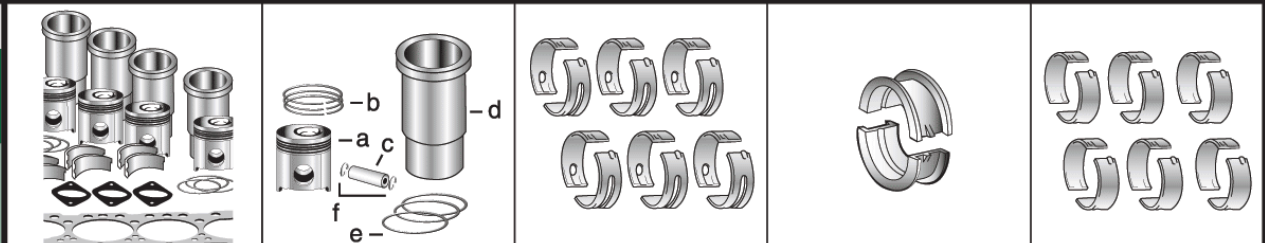

6059D

Liter Designated

6 Cyl

Bore: 4.19 in
 106.5 mm
 Pin Ø: 1.375 in
 35 mm

1) Engine O/H Kit **Piston-Liner Kit** **Main Bearing** **Thrust Bearing** **Con Rod Bearing**

2) Engine I/F Kit	TRE30250 Consists of:	TRE27352 Std.	TAT21139 Std.	TRE27348 Std.
1) TRE50784	a) TRE19282	TRE27353 .010	TAT21132 .010	TRE27349 .010
2) TIK50784	b) TRE66820	TRE27360 .020	TAT21134 .020	TRE27358 .020
	c) TR125754	TRE27368 .030	TAT21136 .030	TRE27364 .030
	d) TR116281			
	e) TAR65507			
	f) TM41029	Use 6	Use 1	Use 6

APPLICATIONS:

AGRICULTURAL

- 2955 3650
- 3155 9900
- 3155TSS 9910
- 3255 9920
- 3640

CONSTRUCTION

- 444D
- 570B

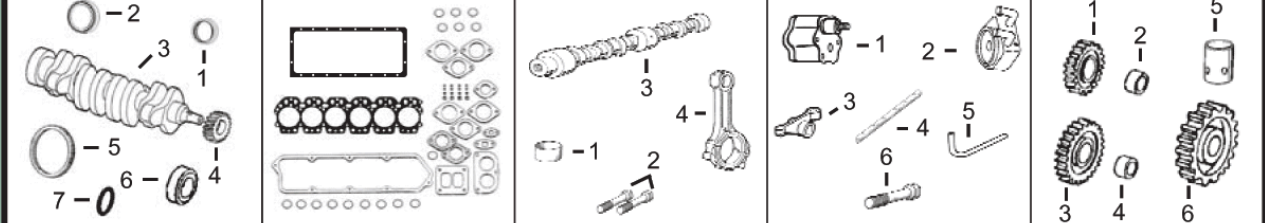

1) Front Seal 2) Rear Seal	1) O/H Gasket Set	1) Bush, Con Rod 2) Bolt, Con Rod	1) Pump, Oil 2) Oil Cooler 3) Rocker Arm 4) Rocker Shaft 5) Pump, Oil Tube 6) Cyl Hd Cap Screw	1) Lower Gear 2) Lower Bushing 3) Upper Gear 4) Upper Bushing 5) Cam. Follower 6) Cam. Gear
3) Crankshaft 4) Crankshaft, Gear 5) Ring Gear 6) Sleeve, Front 7) Packing, Sleeve	2) Head Gasket Set 3) Head Gasket 4) Oil Pan Gasket 5) Rocker Cover Gsk	3) Camshaft 4) Con Rod		

1) TAR67942 2) TRE44574 3) TAT22562 4) TT20094 5) TR28811 (129T) or TR114282 (142T) 6) TR81989 7) TH35244	1) TRE501580 2) TRE38852 3) TR114157 4) TR97344 5) TR75728	1) TR55647 x6 2) TR80033 x12 3) TR82821 (7) 4) TRE16495	1) TRE55343 (2) 2) TRE31929 3) TRE31973 (5) 4) TR54986 5) TR113752 6) TR85363 x26 (1)	1) TAT24252 (4) 2) TT26321 3) TAT18009 (4) 4) TT20034 5) TT20073 6) TT20070 (4)
-------------------------------------------------------------------------------------------------------------------------------------------------------------------------------------------	-----------------------------------------------------------------------------------------------------------	----------------------------------------------------------------------------------------------	------------------------------------------------------------------------------------------------------------------------------------------------	------------------------------------------------------------------------------------------------------------------------------------------



Valve, Intake	Valve, Exhaust	Insert, Valve 1) Intake 2) Exhaust	1) Seal, Valve 2) Lock, Valve	1) Spring, Valve 2) Rotator, Valve
---------------	----------------	------------------------------------------	----------------------------------	---------------------------------------

TR98062 Std. TR97490 .015	TR90692 Std. TR97492 .015	1) TR98063 Std. TR98335 O/S 2) TR85687 Std. TR93910 O/S	1) TRE31617 2) TR91889	1) TR26125 2) TRE60005
--------------------------------------------	--------------------------------------------	----------------------------------------------------------------------------------------------	-----------------------------------------	-----------------------------------------



1) Thermostat
2) Thermostat Cover

TAR48675 180° F (3)

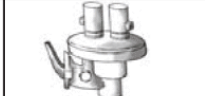

Fuel Transfer Pump

TRE42211
TRE38009 (6)



Water Pump Rep Kit
a) Without Impeller
b) With Impeller

See Chart

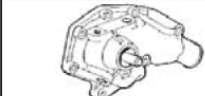

Water Pump

TAR97708
(m) R73604



Transmission Oil Pump

TAL120106 **TAL68094**

Verify P/N for your application

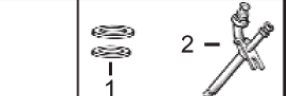

1) Seal
2) Injector, Pencil

1) **TR60746**
TR48000
2) **TRE36936**

(1) Replace all R78558 Cap Screws with Flanged Head Cap Screw **TR85363**.
 (2) Some of these engine models may use High Capacity Pump, Oil **TRE65580**.
 (3) Saran engines may use **TRE64354**.
 (4) Helicoidal Gears.
 (5) To ESN 379968.
 (6) Saran Engines.
 (7) Threaded Type.