

PowerTech

Engine & Equipment Model

4045T

4.5T

4 Cyl

Bore: 4.19 in
106.5 mm
Pin Ø: 1.375 in
35 mm

Piston (m):
RE59277, RE505100 (1)

Con Rod (m):
R123959, R500000

APPLICATIONS:

AGRICULTURAL

3410/X 5510/N 5715
4890 5520/N 5725
4895 5525/N 6700
5415 5615
5425/N 5625/N

OEM

4.5L

CONSTRUCTION

230 LCR 344H
310E (TURBO) 410E
310G (TURBO) 410G
310SE (TURBO) 410J
310SG (TURBO) 450H
315SE 550H
315SG 650H



1) Engine O/H Kit **Piston-Liner Kit** **Main Bearing** **Thrust Bearing** **Con Rod Bearing**

2) Engine I/F Kit **TRE507920 (RE515372)** **TRE65165 Std.** **TRE65168 Std.** **TRE65908 Std.**

1) TRE66093 **Consists of:** **TRE65911 .010** **TRE65912 .010** **TRE65909 .010**
TRE66093A (*) **a) TRE515372** **TRE65165B .020 (9)** **TRE65168B .020 (9)** **TRE65908B .020 (9)**
(*) w/C. Rod R500000 **b) TRE66820**

2) TIK66093 **c) TR123178** **Use 4** **Use 1** **Use 4**
TIK66093A (*) **d) TR116383**
(*) w/C. Rod R500000 **e) TAR65507**
f) TM41029

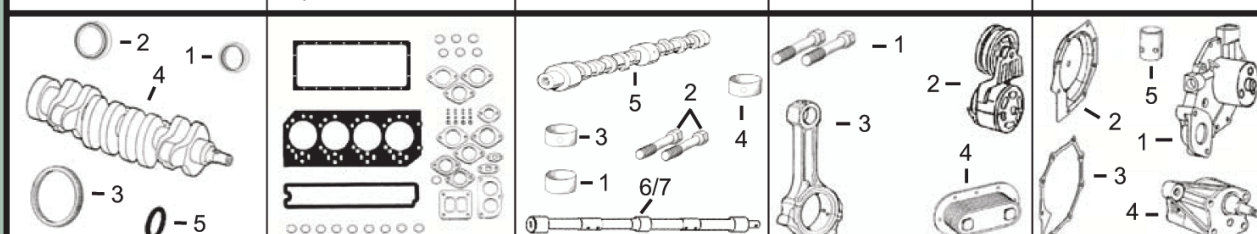

1) Front Seal **1) O/H Gasket Set** **1) Bush, Con Rod** **1) Cyl Hd Cap Screw** **1) Water Pump**
2) Rear Seal **2) Head Gasket Set** **2) Bolt, Con Rod** **2) Tensioner, Belt** **2) Water Pump Cov**
3) Ring Gear **3) Head Gasket** **3) Bush, Bal. Shaft** **3) Con Rod** **3) Water Pump Gsk**
4) Crankshaft **4) Oil Pan Gasket** **4) Bush, Camshaft** **4) Oil Cooler** **4) Pump, Oil**
5) Seal **5) Rocker Cover Gsk** **5) Camshaft** **5) Tappet**

1) TRE505515 (10) **1) TRE501455** **1) TR123960 x4** **1) TR85363 x18 (5)** **1) TRE500737**
2) TRE44574 **2) TRE66082** **2) TR114083 x8 (2)** **2) TRE518097 (11)** **(Standard Flow)**
3) TR28811 (129T) **3) TR116515** **TR501124 x8 (2)** **TRE68715 (11)** **TRE500734**
or **4) TR123352 (3)** **3) TR115299 x6** **3) TRE500002** **(High Flow)**
TR114282 (142T) **TR97342 (4)** **4) TR119874 x1** **4) TRE59296 (5 Plates)** **2) TRE508566**
4) TRE50618 (6) **(R123353)** **5) TRE56375 (7)** **TRE56690 (7 Plates)** **3) TR123417**
5) TH35244 **5) TR123542** **6) TRE500448** **TRE59298 (9 Plates)** **4) TRE504914**
7) TRE500449 **7) TRE500449** **7) TRE500449** **5) TR123565 x8**

Valve, Intake **Valve, Exhaust** **Insert, Valve** **1) Seal, Valve** **1) Spring, Valve**
1) Intake **1) Exhaust** **1) Intake** **2) Lock, Valve** **2) Rotator, Valve**
2) Exhaust **1) TR98063 Std.** **2) TR98335 O/S** **1) TRE31617** **1) TR26125**
1) TR97490 .015 **TR97492 .015** **2) TR85687 Std.** **2) TR91889** **2) TRE60005**
2) TR93910 O/S

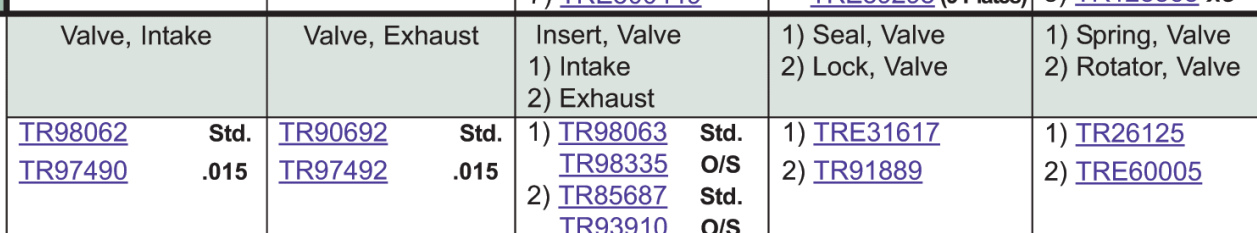

Thermostat **Injector, Pencil** **Seal, Injector** **Fuel Transfer Pump**

TRE522076 180° F (11) **TRE60062 (Non Turbo)** **TR92352** **TRE68345**
TRE528652 180° F (11) **TRE48786 (Turbo)** **TR48000** or
TRE540550 180° F (11) **TRE531436 (12)** **TRE66153 (8)**
TRE64354 180° F (11)

(1) These marking numbers RE59277, RE505100 require to use Ring Set **TRE66271**.
(2) Use **TR114083** with Machine Split Con Rods, and use **TR501124** with Fractured Split Con Rods.
(3) Use with Oil Pan code 1901, 1902 & 1903, for Steel Oil Pan.
(4) Use with Oil Pan code 1904 & 1905, for Aluminum Oil Pan.
(5) Replace all R78558 Cap Screws with Flanged Head Cap Screw **TR85363**.
(6) Crankshaft (m) R113596. Not to be used with applications requiring speed sensor gear.
(7) (m) R135439, R132324, R134213.
(8) Line Connections are both threaded.
(9) Proper bearing journal radius must be maintained during the machining of the crankshaft to ensure proper operation.
(10) 1 Piece Unitized Seal and Wearsleeve; Replaces **TRE59810**, RE538097.
(11) Check application for proper usage.
(12) Use with Stanadyne DE10 Injection Pump.