

**300 Series**  
**Engine & Equipment**  
**Model**  
**6.359T**

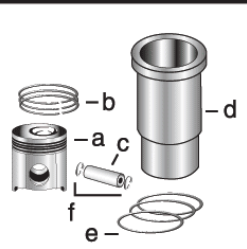

**6 Cyl**

Bore: 4.19 in  
 106.5 mm

Pin Ø: 1.62 in  
 41 mm

**1) Engine O/H Kit**

**Piston-Liner Kit**

**Main Bearing**

**Thrust Bearing**

**Con Rod Bearing**

**2) Engine I/F Kit**

**TRE33115**  
 Consists of:  
 a) [TRE19278](#)  
 b) [TRE66820](#)  
 c) [TR124230](#)  
 d) [TR116281](#)  
 e) [TAR65507](#)  
 f) [TR54114](#)

[TRE27352](#) Std.  
[TRE27353](#) .010  
[TRE27360](#) .020  
[TRE27368](#) .030  
**Use 6**

[TAT21139](#) Std.  
[TAT21132](#) .010  
[TAT21134](#) .020  
[TAT21136](#) .030  
**Use 1**

[TRE27348](#) Std.  
[TRE27349](#) .010  
[TRE27358](#) .020  
[TRE27364](#) .030  
**Use 6**

**1) [TRE50783](#)**

**2) [TIK50783](#)**

**APPLICATIONS:**

**AGRICULTURAL**

- 3140C 7445
- 3540 7484
- 3550 9400
- 4050 9930
- 7200

**CONSTRUCTION**

- 444D
- 544E/EH/G
- 570B
- 710B/C

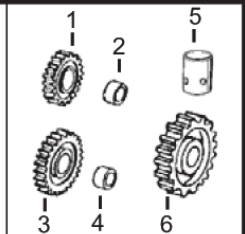
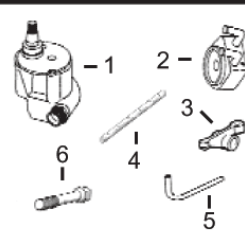
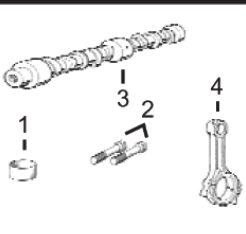
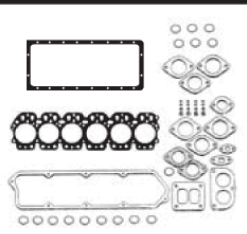
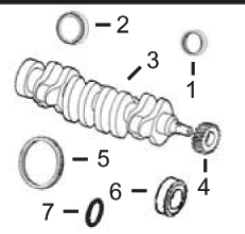

**1) Front Seal**  
**2) Rear Seal**

**1) O/H Gasket Set**

**1) Bush, Con Rod**  
**2) Bolt, Con Rod**

1) Pump, Oil  
 2) Oil Cooler  
 3) Rocker Arm  
 4) Rocker Shaft  
 5) Pump, Oil Tube  
 6) Cyl Hd Cap Screw

1) Lower Gear  
 2) Lower Bushing  
 3) Upper Gear  
 4) Upper Bushing  
 5) Cam. Follower  
 6) Cam. Gear

3) Crankshaft  
 4) Crankshaft, Gear  
 5) Ring Gear  
 6) Sleeve, Front  
 7) Packing, Sleeve

2) Head Gasket Set  
 3) Head Gasket  
 4) Oil Pan Gasket  
 5) Rocker Cover Gsk

3) Camshaft  
 4) Con Rod

1) [TAR67942](#)  
 2) [TRE44574](#)  
 3) [TAT22562](#)  
 4) [TT20094](#)  
 5) [TR28811](#) (129T)  
 or  
[TR114282](#) (142T)  
 6) [TR81989](#)  
 7) [TH35244](#)

1) [TRE501580](#)  
 2) [TRE38852](#)  
 3) [TR114157](#)  
 4) [TR97344](#)  
 5) [TR75728](#)

1) [TR57451](#) x6  
 2) [TR80033](#) x12  
 3) [TR82821](#) (6)  
 4) [TRE58347](#)

1) [TRE65580](#) (3)  
 2) [TRE31929](#)  
 3) [TRE31973](#) (5)  
 4) [TR54986](#)  
 5) [TR113752](#)  
 6) [TR85363](#) x26 (1)

1) [TAT24252](#)  
 2) [TT26321](#)  
 3) [TAT18009](#)  
 4) [TT20034](#)  
 5) [TT20073](#)  
 6) [TT20070](#)

Valve, Intake

Valve, Exhaust (4)

Insert, Valve  
 1) Intake  
 2) Exhaust

1) Cap, Valve  
 2) Lock, Valve

1) Spring, Valve  
 2) Rotator, Valve  
 3) O'ring, Valve

[TR83071](#) Std.  
[TR89223](#) .003  
[TR89224](#) .015

[TR79624](#) Std.  
[TR79625](#) .003  
[TR79626](#) .015

1) [TR73064](#) Std.  
 2) [TR51734](#) Std.

1) [TT20129](#)  
 2) [TT20077](#)

1) [TR26125](#)  
 2) [TRE11410](#)  
 3) [TR87627](#)

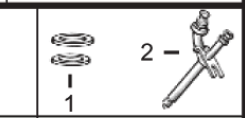
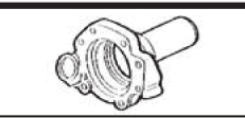
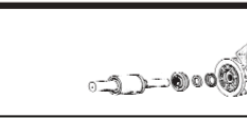
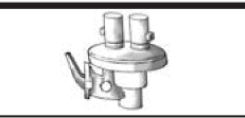

**Thermostat**

**Fuel Transfer Pump**

**Water Pump Repair Kit**

**Transmission Oil Pump**

[TAR48675](#) 180° F (2)  
[TRE42211](#)

Without Impeller      With Impeller  
 See Chart

[TAL120106](#)

Verify P/N for your application

1) Seal  
 2) Injector, Pencil  
 1) [TR60746](#)  
[TR48000](#)  
 2) [TRE37503](#)

(1) Replace all R78558 Cap Screws with Flanged Head Cap Screw [TR85363](#).  
 (2) Saran engines may use [TRE64354](#).  
 (3) Some Engine Models may use Standard Capacity Pump, Oil [TRE55343](#).  
 (4) Do not use 45° Valves with RE56545 Head.  
 (5) To ESN 379968.  
 (6) Threaded Type.