

**300 Series**  
**Engine & Equipment**  
**Model**

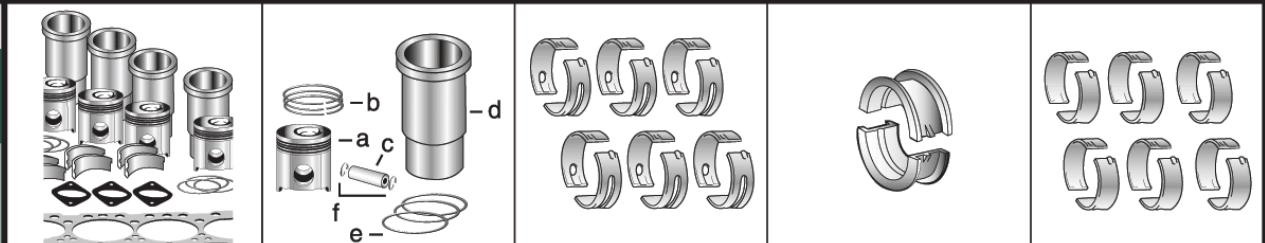

**6059D**

Liter Designated

6 Cyl

Bore: 4.19 in  
 106.5 mm  
 Pin Ø: 1.375 in  
 35 mm

<b>1) Engine O/H Kit</b>	<b>Piston-Liner Kit</b>	<b>Main Bearing</b>	<b>Thrust Bearing</b>	<b>Con Rod Bearing</b>
<b>2) Engine I/F Kit</b>	<b>TRE30250</b> Consists of:	<b>TRE27352</b> Std.	<b>TAT21139</b> Std.	<b>TRE27348</b> Std.
<b>1) TRE50784</b>	a) <b>TRE19282</b>	<b>TRE27353</b> .010	<b>TAT21132</b> .010	<b>TRE27349</b> .010
<b>2) TIK50784</b>	b) <b>TRE66820</b>	<b>TRE27360</b> .020	<b>TAT21134</b> .020	<b>TRE27358</b> .020
	c) <b>TR125754</b>	<b>TRE27368</b> .030	<b>TAT21136</b> .030	<b>TRE27364</b> .030
	d) <b>TR116281</b>			
	e) <b>TAR65507</b>			
	f) <b>TM41029</b>	<b>Use 6</b>	<b>Use 1</b>	<b>Use 6</b>

**APPLICATIONS:**

**AGRICULTURAL**

- 2955      3650
- 3155      9900
- 3155TSS    9910
- 3255      9920
- 3640

**CONSTRUCTION**

- 444D
- 570B

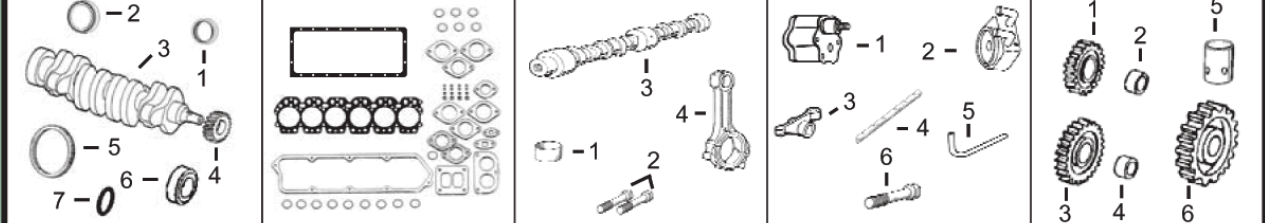

<b>1) Front Seal</b> <b>2) Rear Seal</b>	<b>1) O/H Gasket Set</b>	<b>1) Bush, Con Rod</b> <b>2) Bolt, Con Rod</b>	<b>1) Pump, Oil</b> <b>2) Oil Cooler</b> <b>3) Rocker Arm</b> <b>4) Rocker Shaft</b> <b>5) Pump, Oil Tube</b> <b>6) Cyl Hd Cap Screw</b>	<b>1) Lower Gear</b> <b>2) Lower Bushing</b> <b>3) Upper Gear</b> <b>4) Upper Bushing</b> <b>5) Cam. Follower</b> <b>6) Cam. Gear</b>
<b>3) Crankshaft</b> <b>4) Crankshaft, Gear</b> <b>5) Ring Gear</b> <b>6) Sleeve, Front</b> <b>7) Packing, Sleeve</b>	<b>2) Head Gasket Set</b> <b>3) Head Gasket</b> <b>4) Oil Pan Gasket</b> <b>5) Rocker Cover Gsk</b>	<b>3) Camshaft</b> <b>4) Con Rod</b>	<b>1) TRE55343 (2)</b> <b>2) TRE31929</b> <b>3) TRE31973 (5)</b> <b>4) TR54986</b> <b>5) TR113752</b> <b>6) TR85363 x26 (1)</b>	<b>1) TAT24252 (4)</b> <b>2) TT26321</b> <b>3) TAT18009 (4)</b> <b>4) TT20034</b> <b>5) TT20073</b> <b>6) TT20070 (4)</b>
<b>1) TAR67942</b> <b>2) TRE44574</b> <b>3) TAT22562</b> <b>4) TT20094</b> <b>5) TR28811 (129T)</b> or <b>TR114282 (142T)</b> <b>6) TR81989</b> <b>7) TH35244</b>	<b>1) TRE501580</b> <b>2) TRE38852</b> <b>3) TR114157</b> <b>4) TR97344</b> <b>5) TR75728</b>	<b>1) TR55647 x6</b> <b>2) TR80033 x12</b> <b>3) TR82821 (7)</b> <b>4) TRE16495</b>		

	Valve, Intake	Valve, Exhaust	Insert, Valve 1) Intake 2) Exhaust	1) Seal, Valve 2) Lock, Valve	1) Spring, Valve 2) Rotator, Valve
<b>TR98062</b> Std. <b>TR97490</b> .015		<b>TR90692</b> Std. <b>TR97492</b> .015	1) <b>TR98063</b> Std. <b>TR98335</b> O/S 2) <b>TR85687</b> Std. <b>TR93910</b> O/S	1) <b>TRE31617</b> 2) <b>TR91889</b>	1) <b>TR26125</b> 2) <b>TRE60005</b>

1) Thermostat 2) Thermostat Cover	Fuel Transfer Pump	Water Pump Rep Kit a) Without Impeller b) With Impeller	Water Pump	Transmission Oil Pump	1) Seal 2) Injector, Pencil
<b>TAR48675</b> 180° F (3)	<b>TRE42211</b> <b>TRE38009 (6)</b>	<b>See Chart</b>	<b>TAR97708</b> (m) R73604	<b>TAL120106</b>   <b>TAL68094</b>	1) <b>TR60746</b> <b>TR48000</b> 2) <b>TRE36936</b>
				Verify P/N for your application	

(1) Replace all R78558 Cap Screws with Flanged Head Cap Screw [TR85363](#).  
 (2) Some of these engine models may use High Capacity Pump, Oil [TRE65580](#).  
 (3) Saran engines may use [TRE64354](#).  
 (4) Helicoidal Gears.  
 (5) To ESN 379968.  
 (6) Saran Engines.  
 (7) Threaded Type.