

300 Series

Engine & Equipment
Model

6059D

Liter Designated

6 Cyl

Bore: 4.19 in
106.5 mm
Pin Ø: 1.375 in
35 mm

APPLICATIONS:

AGRICULTURAL

2955 3650
3155 9900
3155TSS 9910
3255 9920
3640

CONSTRUCTION

444D
570B

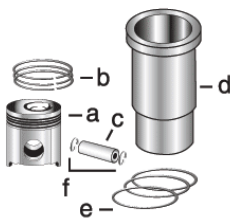

1) Engine O/H Kit

Piston-Liner Kit

Main Bearing

Thrust Bearing

Con Rod Bearing

2) Engine I/F Kit

[TRE30250](#)

Consists of:

[TRE27352](#) Std.

[TAT21139](#) Std.

[TRE27348](#) Std.

1) [TRE50784](#)

a) [TRE19282](#)

[TRE27353](#) .010

[TAT21132](#) .010

[TRE27349](#) .010

2) [TIK50784](#)

b) [TRE66820](#)

[TRE27360](#) .020

[TAT21134](#) .020

[TRE27358](#) .020

c) [TR125754](#)

[TRE27368](#) .030

[TAT21136](#) .030

[TRE27364](#) .030

d) [TR116281](#)

e) [TAR65507](#)

f) [TM41029](#)

Use 6

Use 1

Use 6

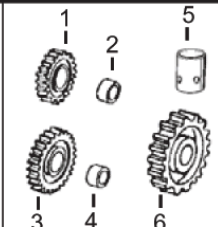
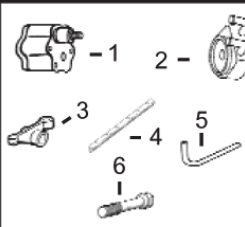
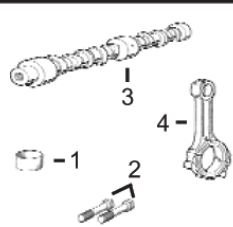
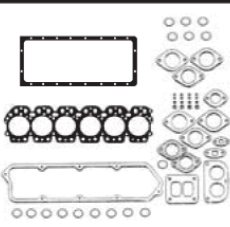
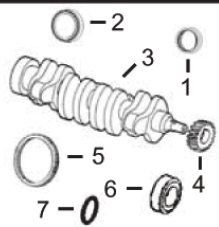

1) Front Seal

2) Rear Seal

1) O/H Gasket Set

1) Bush, Con Rod

2) Bolt, Con Rod

1) Pump, Oil

2) Oil Cooler

3) Rocker Arm

4) Rocker Shaft

5) Pump, Oil Tube

6) Cyl Hd Cap Screw

1) Lower Gear

2) Lower Bushing

3) Upper Gear

4) Upper Bushing

5) Cam. Follower

6) Cam. Gear

3) Crankshaft
4) Crankshaft, Gear
5) Ring Gear
6) Sleeve, Front
7) Packing, Sleeve

2) Head Gasket Set
3) Head Gasket
4) Oil Pan Gasket
5) Rocker Cover Gsk

3) Camshaft
4) Con Rod

1) [TRE55343](#) (2)

2) [TRE31929](#)

3) [TRE31973](#) (5)

4) [TR54986](#)

5) [TR113752](#)

6) [TR85363](#) x26 (1)

1) [TAT24252](#) (4)

2) [TT26321](#)

3) [TAT18009](#) (4)

4) [TT20034](#)

5) [TT20073](#)

6) [TT20070](#) (4)

1) [TAR67942](#)
2) [TRE44574](#)
3) [TAT22562](#)
4) [TT20094](#)
5) [TR28811](#) (129T)
or
[TR114282](#) (142T)
6) [TR81989](#)
7) [TH35244](#)

1) [TRE501580](#)
2) [TRE38852](#)
3) [TR114157](#)
4) [TR97344](#)
5) [TR75728](#)

1) [TR55647](#) x6
2) [TR80033](#) x12
3) [TR82821](#) (7)
4) [TRE16495](#)

Valve, Intake

Valve, Exhaust

Insert, Valve

1) Intake

2) Exhaust

1) Seal, Valve

2) Lock, Valve

1) Spring, Valve

2) Rotator, Valve

[TR98062](#) Std.
[TR97490](#) .015

[TR90692](#) Std.
[TR97492](#) .015

1) [TR98063](#) Std.
[TR98335](#) O/S
2) [TR85687](#) Std.
[TR93910](#) O/S

1) [TRE31617](#)
2) [TR91889](#)

1) [TR26125](#)
2) [TRE60005](#)

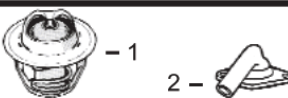

1) Thermostat
2) Thermostat Cover

[TAR48675](#) 180° F (3)



Fuel Transfer Pump

[TRE42211](#)
[TRE38009](#) (6)



Water Pump Rep Kit
a) Without Impeller
b) With Impeller

See Chart



Water Pump

[TAR97708](#)
(m) R73604



Transmission Oil Pump

[TAL120106](#) [TAL68094](#)

Verify P/N for your application



1) Seal
2) Injector, Pencil

1) [TR60746](#)
[TR48000](#)
2) [TRE36936](#)

(1) Replace all R78558 Cap Screws with Flanged Head Cap Screw [TR85363](#).
(2) Some of these engine models may use High Capacity Pump, Oil [TRE65580](#).
(3) Saran engines may use [TRE64354](#).
(4) Helicoidal Gears.

(5) To ESN 379968.
(6) Saran Engines.
(7) Threaded Type.