

300 Series
Engine & Equipment
Model

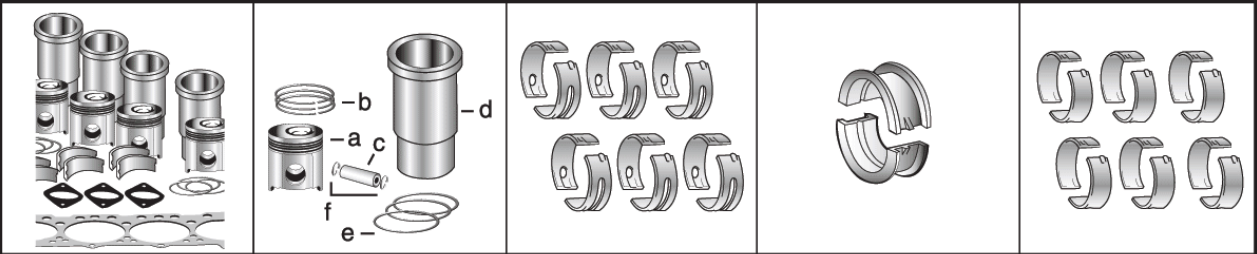

1) Engine O/H Kit	Piston-Liner Kit	Main Bearing	Thrust Bearing	Con Rod Bearing
2) Engine I/F Kit	TAR71593 Consists of: a) TAR78310 b) TAR55759 c) TT26149 d) TR116463 e) TAR71618 f) TR51112	TRE27352 Std. TRE27353 .010 TRE27360 .020 TRE27368 .030	TAT21139 Std. TAT21132 .010 TAT21134 .020 TAT21136 .030	TRE27348 Std. TRE27349 .010 TRE27358 .020 TRE27364 .030
1) TOK6593				
2) TIK6593				
		Use 6	Use 1	Use 6

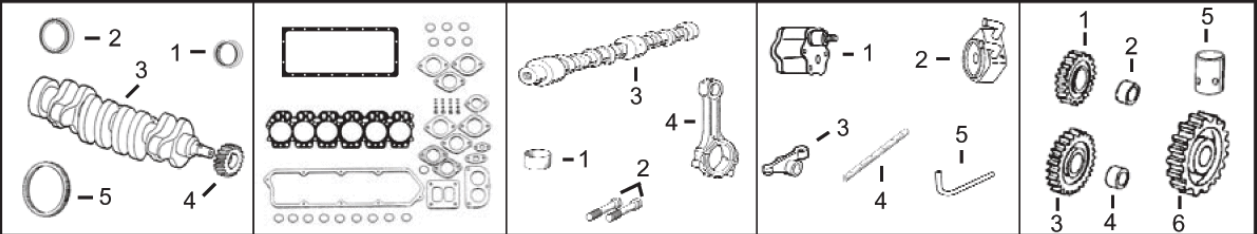

1) Front Seal 2) Rear Seal	1) O/H Gasket Set	1) Bush, Con Rod 2) Bolt, Con Rod	1) Pump, Oil 2) Oil Cooler 3) Rocker Arm 4) Rocker Shaft 5) Pump, Oil Tube	1) Lower Gear 2) Lower Bushing 3) Upper Gear 4) Upper Bushing 5) Cam. Follower 6) Cam. Gear
3) Crankshaft 4) Crankshaft, Gear 5) Ring Gear	2) Head Gasket Set 3) Head Gasket 4) Oil Pan Gasket 5) Rocker Cover Gsk	3) Camshaft 4) Con Rod		
1) TAR67942 2) TRE44574 3) TAT22562 4) TT20094 5) TR114282 (142T)	1) TRE501580 2) TRE38852 3) TR114157 4) TR97344 (1) 5) TR75728	1) TT23471 x6 2) TR74194 x12 (2) 3) TR82821 (3) 4) TAT18005	1) TRE55343 2) TRE31929 3) TRE31973 4) TR54986 5) TR113752	1) TAT24252 2) TT26321 3) TAT18009 4) TT20034 5) TT20073 6) TT20070

Valve, Intake	Valve, Exhaust	Insert, Valve 1) Intake 2) Exhaust	1) Cap, Valve 2) Lock, Valve	1) Spring, Valve 2) Rotator, Valve 3) O'ring, Valve
TR79623 Std. TR79628 .003 TR79629 .015	TR79624 Std. TR79625 .003 TR79626 .015	1) TR73064 Std. 2) TR51734 Std.	1) TT20129 2) TT20077	1) TR26125 2) TRE11410 3) TR87627

Thermostats	Fuel Transfer Pump	Water Pump Repair Kit		Injector, Pencil	Seal
TAR70601 180 °F (*) TAR77411 195 °F (*)	TRE42211	Without Impeller TMX9398	With Impeller TMX131	TAR89564	TR60746 TR48000

(*) Verify JD parts manual.
 (1) For Tractor Model 4030 order [TR97345](#).
 (2) Use [TR74194](#) with C.Rod (m) T20007; use [TR80033](#) with C.Rod (m) R81410.
 (3) Threaded Type.