

**300 Series**  
**Engine & Equipment**  
**Model**  
**6.359T**

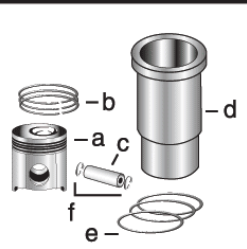

**6 Cyl**

Bore: 4.19 in  
 106.5 mm

Pin Ø: 1.62 in  
 41 mm

**APPLICATIONS:**

**AGRICULTURAL**

- 3140C 7445
- 3540 7484
- 3550 9400
- 4050 9930
- 7200

**CONSTRUCTION**

- 444D
- 544E/EH/G
- 570B
- 710B/C

**1) Engine O/H Kit**

**Piston-Liner Kit**

**Main Bearing**

**Thrust Bearing**

**Con Rod Bearing**

**2) Engine I/F Kit**

**TRE33115**  
 Consists of:  
 a) [TRE19278](#)  
 b) [TRE66820](#)  
 c) [TR124230](#)  
 d) [TR116281](#)  
 e) [TAR65507](#)  
 f) [TR54114](#)

[TRE27352](#) Std.  
[TRE27353](#) .010  
[TRE27360](#) .020  
[TRE27368](#) .030  
**Use 6**

[TAT21139](#) Std.  
[TAT21132](#) .010  
[TAT21134](#) .020  
[TAT21136](#) .030  
**Use 1**

[TRE27348](#) Std.  
[TRE27349](#) .010  
[TRE27358](#) .020  
[TRE27364](#) .030  
**Use 6**

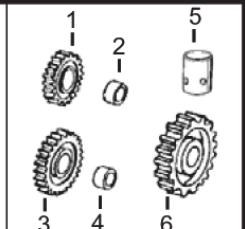
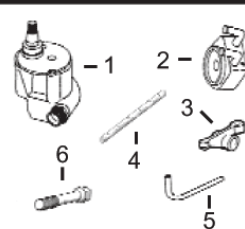
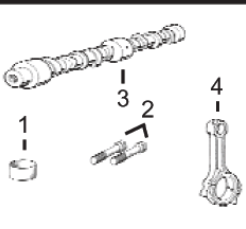
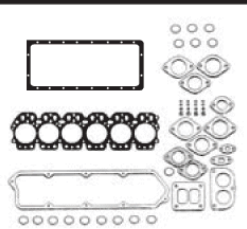
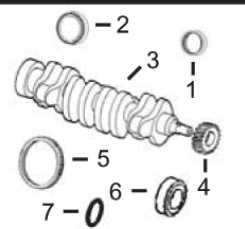

**1) Front Seal**  
**2) Rear Seal**

**1) O/H Gasket Set**

**1) Bush, Con Rod**  
**2) Bolt, Con Rod**

1) Pump, Oil  
 2) Oil Cooler  
 3) Rocker Arm  
 4) Rocker Shaft  
 5) Pump, Oil Tube  
 6) Cyl Hd Cap Screw

1) Lower Gear  
 2) Lower Bushing  
 3) Upper Gear  
 4) Upper Bushing  
 5) Cam. Follower  
 6) Cam. Gear

3) Crankshaft  
 4) Crankshaft, Gear  
 5) Ring Gear  
 6) Sleeve, Front  
 7) Packing, Sleeve

2) Head Gasket Set  
 3) Head Gasket  
 4) Oil Pan Gasket  
 5) Rocker Cover Gsk

3) Camshaft  
 4) Con Rod

1) [TAR67942](#)  
 2) [TRE44574](#)  
 3) [TAT22562](#)  
 4) [TT20094](#)  
 5) [TR28811](#) (129T)  
 or  
[TR114282](#) (142T)  
 6) [TR81989](#)  
 7) [TH35244](#)

1) [TRE501580](#)  
 2) [TRE38852](#)  
 3) [TR114157](#)  
 4) [TR97344](#)  
 5) [TR75728](#)

1) [TR57451](#) x6  
 2) [TR80033](#) x12  
 3) [TR82821](#) (6)  
 4) [TRE58347](#)

1) [TRE65580](#) (3)  
 2) [TRE31929](#)  
 3) [TRE31973](#) (5)  
 4) [TR54986](#)  
 5) [TR113752](#)  
 6) [TR85363](#) x26 (1)

1) [TAT24252](#)  
 2) [TT26321](#)  
 3) [TAT18009](#)  
 4) [TT20034](#)  
 5) [TT20073](#)  
 6) [TT20070](#)

Valve, Intake

[TR83071](#) Std.  
[TR89223](#) .003  
[TR89224](#) .015

Valve, Exhaust (4)

[TR79624](#) Std.  
[TR79625](#) .003  
[TR79626](#) .015

Insert, Valve  
 1) Intake  
 2) Exhaust

1) [TR73064](#) Std.  
 2) [TR51734](#) Std.

1) Cap, Valve  
 2) Lock, Valve

1) [TT20129](#)  
 2) [TT20077](#)

1) Spring, Valve  
 2) Rotator, Valve  
 3) O'ring, Valve

1) [TR26125](#)  
 2) [TRE11410](#)  
 3) [TR87627](#)

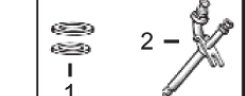
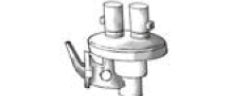

**Thermostat**

[TAR48675](#) 180° F (2)

**Fuel Transfer Pump**

[TRE42211](#)

**Water Pump Repair Kit**

Without Impeller      With Impeller

[See Chart](#)

**Transmission Oil Pump**

[TAL120106](#)

Verify P/N for your application

1) Seal  
 2) Injector, Pencil

1) [TR60746](#)  
[TR48000](#)  
 2) [TRE37503](#)

(1) Replace all R78558 Cap Screws with Flanged Head Cap Screw [TR85363](#).  
 (2) Saran engines may use [TRE64354](#).  
 (3) Some Engine Models may use Standard Capacity Pump, Oil [TRE55343](#).  
 (4) Do not use 45° Valves with RE56545 Head.

(5) To ESN 379968.  
 (6) Threaded Type.