

400 Series
Engine & Equipment
Model

6.466D

6 Cyl

Bore: 4.56 in
 116 mm
 Pin Ø: 1.61 in
 41 mm

Con Rod (m):
 R66922, R58882, R41423

APPLICATIONS:

AGRICULTURAL

4050
 4240
 6620

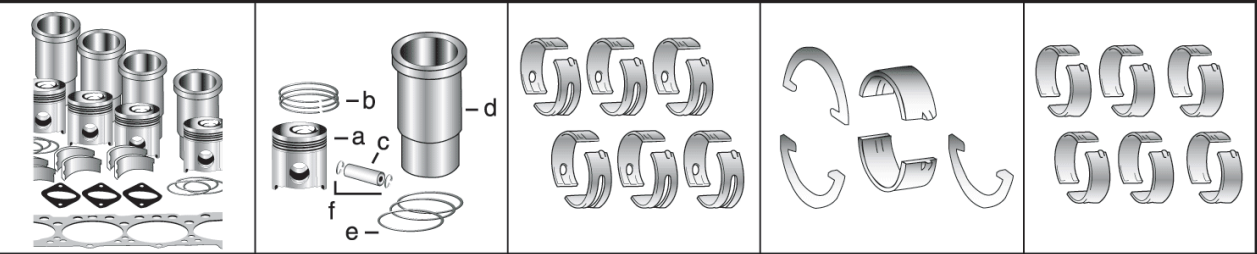

1) Engine O/H Kit **Piston-Liner Kit** **Main Bearing** **Thrust Bearing** **Con Rod Bearing**

2) Engine I/F Kit	TAR83610 Consists of:	TAR74814 Std. TAR74816 .010 TAR74817 .020 TAR74818 .030	TAR77748 Std. TAR77750 .010 TAR77751 .020 TAR77752 .030	TAR45723 Std. TAR46396 .010 TAR46397 .020 TAR46398 .030
1) TRG18846	a) TAR100442 b) TAR87753 c) TR41425 d) TAR63060 e) TAR98850 f) TR54114	Use 6	Use 1 Thrust Washer TAR77747 Std. TAR77753 .007 Use 3, Order Qty 1	Use 6
2) TIK18846				

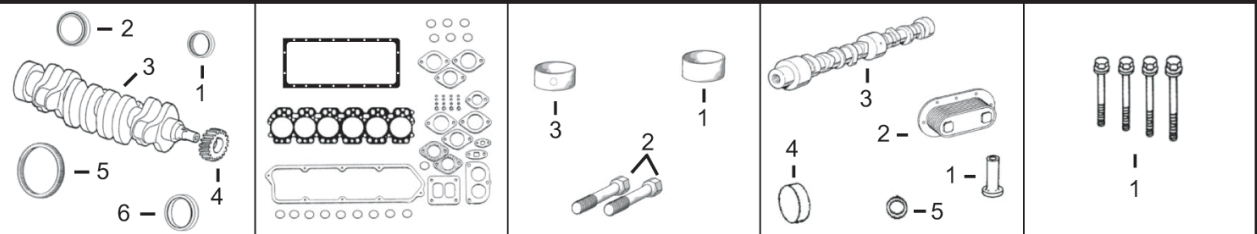

1) Front Seal **1) O/H Gasket Set** **1) Bush, Con Rod**
2) Rear Seal **2) Head Gasket Set** **2) Bolt, Con Rod**
3) Crankshaft **3) Head Gasket** **3) Bushing, Cam**
4) Crankshaft, Gear **4) Oil Pan Gasket**
5) Ring Gear **4) Oil Pan Gasket**
6) Rear Gear

1) TAR49025 2) TRE520036 3) TRE53422 (4) 4) TR26049 (23T) 5) TR28811 (129T) 6) TR63326	1) TAR100638 2) TAR100632 3) TRE47336 4) TR71918	1) TR42173 x6 2) TR66452 x12 3) TR46903 x4 (1)	1) TR52773 2) TAR55394 3) TAR100386 4) TR26115 5) TR47153	1) TMX365 (2)* TMX366 (3)**
---	---	---	--	--

Valve, Intake Valve, Exhaust Insert, Valve
 1) Intake
 2) Exhaust 1) Cap, Valve
 2) Lock, Valve 1) Spring, Valve
 2) Rotator, Valve
 3) O'ring, Valve

TR43883 Std. TR45003 .003 TR45004 .015	TR43679 Std. TR43787 .003 TR43788 .015	1) TR43680 Std. 2) TR43681 Std.	1) TT20129 2) TT20077	1) TR26125 2) TRE11410 3) TR87627
---	---	--	--	--



Thermostat **Fuel Transfer Pump** **Water Pump Rep Kit**
 a) Without Impeller
 b) With Impeller **Water Pump** **Pump, Oil, Quad Transmission**

TR48675 180° F	TRE38009	See Chart	TRE55985 (m) R71224, (m) R83561	TRE20918 For Tractors 4240,4050
-----------------------	-----------------	------------------	--	--

(1) Shape, Conrod Bushing.
 (2) **TMX365** Consists of: **TR88042** x6, **TR88043** x5, **TR88044** x8, **TR88045** x7. * With ESN > 318403.
 (3) **TMX366** Consists of: **TR88043** x11, **TR88044** x8, **TR88045** x7. ** With ESN 318404 >.
 (4) **TRE53422** will require front key **TR116311** for the front damper.