

400 Series

Engine & Equipment
Model

6.404D

335,846 >

6 Cyl

Bore: 4.25 in
108 mm
Pin Ø: 1.50 in
38 mm

Block (m):

R49470, R49650, R59850,
R72128, R87558

APPLICATIONS:

AGRICULTURAL

4040
4230
6600
7700

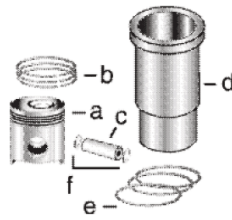

1) Engine O/H Kit

Piston-Liner Kit

Main Bearing

Thrust Bearing

Con Rod Bearing

2) Engine I/F Kit

TRE23160

Consists of:

- a) [TRE23163](#)
- b) [TAR65502](#)
- c) [TR44161](#)
- d) [TR40615](#)
- e) [TAR65507](#)
- f) [TH80753](#)

- [TAR74814](#) Std.
- [TAR74816](#) .010
- [TAR74817](#) .020
- [TAR74818](#) .030

Use 6

- [TAR77748](#) Std.
- [TAR77750](#) .010
- [TAR77751](#) .020
- [TAR77752](#) .030

Use 1

Thrust Washer

- [TAR77747](#) Std.
- [TAR77753](#) .007

Use 3, Order Qty 1

- [TAR45723](#) Std.
- [TAR46396](#) .010
- [TAR46397](#) .020
- [TAR46398](#) .030

Use 6

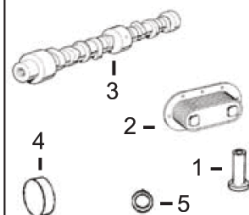
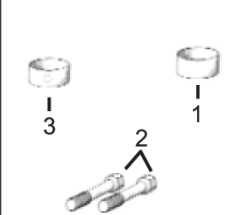
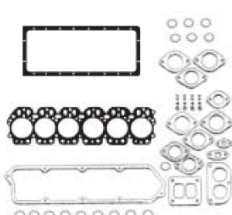
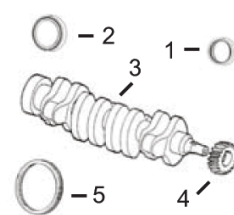

1) Front Seal
2) Rear Seal

1) O/H Gasket Set

1) Bush, Con Rod
2) Bolt, Con Rod
3) Bushing, Cam

1) Cam Follower
2) Oil Cooler
3) Camshaft Kit
4) Plug, Camshaft
5) O'ring, Oil Cooler

1) Head Bolt Kit

3) Crankshaft
4) Crankshaft, Gear
5) Ring Gear

2) Head Gasket Set
3) Head Gasket
4) Oil Pan Gasket

- 1) [TAR49025](#)
- 2) [TRE520036](#)
- 3) [TRE53422](#) (5)
- 4) [TR26049](#) (23T)
- 5) [TR28811](#) (129T)

- 1) [TAR63938](#)
- 2) [TAR63940](#)
- 3) [TR48291](#)
- 4) [TR71918](#)

- 1) [TR30939](#) x6
- 2) [TR66452](#) x12
- 3) [TR46903](#) x4

- 1) [TR52773](#)
- 2) [TAR55394](#)
- 3) [TAR100386](#)
- 4) [TR26115](#)
- 5) [TR47153](#)

1) [TMX365](#) (1)



Valve, Intake

Valve, Exhaust

Insert, Valve
1) Intake
2) Exhaust

1) Cap, Valve
2) Lock, Valve

1) Spring, Valve
2) Rotator, Valve
3) O'ring, Valve

- [TR43883](#) Std.
- [TR45003](#) .003
- [TR45004](#) .015

- [TR43679](#) Std.
- [TR43787](#) .003
- [TR43788](#) .015

- 1) [TR43680](#) Std.
- 2) [TR43681](#) Std.

- 1) [TT20129](#)
- 2) [TT20077](#)

- 1) [TR26125](#)
- 2) [TRE11410](#)
- 3) [TR87627](#)



Thermostat



Fuel Transfer Pump



Water Pump Repair Kit



1) Injector, Pencil
2) Seal, Injector



Pump, Oil, Quad
Transmission

[TR36846](#) 180° F

- [TAR53567](#) (2)
- [TRE42211](#) (3)
- [TAR49771](#) (4)

Without Impeller With Impeller

See Chart

- 1) [TAR50781](#)
- 2) [TR60746](#)
- [TR48000](#)

[TRE20918](#)
For Tractors
4230,4040

(1) [TMX365](#) Consists of: [TR88042](#) x6, [TR88043](#) x5, [TR88044](#) x8, [TR88045](#) x7.

(2) ES > 82,801.

(3) ES 82,802-422,365.

(4) ES 422,366 >.

(5) [TRE53422](#) will require front key [TR116311](#) for the front damper.