

**400 Series**  
**Engine & Equipment**  
**Model**

**6.466D**

6 Cyl

Bore: 4.56 in  
 116 mm  
 Pin Ø: 1.61 in  
 41 mm

**Con Rod (m):**  
 R66922, R58882, R41423

**APPLICATIONS:**

**AGRICULTURAL**

4050  
 4240  
 6620

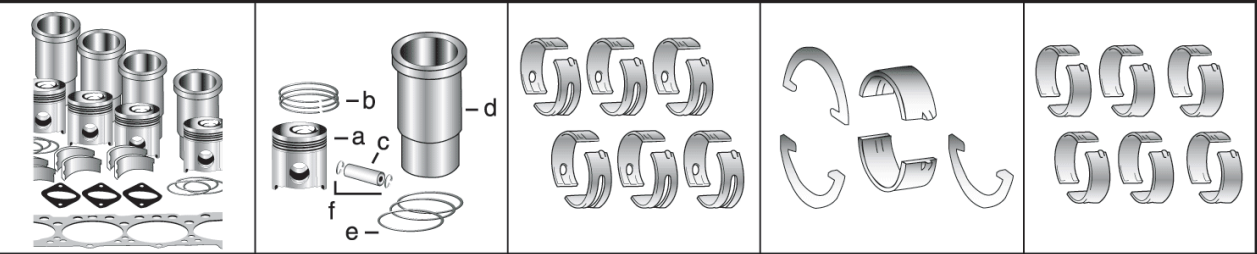

**1) Engine O/H Kit**      **Piston-Liner Kit**      **Main Bearing**      **Thrust Bearing**      **Con Rod Bearing**

<b>2) Engine I/F Kit</b>	<b>TAR83610</b> Consists of:	<b>TAR74814</b> Std. <b>TAR74816</b> .010 <b>TAR74817</b> .020 <b>TAR74818</b> .030	<b>TAR77748</b> Std. <b>TAR77750</b> .010 <b>TAR77751</b> .020 <b>TAR77752</b> .030	<b>TAR45723</b> Std. <b>TAR46396</b> .010 <b>TAR46397</b> .020 <b>TAR46398</b> .030
<b>1) TRG18846</b>	a) <b>TAR100442</b> b) <b>TAR87753</b> c) <b>TR41425</b> d) <b>TAR63060</b> e) <b>TAR98850</b> f) <b>TR54114</b>	<b>Use 6</b>	<b>Use 1</b> <b>Thrust Washer</b> <b>TAR77747</b> Std. <b>TAR77753</b> .007 <b>Use 3, Order Qty 1</b>	<b>Use 6</b>
<b>2) TIK18846</b>				

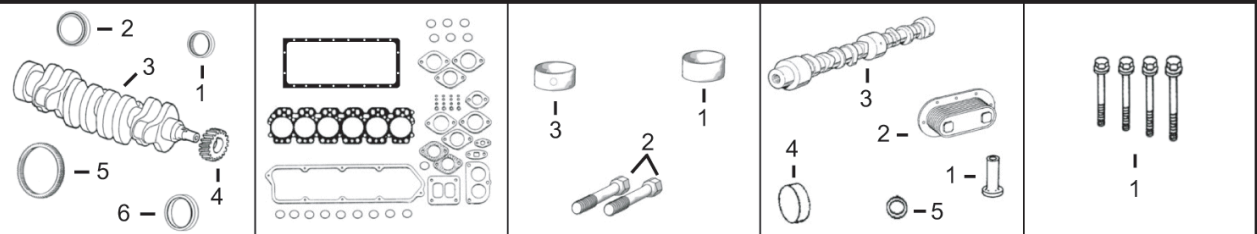

**1) Front Seal**      **1) O/H Gasket Set**      **1) Bush, Con Rod**      **1) Cam Follower**      **1) Head Bolt Kit**  
**2) Rear Seal**      **2) Head Gasket Set**      **2) Bolt, Con Rod**      **2) Oil Cooler**      **2) Oil Cooler**  
**3) Crankshaft**      **3) Head Gasket**      **3) Bushing, Cam**      **3) Camshaft Kit**      **3) Camshaft Kit**  
**4) Crankshaft, Gear**      **4) Oil Pan Gasket**      **4) Plug, Camshaft**      **4) Plug, Camshaft**      **4) Plug, Camshaft**  
**5) Ring Gear**      **5) O'ring, Oil Cooler**      **5) O'ring, Oil Cooler**      **5) O'ring, Oil Cooler**      **5) O'ring, Oil Cooler**  
**6) Rear Gear**

1) <b>TAR49025</b> 2) <b>TRE520036</b> 3) <b>TRE53422</b> (4) 4) <b>TR26049</b> (23T) 5) <b>TR28811</b> (129T) 6) <b>TR63326</b>	1) <b>TAR100638</b> 2) <b>TAR100632</b> 3) <b>TRE47336</b> 4) <b>TR71918</b>	1) <b>TR42173</b> x6 2) <b>TR66452</b> x12 3) <b>TR46903</b> x4  <b>(1)</b>	1) <b>TR52773</b> 2) <b>TAR55394</b> 3) <b>TAR100386</b> 4) <b>TR26115</b> 5) <b>TR47153</b>	1) <b>TMX365</b> (2)* <b>TMX366</b> (3)**
---	---	---	--	--

**Valve, Intake**      **Valve, Exhaust**      **Insert, Valve**      **1) Cap, Valve**      **1) Spring, Valve**  
**1) Intake**      **1) Intake**      **1) Intake**      **2) Lock, Valve**      **2) Rotator, Valve**  
**2) Exhaust**      **2) Exhaust**      **2) Exhaust**      **3) O'ring, Valve**      **3) O'ring, Valve**

<b>TR43883</b> Std. <b>TR45003</b> .003 <b>TR45004</b> .015	<b>TR43679</b> Std. <b>TR43787</b> .003 <b>TR43788</b> .015	1) <b>TR43680</b> Std. 2) <b>TR43681</b> Std.	1) <b>TT20129</b> 2) <b>TT20077</b>	1) <b>TR26125</b> 2) <b>TRE11410</b> 3) <b>TR87627</b>
---	---	--	--	--



**Thermostat**      **Fuel Transfer Pump**      **Water Pump Rep Kit**      **Water Pump**      **Pump, Oil, Quad Transmission**  
 a) Without Impeller      b) With Impeller      **TRE55985** (m) R71224, (m) R83561

<b>TR48675</b> 180° F	<b>TRE38009</b>	<b>See Chart</b>		<b>TRE20918</b> For Tractors 4240,4050
-----------------------	-----------------	------------------	--	--

(1) Shape, Conrod Bushing.  
 (2) **TMX365** Consists of: **TR88042** x6, **TR88043** x5, **TR88044** x8, **TR88045** x7. \* With ESN > 318403.  
 (3) **TMX366** Consists of: **TR88043** x11, **TR88044** x8, **TR88045** x7. \*\* With ESN 318404 >.  
 (4) **TRE53422** will require front key **TR116311** for the front damper.