

**400 Series**  
**Engine & Equipment**  
**Model**  
**6.404T/A**

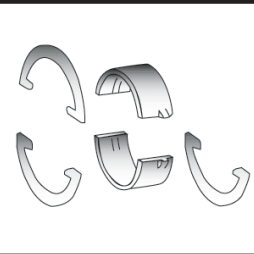
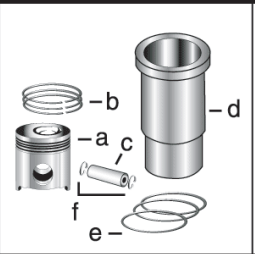

335,846 >

6 Cyl

Bore: 4.25 in  
 108 mm  
 Pin Ø: 1.61 in  
 41 mm

**Block (m):**  
 R49470, R49650, R59850,  
 R72128, R87558

**APPLICATIONS:**

**AGRICULTURAL**  
 4320 5440  
 4430 6600  
 4630 7700

**CONSTRUCTION**  
 690B  
 693C  
 740

1) Engine O/H Kit      Piston-Liner Kit      Main Bearing      Thrust Bearing      Con Rod Bearing

2) Engine I/F Kit	<b>TAR63272</b>	<b>TAR74814</b> Std.	<b>TAR77748</b> Std.	<b>TAR45723</b> Std.	
	Consists of:	<b>TAR74816</b> .010	<b>TAR77750</b> .010	<b>TAR46396</b> .010	
1) <b>TRG17892</b>	a) <b>TAR54552</b>	<b>TAR74817</b> .020	<b>TAR77751</b> .020	<b>TAR46397</b> .020	
2) <b>TIK17892</b>	b) <b>TAR51741</b>	<b>TAR74818</b> .030	<b>TAR77752</b> .030	<b>TAR46398</b> .030	
	c) <b>TR41425</b>	<b>Use 6</b>		<b>Use 6</b>	
	d) <b>TR40615</b>	<b>Use 1</b>		<b>Use 6</b>	
	e) <b>TAR65507</b>	<b>Thrust Washer</b>			
	f) <b>TR54114</b>	<b>TAR77747</b> Std.			
		<b>TAR77753</b> .007			
		<b>Use 3, Order Qty 1</b>			

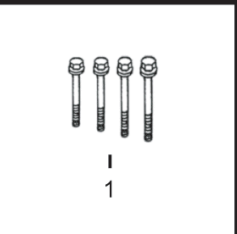
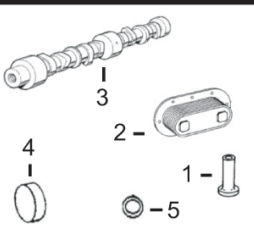
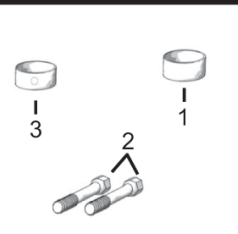
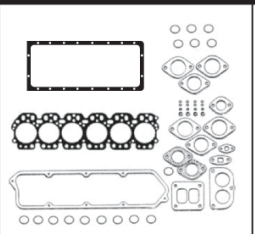
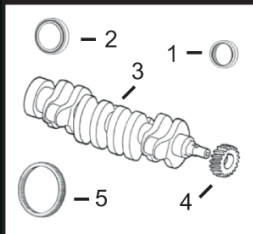

1) Front Seal 2) Rear Seal	1) O/H Gasket Set	1) Bush, Con Rod 2) Bolt, Con Rod 3) Bushing, Cam	1) Cam Follower 2) Oil Cooler 3) Camshaft Kit 4) Plug, Camshaft 5) O'ring, Oil Cooler	1) Head Bolt Kit
3) Crankshaft 4) Crankshaft, Gear 5) Ring Gear	2) Head Gasket Set 3) Head Gasket 4) Oil Pan Gasket			

1) <b>TAR49025</b> 2) <b>TRE520036</b> 3) <b>TRE53422</b> (2) 4) <b>TR26049</b> (23T) 5) <b>TR28811</b> (129T)	1) <b>TAR63269</b> 2) <b>TAR63270</b> 3) <b>TR48291</b> 4) <b>TR71918</b>	1) <b>TR42173</b> x6 2) <b>TR66452</b> x12 3) <b>TR46903</b> x4	1) <b>TR52773</b> 2) <b>TAR55394</b> For T Engines <b>TAT25038</b> For A Engines 3) <b>TAR100385</b> 4) <b>TR26115</b> 5) <b>TR47153</b>	1) <b>TMX365</b> (1)
--	--	---	---	----------------------

Valve, Intake	Valve, Exhaust	Insert, Valve 1) Intake 2) Exhaust	1) Cap, Valve 2) Lock, Valve	1) Spring, Valve 2) Rotator, Valve 3) O'ring, Valve
<b>TR50358</b> Std. <b>TR55055</b> .003 <b>TR55057</b> .015	<b>TR50357</b> Std. <b>TR55056</b> .003 <b>TR55058</b> .015	1) <b>TR78702</b> Std. 2) <b>TR50356</b> Std.	1) <b>TT20129</b> 2) <b>TT20077</b>	1) <b>TR26125</b> 2) <b>TRE11410</b> 3) <b>TR87627</b>

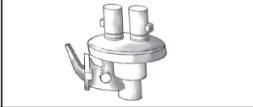

Thermostat	Fuel Transfer Pump	Water Pump Repair Kit		Pump, Oil, Quad Transmission
<b>TAR48675</b> 180° F	Not Used	Without Impeller	With Impeller	<b>TRE20918</b> For Tractors 4430,4630, 5440
		<b>See Chart</b>		

(1) **TMX365** Consists of: **TR88042** x6, **TR88043** x5, **TR88044** x8, **TR88045** x7.  
 (2) **TRE53422** will require front key **TR116311** for the front damper.