

**400 Series**  
**Engine & Equipment**  
**Model**  
**6.466T**

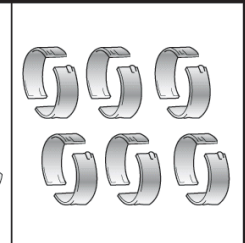
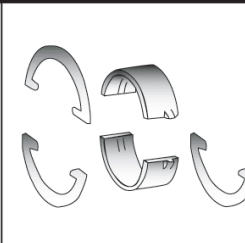
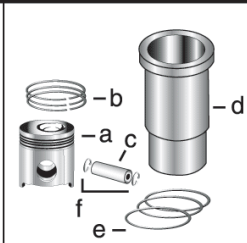

**1) Engine O/H Kit**      **Piston-Liner Kit**      **Main Bearing**      **Thrust Bearing**      **Con Rod Bearing**

253,373 >

**6.466A**

**2) Engine I/F Kit**

317,859 >

**1) TRG18847**

**TAR100646**  
 Consists of:

**TAR74814** Std.  
**TAR74816** .010  
**TAR74817** .020  
**TAR74818** .030

**TAR77748** Std.  
**TAR77750** .010  
**TAR77751** .020  
**TAR77752** .030

**TAR73277** Std.  
**TAR73279** .010  
**TAR73280** .020  
**TAR73281** .030

6 Cyl

**2) TIK18847**

a) **TAR100616**  
 b) **TRE48380**  
 c) **TR57771**  
 d) **TAR63060**  
 e) **TAR98850**  
 f) **TE1343FN**

**Use 6**

**Use 1**  
**Thrust Washer**  
**TAR77747** Std.  
**TAR77753** .007

**Use 6**

Bore: 4.56 in  
 116 mm  
 Pin Ø: 1.85 in  
 47 mm

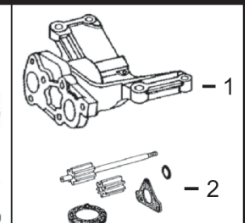
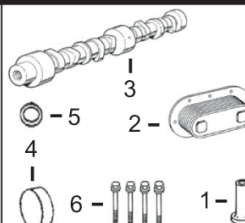
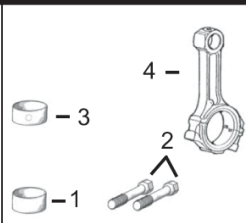
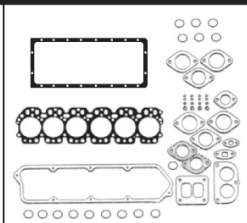
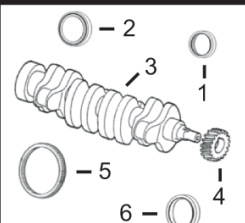

**Con Rod (m):**  
 R71074 (P/N AR93341)

**1) Front Seal**  
**2) Rear Seal**

**1) O/H Gasket Set**

**1) Bush, Con Rod**  
**2) Bolt, Con Rod**  
**3) Bushing, Cam**

1) Cam Follower  
 2) Oil Cooler  
 3) Camshaft Kit  
 4) Plug, Camshaft  
 5) O'ring, Oil Cooler  
 6) Head Bolt Kit

1) Pump, Oil  
 2) Repair Kit

**APPLICATIONS:**

**AGRICULTURAL**

- 4250      5730
- 4440      6602
- 4450      6620
- 4640      6622
- 4650      7720
- 5460      9940
- 5720      9950

3) Crankshaft  
 4) Crankshaft, Gear  
 5) Ring Gear  
 6) Rear Gear

2) Head Gasket Set  
 3) Head Gasket  
 4) Oil Pan Gasket

4) Con Rod

1) **TR52773**  
 2) **TAT25038** (5)  
 3) **TAR100385**  
 4) **TR26115**  
 5) **TR47153**  
 6) **TMX365** (3)\*  
**TMX366** (4)\*\*

1) **TRE60622**  
 2) **TMX1062** (2)

**CONSTRUCTION**

- 644C      790D
- 690C      850B
- 762A/B    892D
- 770A/B

1) **TAR49025**  
 2) **TRE520036**  
 3) **TRE53422** (6)  
 4) **TR26049** (23T)  
 5) **TR28811** (129T)  
 6) **TR63326**

1) **TAR98845**  
 2) **TAR98851**  
 3) **TRE47336**  
 4) **TR71918**

1) **TR74008** x6  
 2) **TR66452** x12  
 3) **TR46903** x4  
 4) **TAR93341** x1  
 (1)



Valve, Intake  
**TR50358** Std.  
**TR55055** .003  
**TR55057** .015

Valve, Exhaust  
**TR50357** Std.  
**TR55056** .003  
**TR55058** .015

Insert, Valve  
 1) Intake  
 2) Exhaust  
 1) **TR78702** Std.  
 2) **TR50356** Std.

1) Cap, Valve  
 2) Lock, Valve  
 1) **TT20129**  
 2) **TT20077**

1) Spring, Valve  
 2) Rotator, Valve  
 3) O'ring, Valve  
 1) **TR26125**  
 2) **TRE11410**  
 3) **TR87627**

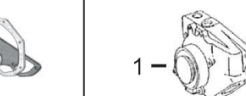
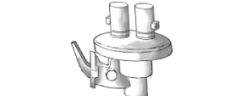

**Thermostat**

**Fuel Transfer Pump**

**Water Pump Rep Kit**  
 a) Without Impeller  
 b) With Impeller

**Water Pump**

1) **TRE55985** (m) R71224, (m) R83561  
 2) **TRE20022** (OEM ESN 067685 >)

**Pump, Oil, Quad Transmission**

**TAR48675** 180° F

Not Used

See Chart

**TRE20918**  
 For Tractors  
 4250, 4040, 4450, 4640, 4650

(1) Shape, Conrod Bushing.  
 (2) For Crankshaft driven Engine Pump, Oil Consists of: Shaft, Gears, and Gaskets.  
 (3) **TMX365** Consists of: **TR88042** x6, **TR88043** x5, **TR88044** x8, **TR88045** x7. \* With ESN > 317676.  
 (4) **TMX366** Consists of: **TR88043** x11, **TR88044** x8, **TR88045** x7. \*\* With ESN 317677 >.  
 (5) Some applications use **TAR55394**.  
 (6) **TRE53422** will require front key **TR116311** for the front damper.