

400 Series

Engine & Equipment
Model

6076T/A/H

High Ring Piston

6 Cyl

Bore: 4.56 in
116 mm
Pin Ø: 1.85 in
47 mm

Con Rod (m):
R71074 (P/N AR93341)

APPLICATIONS:

AGRICULTURAL

1185	7700
2066	7800
4055	8100
4255	8200
4455	8300
4555	9500
4560	9600
4755	9960
4760	9965

CONSTRUCTION

644E/ER	772B/BH
644G/GH	792D/LC
740E/G	850C
748E/G	
770B/BH	

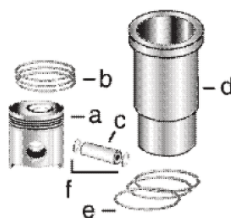

1) Engine O/H Kit	Piston-Liner Kit	Main Bearing	Thrust Bearing	Con Rod Bearing
-------------------	------------------	--------------	----------------	-----------------

2) Engine I/F Kit	TRE60294 Consists of:	TAR74814 Std. TAR74816 .010 TAR74817 .020 TAR74818 .030	TAR77748 Std. TAR77750 .010 TAR77751 .020 TAR77752 .030	TAR73277 Std. TAR73279 .010 TAR73280 .020 TAR73281 .030
-------------------	---------------------------------	--	--	--

1) TRE64212	a) TRE57512	Use 6	Use 1	Use 6
2) TIK64212	b) TRE57517			

	c) TR57771		Thrust Washer	
	d) TAR63060		TAR77747 Std.	
	e) TAR98850		TAR77753 .007	
	f) TE1343FN		Use 3, Order Qty 1	

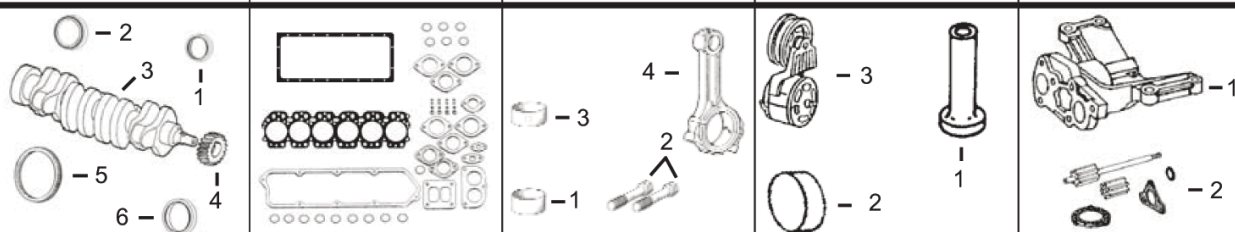

1) Front Seal 2) Rear Seal	1) O/H Gasket Set	1) Bush, Con Rod 2) Bolt, Con Rod 3) Bushing, Cam	1) Tappet 2) Plug, Camshaft 3) Tensioner, Belt	1) Pump, Oil 2) Repair Kit
3) Crankshaft 4) Crankshaft, Gear 5) Ring Gear 6) Rear Gear	2) Head Gasket Set 3) Head Gasket 4) Oil Pan Gasket	4) Con Rod		

1) TAR49025	1) TRE35647	1) TR74008 x6	1) TR110126	1) TRE60622 (2)
2) TRE520036	2) TRE29859	2) TR66452 x12	2) TR82007	2) TMX1062
3) TRG23551 (1)	3) TRE47336	3) TR87561 x4	3) TRE57498 (3)	
4) TR104587	4) TR71918	4) TAR93341 x1	TRE68715 (3)	
5) TR28811 (129T)				
6) TR63326				

Valve, Intake	Valve, Exhaust	Insert, Valve 1) Intake 2) Exhaust	1) Cap, Valve 2) Lock, Valve 3) Shield, Valve	1) Spring, Valve 2) Rotator, Valve
---------------	----------------	--	---	---------------------------------------

TR84618 Std. TR93308 .003 TR93312 .015	TR84619 Std. TR93311 .003 TR93313 .015	1) TR84977 Std. 2) TR84976 Std.	1) TT20129 2) TT20077 3) TR102882	1) TR91822 2) TRE11410
---	---	--	--	---



Thermostat	Fuel Transfer Pump	Water Pump Repair Kit		Water Pump
TAR48675 180° F	N/A	Without Impeller	With Impeller	TRE55985 (m) R71224, (m) R83561 (3) or TRE68230 (HIGH FLOW)
		See Chart		

(1) C/S (m) RE53199, with straight front gear [TR104587](#). Helical gear should be discarded. TRE53422 will require front key [TR116311](#) for the front damper.
 (2) If housing is marked (m) R124746 or R504071 use [TRE63115R](#) (Reman Unit).
 (3) Check application for proper usage.