

**400 Series**  
**Engine & Equipment**  
**Model**  
**6.466A**  
 233,593-317,858

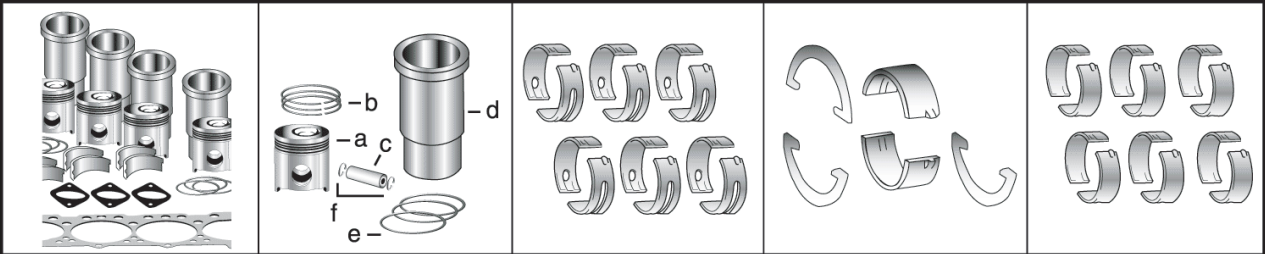

**1) Engine O/H Kit**      **Piston-Liner Kit**      **Main Bearing**      **Thrust Bearing**      **Con Rod Bearing**

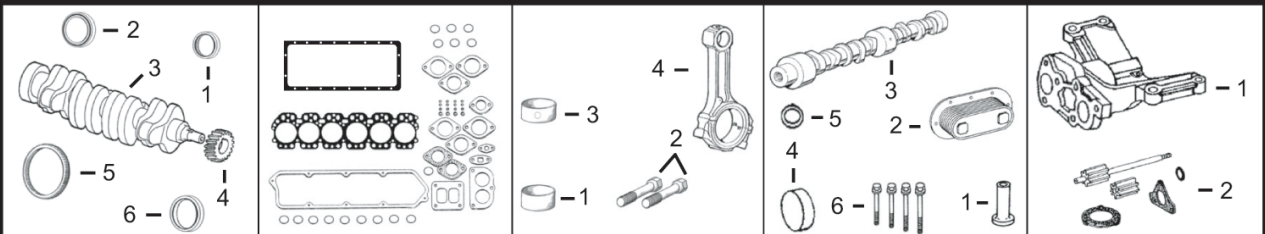

<b>2) Engine I/F Kit</b>	<b>TAR100960</b> Consists of:	<b>TAR74814</b> Std. <b>TAR74816</b> .010 <b>TAR74817</b> .020 <b>TAR74818</b> .030	<b>TAR77748</b> Std. <b>TAR77750</b> .010 <b>TAR77751</b> .020 <b>TAR77752</b> .030	<b>TAR73277</b> Std. <b>TAR73279</b> .010 <b>TAR73280</b> .020 <b>TAR73281</b> .030
	<b>1) TRG20142</b> <b>2) TIK20142</b> a) <b>TAR100673</b> b) <b>TRE48380</b> c) <b>TR57771</b> d) <b>TAR63060</b> e) <b>TAR98850</b> f) <b>TE1343FN</b>	<b>Use 6</b>	<b>Use 1</b> <b>Thrust Washer</b> <b>TAR77747</b> Std. <b>TAR77753</b> .007 <b>Use 3, Order Qty 1</b>	<b>Use 6</b>

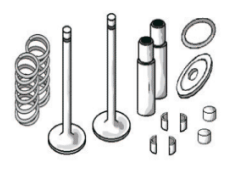

**1) Front Seal**      **1) O/H Gasket Set**      **1) Bush, Con Rod**      **1) Cam Follower**      **1) Pump, Oil**  
**2) Rear Seal**      **2) Head Gasket Set**      **2) Bolt, Con Rod**      **2) Oil Cooler**      **2) Repair Kit**  
**3) Crankshaft**      **3) Head Gasket**      **3) Bushing, Cam**      **3) Camshaft Kit**  
**4) Crankshaft, Gear**      **4) Oil Pan Gasket**      **4) Con Rod**      **4) Plug, Camshaft**  
**5) Ring Gear**      **5) O'ring, Oil Cooler**  
**6) Rear Gear**      **6) Head Bolt, Kit**

<b>1) TAR49025</b> <b>2) TRE520036</b> <b>3) TRE53422 (6)</b> <b>4) TR26049 (23T)</b> <b>5) TR28811 (129T)</b> <b>6) TR63326</b>	<b>1) TAR98845</b> <b>2) TAR98851</b> <b>3) TRE47336</b> <b>4) TR71918</b>	<b>1) TR74008 x6</b> <b>2) TR66452 x12</b> <b>3) TR46903 x4</b> <b>4) TAR93341 x1</b>  <b>(1)</b>	<b>1) TR52773</b> <b>2) TAT25038 (5)</b> <b>3) TAR100385</b> <b>4) TR26115</b> <b>5) TR47153</b> <b>6) TMX365 (3)*</b> <b>TMX366 (4)**</b>	<b>1) TRE60622</b> <b>2) TMX1062 (2)</b>
---	---	---	--	---

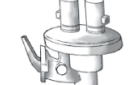
	Valve, Intake	Valve, Exhaust	Insert, Valve 1) Intake 2) Exhaust	1) Cap, Valve 2) Lock, Valve	1) Spring, Valve 2) Rotator, Valve 3) O'ring, Valve
	<b>TR50358</b> Std. <b>TR55055</b> .003 <b>TR55057</b> .015	<b>TR50357</b> Std. <b>TR55056</b> .003 <b>TR55058</b> .015	1) <b>TR78702</b> Std. 2) <b>TR50356</b> Std.	1) <b>TT20129</b> 2) <b>TT20077</b>	1) <b>TR26125</b> 2) <b>TRE11410</b> 3) <b>TR87627</b>

					
Thermostat	Fuel Transfer Pump	Water Pump Repair Kit		Water Pump	
<b>TAR48675</b> 180° F	Not Used	Without Impeller	With Impeller	1) <b>TRE55985</b> (m) R71224, (m) R83561 2) <b>TRE20022</b> (OEM ESN 067685 >)	
		<a href="#">See Chart</a>			

**(1)** Shape, Conrod Bushing.  
**(2)** For Crankshaft driven Engine Pump, Oil Consists of: Shaft, Gears, and Gaskets.  
**(3)** **TMX365** Consists of: **TR88042 x6, TR88043 x5, TR88044 x8, TR88045 x7.** \* With ESN > 317676.  
**(4)** **TMX366** Consists of: **TR88043 x11, TR88044 x8, TR88045 x7.** \*\* With ESN 317677 >.  
**(5)** Some applications use **TAR55394**.  
**(6)** **TRE53422** will require front key **TR116311** for the front damper.