

**400 Series**  
**Engine & Equipment**  
**Model**  
**6076T/A/H**  
**Low Ring Piston**

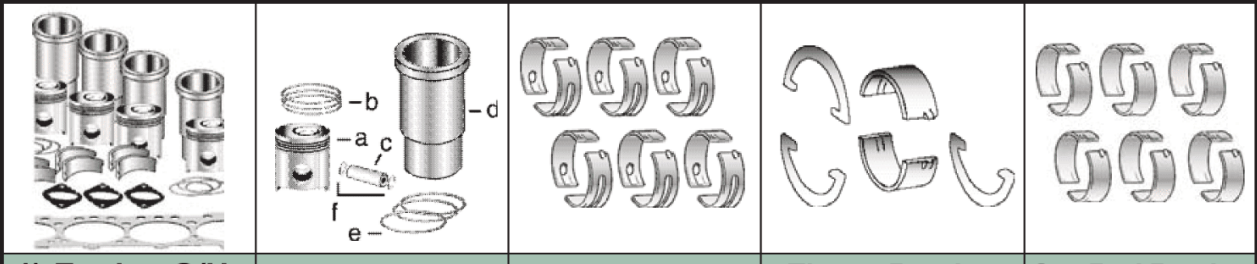

**6 Cyl**

Bore: 4.56 in  
 116 mm

Pin Ø: 1.85 in  
 47 mm

1) Engine O/H Kit	Piston-Liner Kit	Main Bearing	Thrust Bearing	Con Rod Bearing
<b>2) Engine I/F Kit</b>	<b>TRE60297</b> Consists of:	<b>TAR74814</b> Std. <b>TAR74816</b> .010 <b>TAR74817</b> .020 <b>TAR74818</b> .030	<b>TAR77748</b> Std. <b>TAR77750</b> .010 <b>TAR77751</b> .020 <b>TAR77752</b> .030	<b>TAR73277</b> Std. <b>TAR73279</b> .010 <b>TAR73280</b> .020 <b>TAR73281</b> .030
<b>1) TRE60299</b>	a) <b>TRE57731</b> (1) b) <b>TRE48380</b> c) <b>TR57771</b> d) <b>TAR63060</b> e) <b>TAR98850</b> f) <b>TE1343FN</b>	<b>Use 6</b>	<b>Use 1</b> <b>Thrust Washer</b> <b>TAR77747</b> Std. <b>TAR77753</b> .007 <b>Use 3, Order Qty 1</b>	<b>Use 6</b>
<b>2) TIK60299</b>				

**Con Rod (m):**  
 R71074 (P/N AR93341)

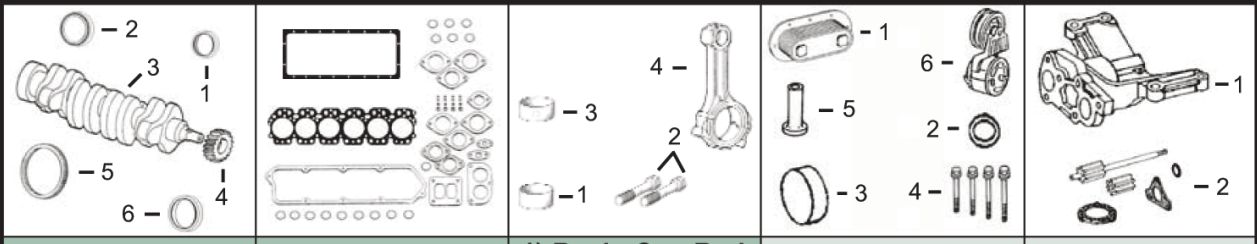

**APPLICATIONS:**

**AGRICULTURAL**  
 4955 8560  
 4960 8570

**CONSTRUCTION**  
 892E (1)

1) Front Seal 2) Rear Seal	1) O/H Gasket Set	1) Bush, Con Rod 2) Bolt, Con Rod 3) Bushing, Cam	1) Oil Cooler 2) O'ring, Oil Cooler 3) Plug, Camshaft 4) Head Bolt Kit 5) Tappet 6) Tensioner, Belt	1) Pump, Oil 2) Repair Kit
3) Crankshaft 4) Crankshaft, Gear 5) Ring Gear 6) Rear Gear	2) Head Gasket Set 3) Head Gasket 4) Oil Pan Gasket	4) Con Rod		
1) <b>TAR49025</b> 2) <b>TRE520036</b> 3) <b>TRE53201</b> (2)(5) or <b>TRE53422</b> (3)(5) 4) <b>TR105488</b> (4) 5) <b>TR28811</b> (129T) 6) <b>TR63326</b>	1) <b>TRE35647</b> 2) <b>TRE29859</b> 3) <b>TRE47336</b> 4) <b>TR71918</b>	1) <b>TR74008</b> x6 2) <b>TR66452</b> x12 3) <b>TR87561</b> x4 4) <b>TAR93341</b> x1	1) <b>TAR55394</b> (7) 2) <b>TR47153</b> 3) <b>TR82007</b> 4) <b>TMX366</b> (6) 5) <b>TR110126</b> (8) 6) <b>TRE57498</b> (9) <b>TRE68715</b> (9)	1) <b>TRE60622</b> (10) 2) <b>TMX1062</b>

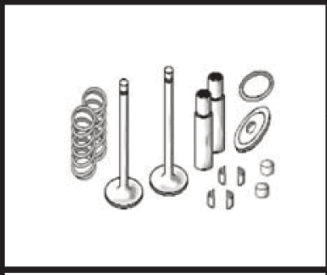

Valve, Intake	Valve, Exhaust	Insert, Valve 1) Intake 2) Exhaust	1) Cap, Valve 2) Lock, Valve 3) Shield, Valve	1) Spring, Valve 2) Rotator, Valve
<b>TR84618</b> Std. <b>TR93308</b> .003 <b>TR93312</b> .015	<b>TR84619</b> Std. <b>TR93311</b> .003 <b>TR93313</b> .015	1) <b>TR84977</b> Std. 2) <b>TR84976</b> Std.	1) <b>TT20129</b> 2) <b>TT20077</b> 3) <b>TR102882</b>	1) <b>TR91822</b> 2) <b>TRE11410</b>

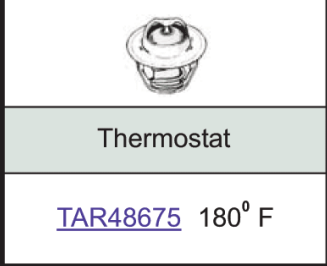

Thermostat	Fuel Transfer Pump	Water Pump Repair Kit	Water Pump
<b>TAR48675</b> 180° F	N/A	Without Impeller      With Impeller	<b>TRE55985</b> (m) R71224, (m) R83561 (9) or <b>TRE68230</b> (HIGH FLOW)
		<b>See Chart</b>	

(1) Low Ring Piston.  
 (2) Long snout (3.4in.) C/S (m) R87544, RE53201.  
 (3) Short snout (3in) C/S (m) RE53203, R63451, R104855.  
 (4) **TRE53422** Use Helicoidal front gear.  
 (5) Require front key **TR116311** for the front damper.  
 (6) Use with blocks marked R109806 and below.  
 (7) ESN > 100664 Use: **TAT25038**. Not for use with ESN 500,000 >.  
 (8) ESN 192401 >  
 (9) Check application for proper usage.  
 (10) If housing is marked (m) R124746 or R504071 or ESN 500 000 > use **TRE63115R** (Reman Unit).