

300 Series

Engine & Equipment
Model

3029D

Liter Designated

3 Cyl

Bore: 4.19 in
106.5 mm
Pin Ø: 1.375 in
35 mm

Con Rod (m):

R51727, R80034

APPLICATIONS:

AGRICULTURAL

5200
5300
5400

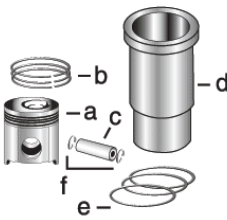

1) Engine O/H Kit

Piston-Liner Kit

Main Bearing

Thrust Bearing

Con Rod Bearing

2) Engine I/F Kit

[TRE30250](#)

Consists of:

- a) [TRE19282](#)
- b) [TRE66820](#)
- c) [TR125754](#)
- d) [TR116281](#)
- e) [TAR65507](#)
- f) [TM41029](#)

[TRE27352](#) Std.

[TAT21139](#) Std.

[TRE27348](#) Std.

[TRE27353](#) .010

[TAT21132](#) .010

[TRE27349](#) .010

[TRE27360](#) .020

[TAT21134](#) .020

[TRE27358](#) .020

[TRE27368](#) .030

[TAT21136](#) .030

[TRE27364](#) .030

Use 3

Use 1

Use 3

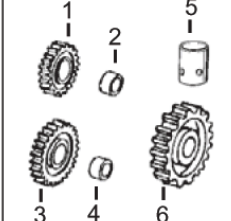
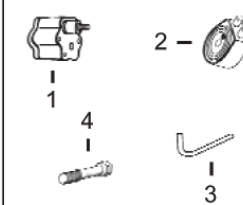
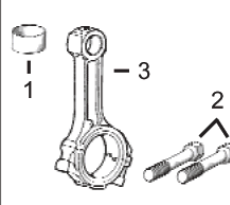
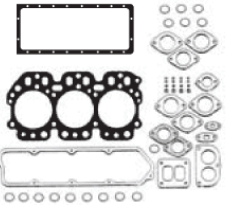
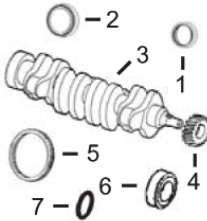

1) Front Seal
2) Rear Seal

1) O/H Gasket Set

1) Bush, Con Rod
2) Bolt, Con Rod

1) Pump, Oil
2) Oil Cooler
3) Pump, Oil Tube
4) Cyl Hd Cap Screw

1) Lower Gear
2) Lower Bushing
3) Upper Gear
4) Upper Bushing
5) Cam. Follower
6) Cam. Gear

3) Crankshaft
4) Crankshaft, Gear
5) Ring Gear
6) Sleeve, Front
7) Packing, Sleeve

2) Head Gasket Set
3) Head Gasket
4) Oil Pan Gasket
5) Rocker Cover Gsk

3) Con Rod

1) [TAR67942](#)
2) [TRE44574](#)
3) [TRE50979](#)
4) [TT20094](#) (3)
5) [TR114282](#) (142T)
6) [TR81989](#)
7) [TH35244](#)

1) [TRE501578](#)
2) [TRE38850](#)
3) [TR97356](#)
4) [TR97341](#)
5) [TR106796](#) (1)
or
[TR75729](#) (2)

1) [TR55647](#) x3
2) [TR80033](#) x6
3) [TRE16495](#)

1) [TRE55343](#)
2) [TRE61767](#)
3) [TR113752](#)
4) [TR85363](#) x14 (4)

1) [TAT24252](#) (3)
2) [TT26321](#)
3) [TAT18009](#) (3)
4) [TT20034](#)
5) [TT20073](#)
6) [TT20070](#) (3)

Valve, Intake

Valve, Exhaust

Insert, Valve

1) Seal, Valve
2) Lock, Valve

1) Spring, Valve
2) Rotator, Valve

[TR98062](#) Std.
[TR97490](#) .015

[TR90692](#) Std.
[TR97492](#) .015

1) [TR98063](#) Std.
[TR98335](#) O/S
2) [TR51734](#) Std.
[TR93910](#) O/S

1) [TRE31617](#)
2) [TR91889](#)

1) [TR26125](#)
2) [TRE60005](#)

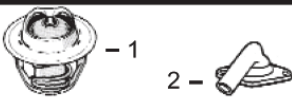

1) Thermostat
2) Thermostat Cover

1) [TRE64354](#) 180° F
2) [TT23620](#)



Fuel Transfer Pump

[TRE42211](#)

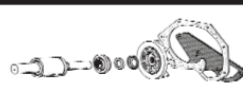

Water Pump Rep Kit
a) Without Impeller
b) With Impeller

a) [TRE19507](#)
b) [TRE62658](#)



Water Pump

[TAR97708](#) (m) R73604
[TRE60489](#) (m) R100812, (m) R127337
(m) R127918, (m) R55164



Injector, Pencil

[TRE36936](#)



Seal

[TR60746](#)
[TR48000](#)

(1) Not included in Gasket Set. Used in Saran Engines (Order Separately).

(2) Reusable.

(3) Helicoidal Gears.

(4) Replace all R78558 Cap Screws with Flanged Head Cap Screw [TR85363](#).