

**PowerTech**  
**Engine & Equipment**  
**Model**

**4045D**

4.5D  
 4 Cyl

Bore: 4.19 in  
 106.5 mm  
 Pin Ø: 1.375 in  
 35 mm

**Piston (m):**  
 RE59279, RE505101

**Con Rod (m):**  
 R123959, R500000

**APPLICATIONS:**

**AGRICULTURAL**

- 5410 5715
- 5415 6010
- 5420/N 6110
- 5510 6610
- 5615

**OEM**

4.5L

**CONSTRUCTION**

- 210LE 486E
- 310E 488E
- 450H 550H
- 485E 650H

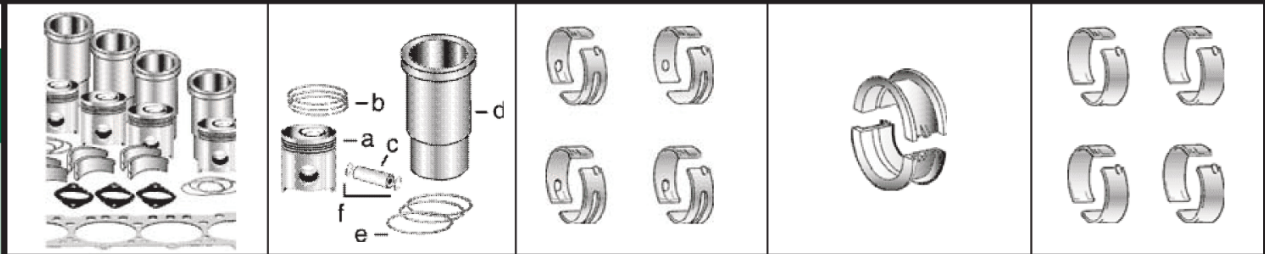

1) Engine O/H Kit      Piston-Liner Kit      Main Bearing      Thrust Bearing      Con Rod Bearing

2) Engine I/F Kit      **TRE65966** (RE505110)      **TRE65165** Std.      **TRE65168** Std.      **TRE65908** Std.

1) **TRE66092**      Consists of:      **TRE65911** .010      **TRE65912** .010      **TRE65909** .010  
**TRE66092A** (\*)      a) **TRE59279**      **TRE65165B** .020 (9)      **TRE65168B** .020 (9)      **TRE65908B** .020 (9)  
 (\*) w/C. Rod R500000      b) **TRE66271**

2) **TIK66092**      c) **TR123178**      **Use 4**      **Use 1**      **Use 4**  
**TIK66092A** (\*)      d) **TR116383**  
 (\*) w/C. Rod R500000      e) **TAR65507**  
 f) **TM41029**

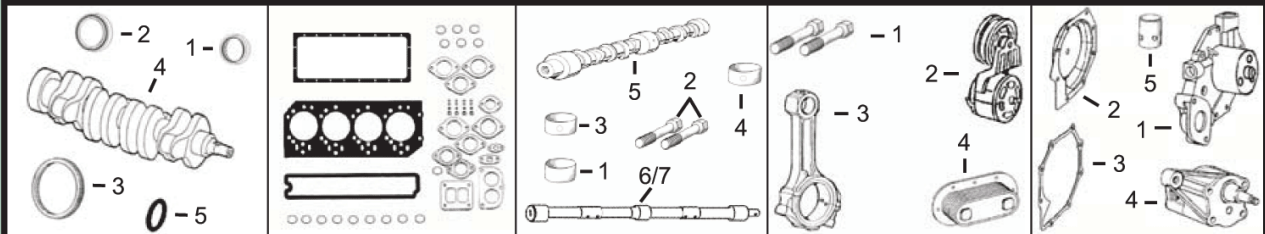

1) Front Seal      1) O/H Gasket Set      1) Bush, Con Rod      1) Cyl Hd Cap Screw      1) Water Pump  
 2) Rear Seal      2) Head Gasket Set      2) Bolt, Con Rod      2) Tensioner, Belt      2) Water Pump Cov  
 3) Ring Gear      3) Head Gasket      3) Bush, Bal.Shaft      3) Con Rod      3) Water Pump Gsk  
 4) Crankshaft      4) Oil Pan Gasket      4) Bush, Camshaft      4) Oil Cooler      4) Pump, Oil  
 5) Seal      5) Rocker Cover Gsk      5) Camshaft      5) Tappet

1) **TRE505515** (8)      1) **TRE501455**      1) **TR123960** x4      1) **TR85363** x18 (4)      1) **TRE500737**  
 2) **TRE44574**      2) **TRE66082**      2) **TR114083** x8 (1)      2) **TRE518097** (10)      (Standard Flow)  
 3) **TR28811** (129T)      3) **TR116515**      3) **TR501124** x8 (1)      3) **TRE68715** (10)      **TRE500734**  
 or      4) **TR123352** (2)      4) **TR115299** x6      4) **TRE500002**      (High Flow)  
**TR114282** (142T)      5) **TR97342** (3)      5) **TR119874** x1      5) **TRE59296** (5 Plates)      2) **TRE508566**  
 4) **TRE50618** (5)      (R123353)      6) **TRE56375** (6)      6) **TRE56690** (7 Plates)      3) **TR123417**  
 5) **TH35244**      5) **TR123542**      7) **TRE500449**      7) **TRE59298** (9 Plates)      4) **TRE504914**  
 5) **TR123565** x8

Valve, Intake      Valve, Exhaust      Insert, Valve      1) Seal, Valve      1) Spring, Valve  
 1) Intake      1) Intake      1) Intake      2) Lock, Valve      2) Rotator, Valve  
 2) Exhaust      2) Exhaust      2) Exhaust

**TR98062** Std.      **TR90692** Std.      1) **TR98063** Std.      1) **TRE31617**      1) **TR26125**  
**TR97490** .015      **TR97492** .015      **TR98335** O/S      2) **TR91889**      2) **TRE60005**  
 2) **TR85687** Std.      1) **TR93910** O/S

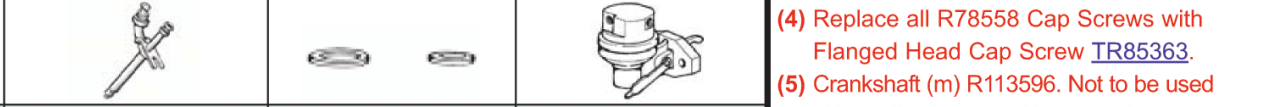

Thermostat      Injector, Pencil      Seal, Injector      Fuel Transfer Pump

**TRE522076** 180° F (10)      **TRE60062** (Non Turbo)      **TR92352**      **TRE68345**  
**TRE528652** 180° F (10)      **TRE48786** (Turbo)      **TR48000**      or  
**TRE540550** 180° F (10)      **TRE531436** (11)      **TRE66153** (7)  
**TRE64354** 180° F (10)

(1) Use **TR114083** Rod Bolts with Machine Split Connecting Rods, and use **TR501124** Rod Bolts with Fractured Split Connecting Rods.  
 (2) Use with Oil Pan code 1901, 1902 & 1903, for Steel Oil Pan.  
 (3) Use with Oil Pan code 1904 & 1905, for Aluminum Oil Pan.  
 (4) Replace all R78558 Cap Screws with Flanged Head Cap Screw **TR85363**.  
 (5) Crankshaft (m) R113596. Not to be used with applications requiring speed sensor gear.  
 (6) (m) R135439, R132324, R134213.  
 (7) Line Connections are both threaded.  
 (8) 1 Piece Unitized Seal and Wearsleeve; Replaces **TRE59810**, **RE538097**.  
 (9) Proper bearing journal radius must be maintained during the machining of the crankshaft to ensure proper operation.  
 (10) Check application for proper usage.  
 (11) Use with Stanadyne DE10 Injection Pump.