

400 Series
Engine & Equipment
Model
6.404T/A

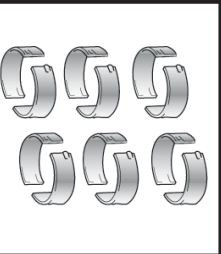
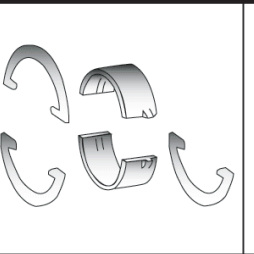
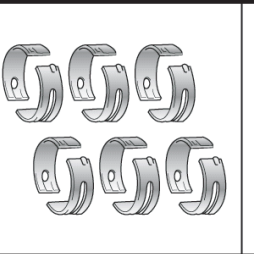
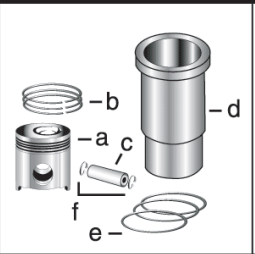

335,846 >

6 Cyl

Bore: 4.25 in
 108 mm
 Pin Ø: 1.61 in
 41 mm

Block (m):
 R49470, R49650, R59850,
 R72128, R87558

APPLICATIONS:

AGRICULTURAL

4320 5440
 4430 6600
 4630 7700

CONSTRUCTION

690B
 693C
 740

1) Engine O/H Kit **Piston-Liner Kit** **Main Bearing** **Thrust Bearing** **Con Rod Bearing**

2) Engine I/F Kit 1) TRG17892 2) TIK17892	TAR63272 Consists of: a) TAR54552 b) TAR51741 c) TR41425 d) TR40615 e) TAR65507 f) TR54114	TAR74814 Std. TAR74816 .010 TAR74817 .020 TAR74818 .030 Use 6	TAR77748 Std. TAR77750 .010 TAR77751 .020 TAR77752 .030 Use 1 Thrust Washer TAR77747 Std. TAR77753 .007 Use 3, Order Qty 1	TAR45723 Std. TAR46396 .010 TAR46397 .020 TAR46398 .030 Use 6
--	--	--	---	--

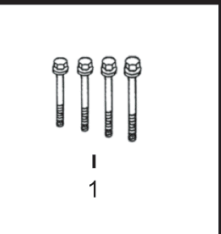
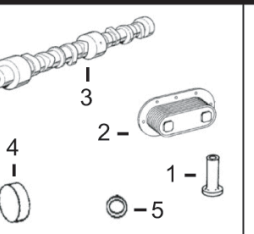
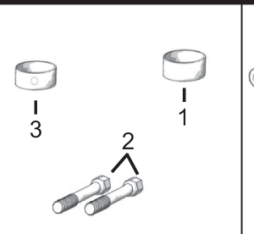
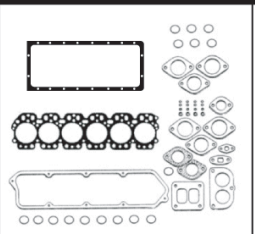
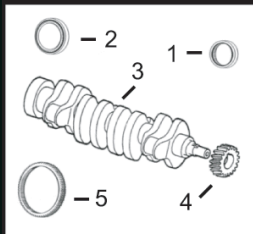

1) Front Seal 2) Rear Seal	1) O/H Gasket Set	1) Bush, Con Rod 2) Bolt, Con Rod 3) Bushing, Cam	1) Cam Follower 2) Oil Cooler 3) Camshaft Kit 4) Plug, Camshaft 5) O'ring, Oil Cooler	1) Head Bolt Kit
---	--------------------------	--	---	------------------

3) Crankshaft 4) Crankshaft, Gear 5) Ring Gear	2) Head Gasket Set 3) Head Gasket 4) Oil Pan Gasket			
--	---	--	--	--

1) TAR49025 2) TRE520036 3) TRE53422 (2) 4) TR26049 (23T) 5) TR28811 (129T)	1) TAR63269 2) TAR63270 3) TR48291 4) TR71918	1) TR42173 x6 2) TR66452 x12 3) TR46903 x4	1) TR52773 2) TAR55394 For T Engines TAT25038 For A Engines 3) TAR100385 4) TR26115 5) TR47153	1) TMX365 (1)
---	--	--	---	-------------------------------

Valve, Intake	Valve, Exhaust	Insert, Valve 1) Intake 2) Exhaust	1) Cap, Valve 2) Lock, Valve	1) Spring, Valve 2) Rotator, Valve 3) O'ring, Valve
---------------	----------------	--	---------------------------------	---

TR50358 Std. TR55055 .003 TR55057 .015	TR50357 Std. TR55056 .003 TR55058 .015	1) TR78702 Std. 2) TR50356 Std.	1) TT20129 2) TT20077	1) TR26125 2) TRE11410 3) TR87627

Thermostat TAR48675 180° F	Fuel Transfer Pump Not Used	Water Pump Repair Kit Without Impeller With Impeller See Chart	Pump, Oil, Quad Transmission TRE20918 For Tractors 4430,4630, 5440

(1) [TMX365](#) Consists of: [TR88042](#) x6, [TR88043](#) x5, [TR88044](#) x8, [TR88045](#) x7.
 (2) [TRE53422](#) will require front key [TR116311](#) for the front damper.