

**400 Series**  
**Engine & Equipment**  
**Model**  
**6.466T**

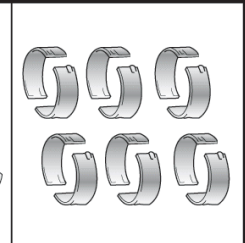
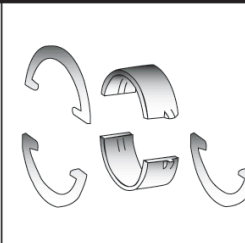
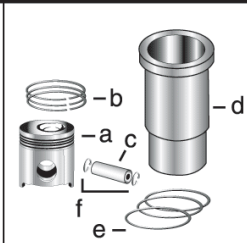

**1) Engine O/H Kit**      **Piston-Liner Kit**      **Main Bearing**      **Thrust Bearing**      **Con Rod Bearing**

253,373 >

**6.466A**

**2) Engine I/F Kit**

317,859 >

**1) [TRG18847](#)**  
**2) [TIK18847](#)**

6 Cyl

**TAR100646**  
 Consists of:  
 a) [TAR100616](#)  
 b) [TRE48380](#)  
 c) [TR57771](#)  
 d) [TAR63060](#)  
 e) [TAR98850](#)  
 f) [TE1343FN](#)

Bore: 4.56 in  
 116 mm  
 Pin Ø: 1.85 in  
 47 mm

**TAR74814** Std.  
**TAR74816** .010  
**TAR74817** .020  
**TAR74818** .030  
**Use 6**

**TAR77748** Std.  
**TAR77750** .010  
**TAR77751** .020  
**TAR77752** .030  
**Use 1**

**Thrust Washer**  
**TAR77747** Std.  
**TAR77753** .007  
**Use 3, Order Qty 1**

**TAR73277** Std.  
**TAR73279** .010  
**TAR73280** .020  
**TAR73281** .030  
**Use 6**

**Con Rod (m):**  
 R71074 (P/N AR93341)

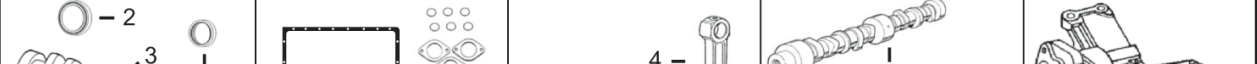

**APPLICATIONS:**

**1) Front Seal**  
**2) Rear Seal**

**1) O/H Gasket Set**

**1) Bush, Con Rod**  
**2) Bolt, Con Rod**  
**3) Bushing, Cam**

1) Cam Follower  
 2) Oil Cooler  
 3) Camshaft Kit  
 4) Plug, Camshaft  
 5) O'ring, Oil Cooler  
 6) Head Bolt Kit

1) Pump, Oil  
 2) Repair Kit

**AGRICULTURAL**

3) Crankshaft  
 4) Crankshaft, Gear  
 5) Ring Gear  
 6) Rear Gear

2) Head Gasket Set  
 3) Head Gasket  
 4) Oil Pan Gasket

4) Con Rod

- 4250 5730
- 4440 6602
- 4450 6620
- 4640 6622
- 4650 7720
- 5460 9940
- 5720 9950

- 1) [TAR49025](#)
  - 2) [TRE520036](#)
  - 3) [TRE53422](#) (6)
  - 4) [TR26049](#) (23T)
  - 5) [TR28811](#) (129T)
  - 6) [TR63326](#)
- 1) [TAR98845](#)
  - 2) [TAR98851](#)
  - 3) [TRE47336](#)
  - 4) [TR71918](#)
- 1) [TR74008](#) x6
  - 2) [TR66452](#) x12
  - 3) [TR46903](#) x4
  - 4) [TAR93341](#) x1
-  (1)
- 1) [TR52773](#)
  - 2) [TAT25038](#) (5)
  - 3) [TAR100385](#)
  - 4) [TR26115](#)
  - 5) [TR47153](#)
  - 6) [TMX365](#) (3)\*  
[TMX366](#) (4)\*\*
- 1) [TRE60622](#)
  - 2) [TMX1062](#) (2)

**CONSTRUCTION**

1) Valve, Intake      Valve, Exhaust      Insert, Valve  
 1) Intake      2) Exhaust

- 644C 790D
- 690C 850B
- 762A/B 892D
- 770A/B

1) Cap, Valve  
 2) Lock, Valve

1) Spring, Valve  
 2) Rotator, Valve  
 3) O'ring, Valve



[TR50358](#) Std.  
[TR55055](#) .003  
[TR55057](#) .015

[TR50357](#) Std.  
[TR55056](#) .003  
[TR55058](#) .015

1) [TR78702](#) Std.  
 2) [TR50356](#) Std.

1) [TT20129](#)  
 2) [TT20077](#)

1) [TR26125](#)  
 2) [TRE11410](#)  
 3) [TR87627](#)

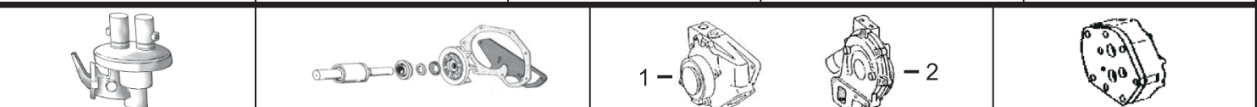

**Thermostat**

**Fuel Transfer Pump**

**Water Pump Rep Kit**  
 a) Without Impeller  
 b) With Impeller

**Water Pump**

**Pump, Oil, Quad Transmission**

[TAR48675](#) 180° F

Not Used

See Chart

1) [TRE55985](#) (m) R71224, (m) R83561  
 2) [TRE20022](#) (OEM ESN 067685 >)

[TRE20918](#)  
 For Tractors  
 4250, 4040, 4450, 4640, 4650

(1) Shape, Conrod Bushing.  
 (2) For Crankshaft driven Engine Pump, Oil Consists of: Shaft, Gears, and Gaskets.  
 (3) [TMX365](#) Consists of: [TR88042](#) x6, [TR88043](#) x5, [TR88044](#) x8, [TR88045](#) x7. \* With ESN > 317676.  
 (4) [TMX366](#) Consists of: [TR88043](#) x11, [TR88044](#) x8, [TR88045](#) x7. \*\* With ESN 317677 >.  
 (5) Some applications use [TAR55394](#).  
 (6) [TRE53422](#) will require front key [TR116311](#) for the front damper.