

300 Series

Engine & Equipment Model

4039T

Liter Designated

4 Cyl

Bore: 4.19 in
106.5 mm
Pin Ø: 1.625 in
41 mm

Con Rod (m):

R80032, R122191,
R113612

APPLICATIONS:

AGRICULTURAL

5500N 6300
5700 6300L
6200 SE6200
6200L SE6300

CONSTRUCTION

300D (Turbo)
310C (Turbo)
315C/D (Turbo)
515B

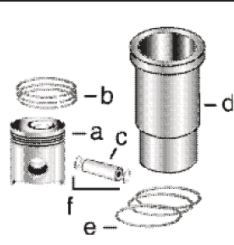

1) Engine O/H Kit	Piston-Liner Kit	Main Bearing	Thrust Bearing	Con Rod Bearing
-------------------	------------------	--------------	----------------	-----------------

2) Engine I/F Kit	TRE33115 Consists of:	TRE27352 Std.	TAT21139 Std.	TRE27348 Std.
-------------------	---------------------------------	----------------------	----------------------	----------------------

1) TRE54709	a) TRE19278	TRE27353 .010	TAT21132 .010	TRE27349 .010
	b) TRE66820	TRE27360 .020	TAT21134 .020	TRE27358 .020
2) TIK54709	c) TR124230	TRE27368 .030	TAT21136 .030	TRE27364 .030

Use 4

Use 1

Use 4

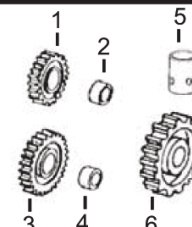
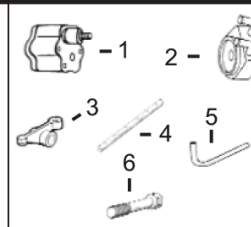
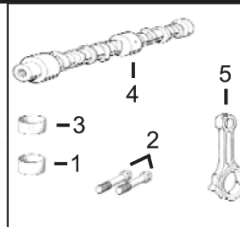
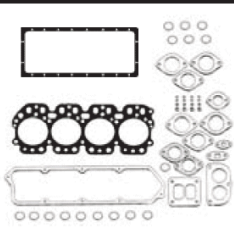
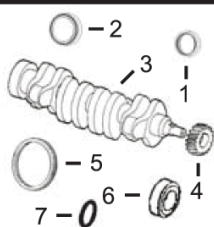

1) Front Seal 2) Rear Seal	1) O/H Gasket Set	1) Bush, Con Rod 2) Bolt, Con Rod 3) Bush, Bal. Shaft	1) Pump, Oil 2) Oil Cooler 3) Rocker Arm 4) Rocker Shaft 5) Pump, Oil Tube 6) Cyl Hd Cap Screw	1) Lower Gear 2) Lower Bushing 3) Upper Gear 4) Upper Bushing 5) Cam. Follower 6) Cam. Gear
-------------------------------	-------------------	---	---	--

3) Crankshaft 4) Crankshaft, Gear 5) Ring Gear 6) Sleeve, Front 7) Packing, Sleeve	2) Head Gasket Set 3) Head Gasket 4) Oil Pan Gasket 5) Rocker Cover Gsk	4) Camshaft 5) Con Rod	1) TRE55343 (3) 2) TRE31929 3) TRE31973 4) TR54987 5) TR113752 6) TR85363 x18 (1)	1) TAT24252 (6) 2) TT26321 3) TAT18009 4) TT20034 (6) 5) TT20073 6) TT20070 (6)
--	--	---------------------------	--	--

Valve, Intake	Valve, Exhaust	Insert, Valve 1) Intake 2) Exhaust	1) Seal, Valve 2) Lock, Valve	1) Spring, Valve 2) Rotator, Valve
TR98062 Std. TR97490 .015	TR90692 Std. TR97492 .015	1) TR98063 Std. TR98335 O/S 2) TR85687 Std. TR93910 O/S	1) TRE31617 2) TR91889	1) TR26125 2) TRE60005

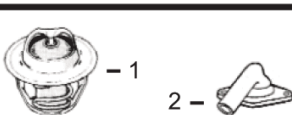

1) Thermostat
2) Thermostat Cover

1) **TAR48675** 180° F (5)
2) **TT23620**

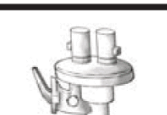

Fuel Transfer Pump

TRE42211
TRE38009 (7)

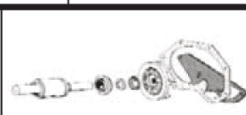

Water Pump Rep Kit
a) Without Impeller
b) With Impeller

See Chart

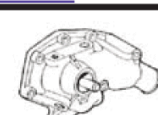

Water Pump

TAR97708 (m) R73604
TRE60489 (m) R100812, (m) R127337,
(m) R127918, (m) R55164,

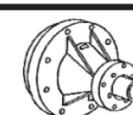

Water Pump

TRE41157

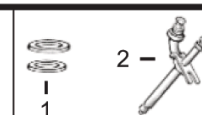

1) Seal, Injector
2) Injector, Pencil

1) **TR60746**
TR48000
2) **TRE38087**

(1) Replace all R78558 Cap Screws with Flanged Head Cap Screw **TR85363**.

(2) Saran engines, O'ring not included in Gasket Set. Order separately.

(3) May use High Capacity Pump, Oil **TRE65580**.

(4) **TR91708** (Outer Diam. 2.00 mm / 0.078 in) Larger and **TR57160R** (Inner Diam 0.5 mm / 0.020 in) Smaller, are also available.

(5) Saran Engines may use **TRE64354**.

(6) Helicoidal Gears.

(7) Saran Engines.

(8) Threaded Type. For Late 4039 models **TRE55901** Kit (Camshaft, and **TR119874** Bushing) is available.