

# PowerTech

## Engine & Equipment Model

# 4045T

4.5T  
4 Cyl

Bore: 4.19 in  
106.5 mm  
Pin Ø: 1.375 in  
35 mm

**Piston (m):**  
RE59277, RE505100 (1)

**Con Rod (m):**  
R123959, R500000

### APPLICATIONS:

#### AGRICULTURAL

3410/X 5510/N 5715  
4890 5520/N 5725  
4895 5525/N 6700  
5415 5615  
5425/N 5625/N

#### OEM

4.5L

#### CONSTRUCTION

230 LCR 344H  
310E (TURBO) 410E  
310G (TURBO) 410G  
310SE (TURBO) 410J  
310SG (TURBO) 450H  
315SE 550H  
315SG 650H



1) Engine O/H Kit      Piston-Liner Kit      Main Bearing      Thrust Bearing      Con Rod Bearing

2) Engine I/F Kit      **TRE507920** (RE515372)      **TRE65165** Std.      **TRE65168** Std.      **TRE65908** Std.

1) **TRE66093**      Consists of:      **TRE65911** .010      **TRE65912** .010      **TRE65909** .010  
**TRE66093A** (\*)      a) **TRE515372**      **TRE65165B** .020 (9)      **TRE65168B** .020 (9)      **TRE65908B** .020 (9)  
(\*) w/C. Rod R500000      b) **TRE66820**

2) **TIK66093**      c) **TR123178**      **Use 4**      **Use 1**      **Use 4**  
**TIK66093A** (\*)      d) **TR116383**  
(\*) w/C. Rod R500000      e) **TAR65507**

f) **TM41029**

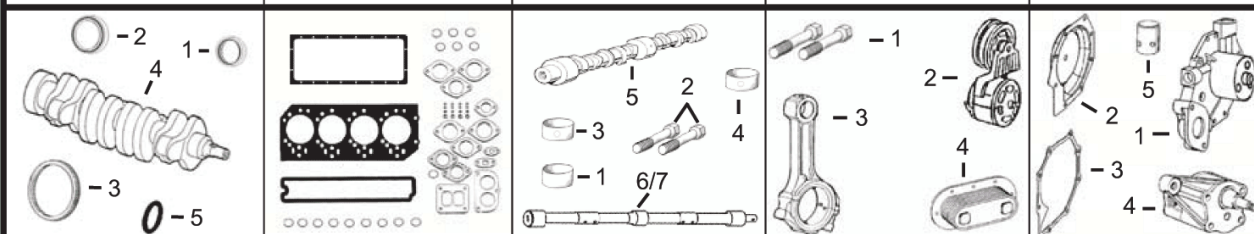

1) Front Seal      1) O/H Gasket Set      1) Bush, Con Rod      1) Cyl Hd Cap Screw      1) Water Pump  
2) Rear Seal      2) Head Gasket Set      2) Bolt, Con Rod      2) Tensioner, Belt      2) Water Pump Cov  
3) Ring Gear      3) Head Gasket      3) Bush, Bal. Shaft      3) Con Rod      3) Water Pump Gsk  
4) Crankshaft      4) Oil Pan Gasket      4) Bush, Camshaft      4) Oil Cooler      4) Pump, Oil  
5) Seal      5) Rocker Cover Gsk      5) Camshaft      5) Tappet

6) Bal. Shaft R/H      6) Bal. Shaft L/H

7) Bal. Shaft L/H

1) **TRE505515** (10)      1) **TRE501455**      1) **TR123960** x4      1) **TR85363** x18 (5)      1) **TRE500737** (Standard Flow)

2) **TRE44574**      2) **TRE66082**      2) **TR114083** x8 (2)      2) **TRE518097** (11)      2) **TRE500734** (High Flow)

3) **TR28811** (129T)      3) **TR116515**      3) **TR115299** x6      3) **TRE68715** (11)      3) **TRE500002**

or      4) **TR123352** (3)      4) **TR119874** x1      4) **TRE500002**      4) **TRE59296** (5 Plates)

**TR114282** (142T)      5) **TR97342** (4)      5) **TRE56375** (7)      5) **TRE500002**      5) **TRE59298** (9 Plates)

4) **TRE50618** (6)      6) **TR123353** (R123353)      6) **TRE500448**      6) **TRE500448**      6) **TRE500448**

5) **TH35244**      7) **TR123542**      7) **TRE500449**      7) **TRE500449**      7) **TRE500449**

Valve, Intake      Valve, Exhaust      Insert, Valve      1) Seal, Valve      1) Spring, Valve  
1) Intake      1) Intake      1) Intake      2) Lock, Valve      2) Rotator, Valve  
2) Exhaust      2) Exhaust      2) Exhaust

**TR98062** Std.      **TR90692** Std.      1) **TR98063** Std.      1) **TRE31617**      1) **TR26125**  
**TR97490** .015      **TR97492** .015      2) **TR98335** O/S      2) **TR91889**      2) **TRE60005**  
2) **TR85687** Std.      2) **TR93910** O/S      2) **TR85687** Std.      2) **TR91889**      2) **TRE60005**  
2) **TR93910** O/S

Thermostat      Injector, Pencil      Seal, Injector      Fuel Transfer Pump

**TRE522076** 180° F (11)      **TRE60062** (Non Turbo)      **TR92352**      **TRE68345**  
**TRE528652** 180° F (11)      **TRE48786** (Turbo)      **TR48000**      or  
**TRE540550** 180° F (11)      **TRE531436** (12)      **TRE66153** (8)  
**TRE64354** 180° F (11)

(1) These marking numbers RE59277, RE505100 require to use Ring Set **TRE66271**.  
(2) Use **TR114083** with Machine Split Con Rods, and use **TR501124** with Fractured Split Con Rods.  
(3) Use with Oil Pan code 1901, 1902 & 1903, for Steel Oil Pan.  
(4) Use with Oil Pan code 1904 & 1905, for Aluminum Oil Pan.  
(5) Replace all R78558 Cap Screws with Flanged Head Cap Screw **TR85363**.  
(6) Crankshaft (m) R113596. Not to be used with applications requiring speed sensor gear.  
(7) (m) R135439, R132324, R134213.  
(8) Line Connections are both threaded.  
(9) Proper bearing journal radius must be maintained during the machining of the crankshaft to ensure proper operation.  
(10) 1 Piece Unitized Seal and Wearsleeve; Replaces **TRE59810**, RE538097.  
(11) Check application for proper usage.  
(12) Use with Stanadyne DE10 Injection Pump.