

**PowerTech**  
**Engine & Equipment**  
**Model**

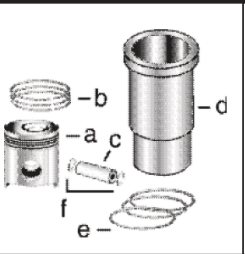

**4045T/H**

4.5T/H

4 Cyl

Bore: 4.19 in  
 106.5 mm  
 Pin Ø: 1.62 in  
 41 mm

**Piston (m):**  
 RE55512, RE505102

**Con Rod (m):**  
 R114081, R500335

**APPLICATIONS:**

**AGRICULTURAL**  
 6010 6410/L/S  
 6110/L 6510L  
 6210/L 6610S  
 6310/L/S 6605  
 6405 6610

**OEM**  
 4.5L

**CONSTRUCTION**  
 120 550H  
 444H/HCL 550G  
 TC444H 555G  
 450G 650G  
 455G

**1) Engine O/H Kit**

**Piston-Liner Kit**

**Main Bearing**

**Thrust Bearing**

**Con Rod Bearing**

**2) Engine I/F Kit**

**TRE507850 (RE505112)**

**TRE65165 Std.**

**TRE65168 Std.**

**TRE65908 Std.**

**1) TRE66094 TRE66094A (\*)**  
 (\*) w/C. Rod R500335

Consists of:

**TRE65911 .010**

**TRE65912 .010**

**TRE65909 .010**

**2) TIK66094 TIK66094A (\*)**  
 (\*) w/C. Rod R500335

- a) **TRE55512**
- b) **TRE66820**
- c) **TR123177**
- d) **TR116383**
- e) **TAR65507**
- f) **TR54114**

**TRE65165B .020 (9)**

**TRE65168B .020 (9)**

**TRE65908B .020 (9)**

**Use 4**

**Use 1**

**Use 4**

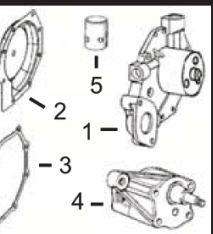
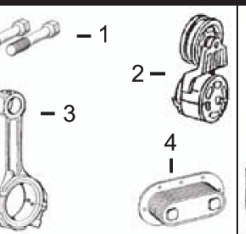
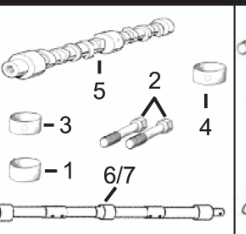
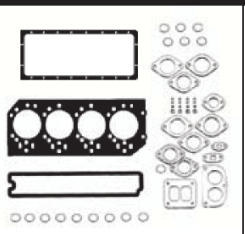
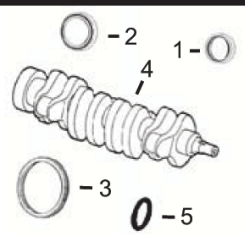

**1) Front Seal**  
**2) Rear Seal**

**1) O/H Gasket Set**

**1) Bush, Con Rod**  
**2) Bolt, Con Rod**  
**3) Bush, Bal. Shaft**  
**4) Bush, Camshaft**

**1) Cyl Hd Cap Screw**  
**2) Tensioner, Belt**  
**3) Con Rod**  
**4) Oil Cooler**

**1) Water Pump**  
**2) Water Pump Cov**  
**3) Water Pump Gsk**  
**4) Pump, Oil**  
**5) Tappet**

**3) Ring Gear**

**2) Head Gasket Set**

**5) Camshaft**

**4) Crankshaft**

**3) Head Gasket**

**6) Bal. Shaft R/H**

**5) Seal**

**4) Oil Pan Gasket**

**7) Bal. Shaft L/H**

- 1) **TRE505515 (8)**
- 2) **TRE44574**
- 3) **TR28811 (129T)**  
 or  
**TR114282 (142T)**
- 4) **TRE50618 (5)**
- 5) **TH35244**

- 1) **TRE501455**
- 2) **TRE66082**
- 3) **TR116515**
- 4) **TR123352 (2)**  
**TR97342 (3)**  
 (R123353)
- 5) **TR123542**

- 1) **TR114082 x4**
- 2) **TR114083 x8 (1)**  
**TR501124 x8 (1)**
- 3) **TR115299 x6**
- 4) **TR119874 x1**
- 5) **TRE56375 (6)**
- 6) **TRE500448**
- 7) **TRE500449**

- 1) **TR85363 x18 (4)**
- 2) **TRE518097 (10)**  
**TRE68715 (10)**
- 3) **TRE500608**
- 4) **TRE59296 (5 Plates)**  
**TRE56690 (7 Plates)**  
**TRE59298 (9 Plates)**

- 1) **TRE500737 (Standard Flow)**  
**TRE500734 (High Flow)**
- 2) **TRE508566**
- 3) **TR123417**
- 4) **TRE504914**
- 5) **TR123565 x8**

Valve, Intake

Valve, Exhaust

Insert, Valve  
 1) Intake  
 2) Exhaust

1) Seal, Valve  
 2) Lock, Valve

1) Spring, Valve  
 2) Rotator, Valve

**TR98062 Std.**  
**TR97490 .015**

**TR90692 Std.**  
**TR97492 .015**

1) **TR98063 Std.**  
**TR98335 O/S**  
 2) **TR85687 Std.**  
**TR93910 O/S**

1) **TRE31617**  
 2) **TR91889**

1) **TR26125**  
 2) **TRE60005**

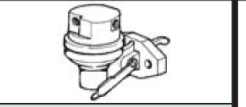

- (4) Replace all R78558 Cap Screws with Flanged Head Cap Screw **TR85363**.
- (5) Crankshaft (m) R113596. Not to be used with applications requiring speed sensor gear.
- (6) (m) R135439, R132324, R134213.
- (7) Line Connections are both threaded.
- (8) 1 Piece Unitized Seal and Wearsleeve; Replaces TRE59810, RE538097.
- (9) Proper bearing journal radius must be maintained during the machining of the crankshaft to ensure proper operation.
- (10) Check application for proper usage.
- (11) Use with Stanadyne DE10 Injection Pump.

**Thermostat**  
**TRE522076 180° F (10)**  
**TRE528652 180° F (10)**  
**TRE540550 180° F (10)**  
**TRE64354 180° F (10)**

**Injector, Pencil**  
**TRE60062 (Non Turbo)**  
**TRE48786 (Turbo)**  
**TRE531436 (11)**

**Seal, Injector**  
**TR92352**  
**TR48000**

**Fuel Transfer Pump**  
**TRE68345**  
 or  
**TRE66153 (7)**

(1) Use **TR114083** Rod Bolts with Machine Split Connecting Rods, and use **TR501124** Rod Bolts with Fractured Split Connecting Rods.  
 (2) Use with Oil Pan code 1901, 1902 & 1903, for Steel Oil Pan.  
 (3) Use with Oil Pan code 1904 & 1905, for Aluminum Oil Pan.