

PowerTech
Engine & Equipment
Model

4045T/H

4.5T/H

4 Cyl

Bore: 4.19 in
 106.5 mm
 Pin Ø: 1.62 in
 41 mm

Piston (m):
 RE55512, RE505102

Con Rod (m):
 R114081, R500335

APPLICATIONS:

AGRICULTURAL
 6010 6410/L/S
 6110/L 6510L
 6210/L 6610S
 6310/L/S 6605
 6405 6610

OEM
 4.5L

CONSTRUCTION
 120 550H
 444H/HCL 550G
 TC444H 555G
 450G 650G
 455G

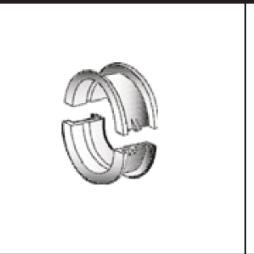
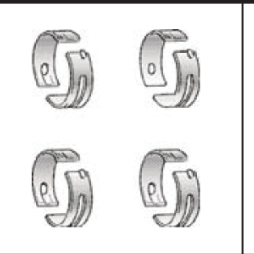
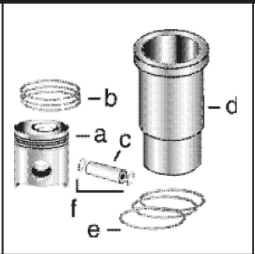

1) Engine O/H Kit **Piston-Liner Kit** **Main Bearing** **Thrust Bearing** **Con Rod Bearing**

2) Engine I/F Kit **TRE507850 (RE505112)** **TRE65165 Std.** **TRE65168 Std.** **TRE65908 Std.**

1) TRE66094 **Consists of:** **TRE65911 .010** **TRE65912 .010** **TRE65909 .010**
TRE66094A (*) **a) TRE55512** **TRE65165B .020 (9)** **TRE65168B .020 (9)** **TRE65908B .020 (9)**
 (*) w/C. Rod R500335 **b) TRE66820**

2) TIK66094 **c) TR123177** **Use 4** **Use 1** **Use 4**
TIK66094A (*) **d) TR116383**
 (*) w/C. Rod R500335 **e) TAR65507**
f) TR54114

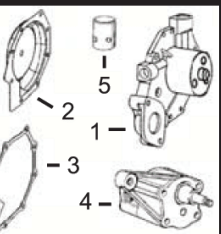
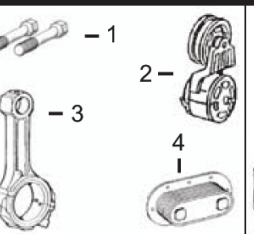
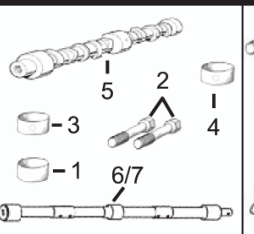
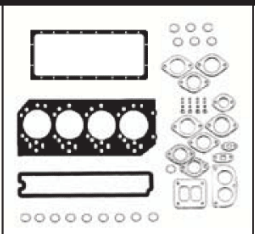
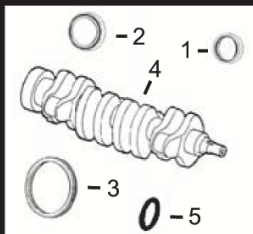

1) Front Seal **1) O/H Gasket Set** **1) Bush, Con Rod** **1) Cyl Hd Cap Screw** **1) Water Pump**
2) Rear Seal **2) Head Gasket Set** **2) Bolt, Con Rod** **2) Tensioner, Belt** **2) Water Pump Cov**
3) Ring Gear **3) Head Gasket** **3) Bush, Bal. Shaft** **3) Con Rod** **3) Water Pump Gsk**
4) Crankshaft **4) Oil Pan Gasket** **4) Bush, Camshaft** **4) Oil Cooler** **4) Pump, Oil**
5) Seal **5) Rocker Cover Gsk** **5) Camshaft** **5) Tappet**

1) TRE505515 (8) **1) TRE501455** **1) TR114082 x4** **1) TR85363 x18 (4)** **1) TRE500737 (Standard Flow)**
2) TRE44574 **2) TRE66082** **2) TR114083 x8 (1)** **2) TRE518097 (10)** **TRE500734 (High Flow)**
3) TR28811 (129T) **3) TR116515** **TR501124 x8 (1)** **TRE68715 (10)**
 or **4) TR123352 (2)** **3) TR115299 x6** **3) TRE500608**
TR114282 (142T) **TR97342 (3)** **4) TR119874 x1** **4) TRE59296 (5 Plates)**
4) TRE50618 (5) **(R123353)** **5) TRE56375 (6)** **TRE56690 (7 Plates)**
5) TH35244 **5) TR123542** **6) TRE500448** **TRE59298 (9 Plates)**
7) TRE500449

Valve, Intake

Valve, Exhaust

Insert, Valve
 1) Intake
 2) Exhaust

1) Seal, Valve
 2) Lock, Valve

1) Spring, Valve
 2) Rotator, Valve

TR98062 Std.
TR97490 .015

TR90692 Std.
TR97492 .015

1) TR98063 Std.
TR98335 O/S
2) TR85687 Std.
TR93910 O/S

1) TRE31617
2) TR91889

1) TR26125
2) TRE60005

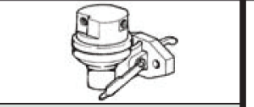

(4) Replace all R78558 Cap Screws with Flanged Head Cap Screw TR85363.
(5) Crankshaft (m) R113596. Not to be used with applications requiring speed sensor gear.
(6) (m) R135439, R132324, R134213.
(7) Line Connections are both threaded.
(8) 1 Piece Unitized Seal and Wearsleeve; Replaces TRE59810, RE538097.
(9) Proper bearing journal radius must be maintained during the machining of the crankshaft to ensure proper operation.
(10) Check application for proper usage.
(11) Use with Stanadyne DE10 Injection Pump.

Thermostat
TRE522076 180° F (10)
TRE528652 180° F (10)
TRE540550 180° F (10)
TRE64354 180° F (10)

Injector, Pencil
TRE60062 (Non Turbo)
TRE48786 (Turbo)
TRE531436 (11)

Seal, Injector
TR92352
TR48000

Fuel Transfer Pump
TRE68345
 or
TRE66153 (7)

(1) Use TR114083 Rod Bolts with Machine Split Connecting Rods, and use TR501124 Rod Bolts with Fractured Split Connecting Rods.
(2) Use with Oil Pan code 1901, 1902 & 1903, for Steel Oil Pan.
(3) Use with Oil Pan code 1904 & 1905, for Aluminum Oil Pan.