

300 Series
Engine & Equipment
Model

4045T

Liter Designated

4 Cyl

Bore: 4.19 in
 106.5 mm
 Pin Ø: 1.625 in
 41 mm

APPLICATIONS:
AGRICULTURAL
 6400 6500L
 6400L 6700
 6500 SE6400

CONSTRUCTION
 340D 510C
 344G 510D
 410C/D (T) 540D
 440C 548D
 444E/G 550/A/B/G
 448D 555/A/B/G
 450E/G 590D
 455E/G 595D
 490E 610B/C
 495D 650G

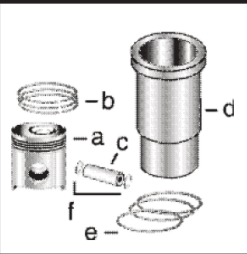

1) Engine O/H Kit

Piston-Liner Kit

Main Bearing

Thrust Bearing

Con Rod Bearing

2) Engine I/F Kit

TRE53073
 Consists of:

TRE27352 Std.

TAT21139 Std.

TAR97517 Std.

1) **TRE61612**

a) **TRE48469**

TRE27353 .010

TAT21132 .010

TAR97653 .010

2) **TIK61612**

b) **TRE66820**

TRE27360 .020

TAT21134 .020

TAR97654 .020

c) **TR124230**

TRE27368 .030

TAT21136 .030

TAR97655 .030

d) **TR80500**

Use 4

Use 1

Use 4

e) **TAR65507**

f) **TR54114**

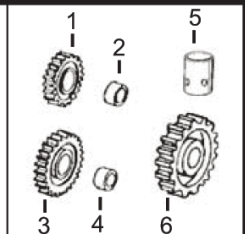
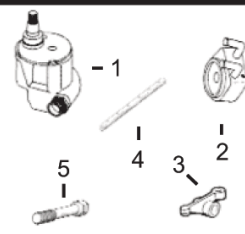
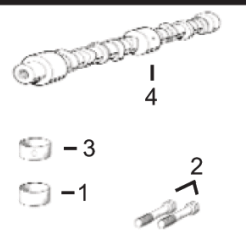
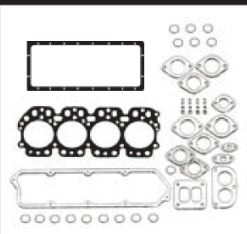
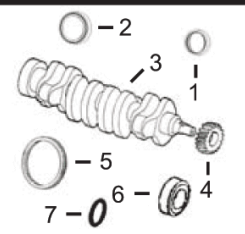

1) Front Seal
 2) Rear Seal

1) O/H Gasket Set

1) Bush, Con Rod
 2) Bolt, Con Rod
 3) Bush, Bal. Shaft

1) Pump, Oil
 2) Oil Cooler
 3) Rocker Arm
 4) Rocker Shaft
 5) Cyl Hd Cap Screw

1) Lower Gear
 2) Lower Bushing
 3) Upper Gear
 4) Upper Bushing
 5) Cam. Follower
 6) Cam. Gear

3) Crankshaft
 4) Crankshaft, Gear
 5) Ring Gear
 6) Sleeve, Front
 7) Packing, Sleeve

2) Head Gasket Set
 3) Head Gasket
 4) Oil Pan Gasket
 5) Rocker Cover Gsk

4) Camshaft

1) **TAR67942**
 2) **TRE44574**
 3) **TRE56792** (*)
 4) **TT20094**
 5) **TR28811** (129T)
 or
TR114282 (142T)
 6) **TR81989**
 7) **TH35244**

1) **TRE501568**
 2) **TRE38851**
 3) **TR125863**
 4) **TR97342**
 5) **TR73521**

1) **TR57451** x4
 2) **TR74195** x8 (7)
 3) **TR57160** x6
 4) **TR82820** (4)

1) **TRE65580** (1)
 2) **TRE31929** (6)
 3) **TRE31973**
 4) **TR54987**
 5) **TR85363** x18 (5)

1) **TAT24252**
 2) **TT26321**
 3) **TAT18009**
 4) **TT20034**
 5) **TT20073**
 6) **TT20070**

Valve, Intake

Valve, Exhaust

Insert, Valve
 1) Intake
 2) Exhaust

1) Seal, Valve
 2) Lock, Valve

1) Spring, Valve
 2) Rotator, Valve

TR98062 Std.
TR97490 .015

TR90692 Std.
TR97492 .015

1) **TR98063** Std.
TR98335 O/S.
 2) **TR85687** Std.
TR93910 O/S.

1) **TRE31617**
 2) **TR91889**

1) **TR26125**
 2) **TRE60005**

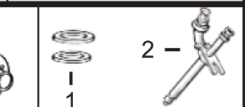
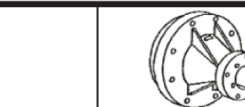
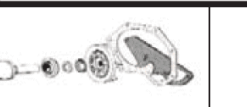
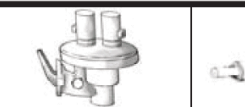

1) Thermostat
 2) Thermostat Cover

Fuel Transfer Pump

Water Pump Rep Kit
 a) Without Impeller
 b) With Impeller

Water Pump

1) Seal, Injector
 2) Injector, Pencil

1) **TAR48675** 180° F (2)
 2) **TT23260**

TRE42211
TRE38009 (3)
 See Chart

TAR97708 (m) R73604
TRE60489 (m) R100812, (m) R127337,
 (m) R127918, (m) R55164

TRE41157

1) **TR60746**
TR48000
 2) **TRE38087**

(*) Crankshaft (m) R54501. This Engines model may also use crankshaft **TRE54883** 60mm Snout; (m) R90825, R120009. PLEASE VERIFY.
 (1) Saran engines use **TRE55343** Standard flow.
 (2) Saran engines may use **TRE64354**.
 (3) Saran engines
 (4) Threaded Type. For Late 4039 models **TRE55901** Kit (Camshaft, Tappets and **TR119874** Bushing) is available.
 (5) Replace all R78558 Cap Screws with Flanged Head Cap Screw **TR85363**.
 (6) Always verify Oil Cooler Type.
 (7) When used on connecting rods marked R56187, torque bolts to 95 ft.lbs.