

**PowerTech**  
**Engine & Equipment**  
**Model**

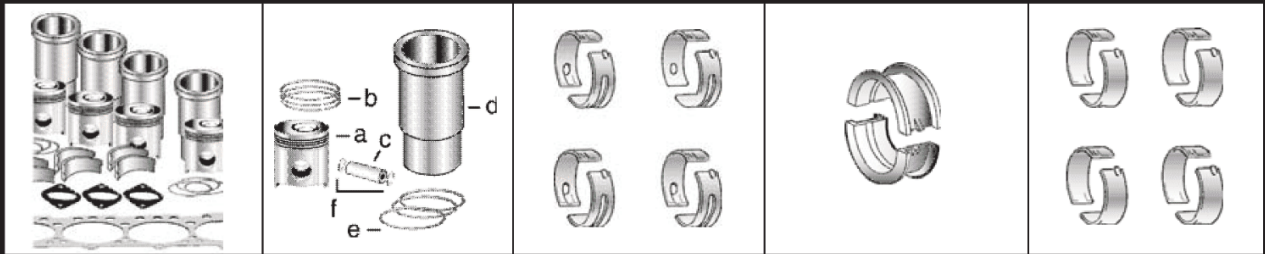

**1) Engine O/H Kit**      **Piston-Liner Kit**      **Main Bearing**      **Thrust Bearing**      **Con Rod Bearing**

**2) Engine I/F Kit**      **TRE507850 (RE505112)**      **TRE65165 Std.**      **TRE65168 Std.**      **TRE65908 Std.**

**1) TRE66094**      **Consists of:**      **TRE65911 .010**      **TRE65912 .010**      **TRE65909 .010**  
**TRE66094A (\*)**      **a) TRE55512**      **TRE65165B .020 (9)**      **TRE65168B .020 (9)**      **TRE65908B .020 (9)**  
 (\*) w/C. Rod R500335      **b) TRE66820**

**2) TIK66094**      **c) TR123177**      **Use 4**      **Use 1**      **Use 4**  
**TIK66094A (\*)**      **d) TR116383**  
 (\*) w/C. Rod R500335      **e) TAR65507**  
**f) TR54114**

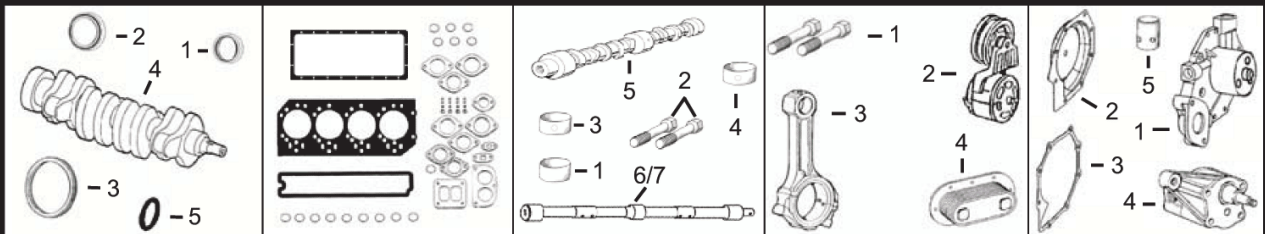

**1) Front Seal**      **1) O/H Gasket Set**      **1) Bush, Con Rod**      **1) Cyl Hd Cap Screw**      **1) Water Pump**  
**2) Rear Seal**      **2) Head Gasket Set**      **2) Bolt, Con Rod**      **2) Tensioner, Belt**      **2) Water Pump Cov**  
**3) Ring Gear**      **3) Head Gasket**      **3) Bush, Bal. Shaft**      **3) Con Rod**      **3) Water Pump Gsk**  
**4) Crankshaft**      **4) Oil Pan Gasket**      **4) Bush, Camshaft**      **4) Oil Cooler**      **4) Pump, Oil**  
**5) Seal**      **5) Rocker Cover Gsk**      **5) Camshaft**      **5) Tappet**

**1) TRE505515 (8)**      **1) TRE501455**      **1) TR114082 x4**      **1) TR85363 x18 (4)**      **1) TRE500737 (Standard Flow)**  
**2) TRE44574**      **2) TRE66082**      **2) TR114083 x8 (1)**      **2) TRE518097 (10)**      **TRE500734 (High Flow)**  
**3) TR28811 (129T)**      **3) TR116515**      **TR501124 x8 (1)**      **TRE68715 (10)**  
 or      **4) TR123352 (2)**      **3) TR115299 x6**      **3) TRE500608**  
**TR114282 (142T)**      **TR97342 (3)**      **4) TR119874 x1**      **4) TRE59296 (5 Plates)**  
**4) TRE50618 (5)**      **(R123353)**      **5) TRE56375 (6)**      **TRE56690 (7 Plates)**  
**5) TH35244**      **5) TR123542**      **6) TRE500448**      **TRE59298 (9 Plates)**  
**7) TRE500449**

**1) TRE505515 (8)**      **1) TRE501455**      **1) TR114082 x4**      **1) TR85363 x18 (4)**      **1) TRE500737 (Standard Flow)**  
**2) TRE44574**      **2) TRE66082**      **2) TR114083 x8 (1)**      **2) TRE518097 (10)**      **TRE500734 (High Flow)**  
**3) TR28811 (129T)**      **3) TR116515**      **TR501124 x8 (1)**      **TRE68715 (10)**  
 or      **4) TR123352 (2)**      **3) TR115299 x6**      **3) TRE500608**  
**TR114282 (142T)**      **TR97342 (3)**      **4) TR119874 x1**      **4) TRE59296 (5 Plates)**  
**4) TRE50618 (5)**      **(R123353)**      **5) TRE56375 (6)**      **TRE56690 (7 Plates)**  
**5) TH35244**      **5) TR123542**      **6) TRE500448**      **TRE59298 (9 Plates)**  
**7) TRE500449**

**Valve, Intake**      **Valve, Exhaust**      **Insert, Valve**      **1) Seal, Valve**      **1) Spring, Valve**  
**1) Intake**      **1) Exhaust**      **1) Intake**      **2) Lock, Valve**      **2) Rotator, Valve**  
**2) Exhaust**

**TR98062 Std.**      **TR90692 Std.**      **1) TR98063 Std.**      **1) TRE31617**      **1) TR26125**  
**TR97490 .015**      **TR97492 .015**      **TR98335 O/S**      **2) TR91889**      **2) TRE60005**  
**2) TR85687 Std.**      **2) TR93910 O/S**

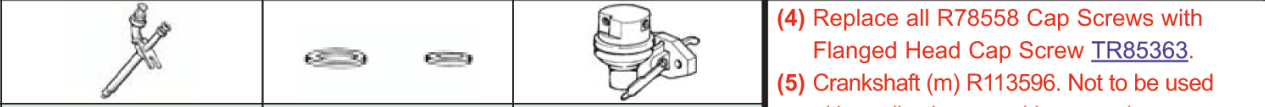

**Thermostat**      **Injector, Pencil**      **Seal, Injector**      **Fuel Transfer Pump**

**TRE522076 180° F (10)**      **TRE60062 (Non Turbo)**      **TR92352**      **TRE68345**  
**TRE528652 180° F (10)**      **TRE48786 (Turbo)**      **TR48000**      **or**  
**TRE540550 180° F (10)**      **TRE531436 (11)**      **TRE66153 (7)**

**4045T/H**  
**4.5T/H**  
**4 Cyl**  
 Bore: 4.19 in  
 106.5 mm  
 Pin Ø: 1.62 in  
 41 mm  
**Piston (m):**  
 RE55512, RE505102  
**Con Rod (m):**  
 R114081, R500335

**APPLICATIONS:**  
**AGRICULTURAL**  
 6010      6410/L/S  
 6110/L      6510L  
 6210/L      6610S  
 6310/L/S      6605  
 6405      6610  
**OEM**  
 4.5L  
**CONSTRUCTION**  
 120      550H  
 444H/HCL      550G  
 TC444H      555G  
 450G      650G  
 455G

(1) Use TR114083 Rod Bolts with Machine Split Connecting Rods, and use TR501124 Rod Bolts with Fractured Split Connecting Rods.  
 (2) Use with Oil Pan code 1901, 1902 & 1903, for Steel Oil Pan.  
 (3) Use with Oil Pan code 1904 & 1905, for Aluminum Oil Pan.  
 (4) Replace all R78558 Cap Screws with Flanged Head Cap Screw TR85363.  
 (5) Crankshaft (m) R113596. Not to be used with applications requiring speed sensor gear.  
 (6) (m) R135439, R132324, R134213.  
 (7) Line Connections are both threaded.  
 (8) 1 Piece Unitized Seal and Wearsleeve; Replaces TRE59810, RE538097.  
 (9) Proper bearing journal radius must be maintained during the machining of the crankshaft to ensure proper operation.  
 (10) Check application for proper usage.  
 (11) Use with Stanadyne DE10 Injection Pump.