

**PowerTech**  
**Engine & Equipment**  
**Model**



**1) Engine O/H Kit**      **Piston-Liner Kit**      **Main Bearing**      **Thrust Bearing**      **Con Rod Bearing**

**2) Engine I/F Kit**      **TRE507850 (RE505112)**      **TRE65165 Std.**      **TRE65168 Std.**      **TRE65908 Std.**

**1) TRE66094**      **Consists of:**      **TRE65911 .010**      **TRE65912 .010**      **TRE65909 .010**  
**TRE66094A (\*)**      **a) TRE55512**      **TRE65165B .020 (9)**      **TRE65168B .020 (9)**      **TRE65908B .020 (9)**  
**(\*) w/C. Rod R500335**      **b) TRE66820**

**2) TIK66094**      **c) TR123177**      **Use 4**      **Use 1**      **Use 4**  
**TIK66094A (\*)**      **d) TR116383**  
**(\*) w/C. Rod R500335**      **e) TAR65507**  
**f) TR54114**

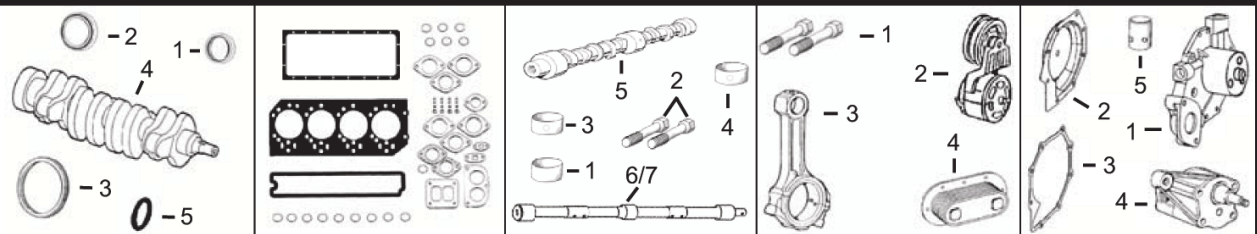

**1) Front Seal**      **1) O/H Gasket Set**      **1) Bush, Con Rod**      **1) Cyl Hd Cap Screw**      **1) Water Pump**  
**2) Rear Seal**      **2) Head Gasket Set**      **2) Bolt, Con Rod**      **2) Tensioner, Belt**      **2) Water Pump Cov**  
**3) Ring Gear**      **3) Head Gasket**      **3) Bush, Bal. Shaft**      **3) Con Rod**      **3) Water Pump Gsk**  
**4) Crankshaft**      **4) Oil Pan Gasket**      **4) Bush, Camshaft**      **4) Oil Cooler**      **4) Pump, Oil**  
**5) Seal**      **5) Rocker Cover Gsk**      **5) Camshaft**      **5) Tappet**

**1) TRE505515 (8)**      **1) TRE501455**      **1) TR114082 x4**      **1) TR85363 x18 (4)**      **1) TRE500737 (Standard Flow)**  
**2) TRE44574**      **2) TRE66082**      **2) TR114083 x8 (1)**      **2) TRE518097 (10)**      **TRE500734 (High Flow)**  
**3) TR28811 (129T)**      **3) TR116515**      **TR501124 x8 (1)**      **TRE68715 (10)**  
**or**      **4) TR123352 (2)**      **3) TR115299 x6**      **3) TRE500608**  
**TR114282 (142T)**      **TR97342 (3)**      **4) TR119874 x1**      **4) TRE59296 (5 Plates)**  
**4) TRE50618 (5)**      **(R123353)**      **5) TRE56375 (6)**      **TRE56690 (7 Plates)**  
**5) TH35244**      **5) TR123542**      **6) TRE500448**      **TRE59298 (9 Plates)**  
**7) TRE500449**

**Valve, Intake**      **Valve, Exhaust**      **Insert, Valve**      **1) Seal, Valve**  
**1) Intake**      **1) Intake**      **1) Intake**      **2) Lock, Valve**  
**2) Exhaust**      **2) Exhaust**      **2) Exhaust**  
**TR98062 Std.**      **TR90692 Std.**      **1) TR98063 Std.**      **1) TRE31617**  
**TR97490 .015**      **TR97492 .015**      **TR98335 O/S**      **2) TR91889**  
**2) TR85687 Std.**      **1) TR26125**  
**TR93910 O/S**      **2) TRE60005**

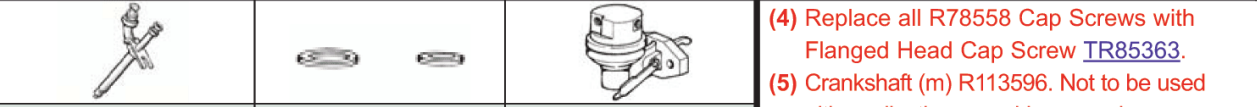

**Thermostat**      **Injector, Pencil**      **Seal, Injector**      **Fuel Transfer Pump**

**TRE522076 180° F (10)**      **TRE60062 (Non Turbo)**      **TR92352**      **TRE68345**  
**TRE528652 180° F (10)**      **TRE48786 (Turbo)**      **TR48000**      **or**  
**TRE540550 180° F (10)**      **TRE531436 (11)**      **TRE66153 (7)**

**(4) Replace all R78558 Cap Screws with Flanged Head Cap Screw TR85363.**  
**(5) Crankshaft (m) R113596. Not to be used with applications requiring speed sensor gear.**  
**(6) (m) R135439, R132324, R134213.**  
**(7) Line Connections are both threaded.**  
**(8) 1 Piece Unitized Seal and Wearsleeve; Replaces TRE59810, RE538097.**  
**(9) Proper bearing journal radius must be maintained during the machining of the crankshaft to ensure proper operation.**  
**(10) Check application for proper usage.**  
**(11) Use with Stanadyne DE10 Injection Pump.**

**4.5T/H**  
**4 Cyl**  
 Bore: 4.19 in  
 106.5 mm  
 Pin Ø: 1.62 in  
 41 mm

**Piston (m):**  
 RE55512, RE505102

**Con Rod (m):**  
 R114081, R500335

**APPLICATIONS:**

**AGRICULTURAL**  
 6010 6410/L/S  
 6110/L 6510L  
 6210/L 6610S  
 6310/L/S 6605  
 6405 6610

**OEM**  
 4.5L

**CONSTRUCTION**  
 120 550H  
 444H/HCL 550G  
 TC444H 555G  
 450G 650G  
 455G

**(1) Use TR114083 Rod Bolts with Machine Split Connecting Rods, and use TR501124 Rod Bolts with Fractured Split Connecting Rods.**  
**(2) Use with Oil Pan code 1901, 1902 & 1903, for Steel Oil Pan.**  
**(3) Use with Oil Pan code 1904 & 1905, for Aluminum Oil Pan.**