

**PowerTech**  
**Engine & Equipment**  
**Model**

**6068D**

6.8D

6 Cyl

Bore: 4.19 in  
 106.5 mm  
 Pin Ø: 1.375 in  
 35 mm

**Piston (m):**  
 RE59279, RE505101

**Con Rod (m):**  
 RE123959, R500000

**APPLICATIONS:**

**AGRICULTURAL**

6205 6515  
 6505 6520  
 6510 SE6520  
 SE6510

**OEM**

6.8L

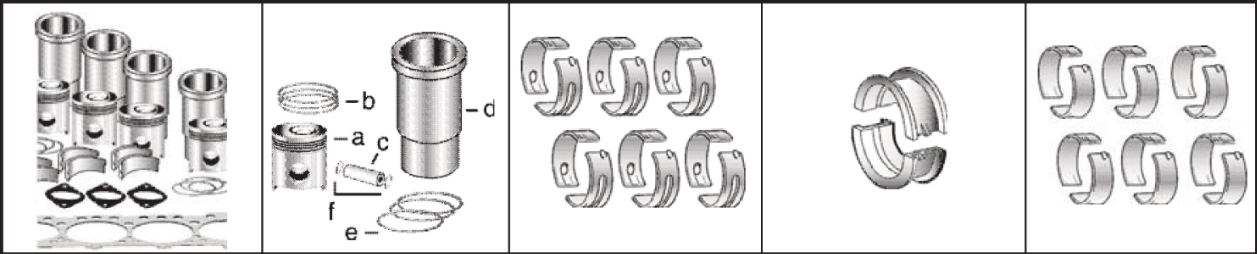

**1) Engine O/H Kit**      **Piston-Liner Kit**      **Main Bearing**      **Thrust Bearing**      **Con Rod Bearing**

**2) Engine I/F Kit**      **TRE65966 (RE505110)**      **TRE65165 Std.**      **TRE65168 Std.**      **TRE65908 Std.**

**1) TRE66095**      **Consists of:**      **TRE65911 .010**      **TRE65912 .010**      **TRE65909 .010**  
**TRE66095A (\*)**      **a) TRE59279**      **TRE65165B .020 (8)**      **TRE65168B .020 (8)**      **TRE65908B .020 (8)**  
 (\*) w/C. Rod R500000      **b) TRE66271**  
**2) TIK66095**      **c) TR123178**  
**TIK66095A (\*)**      **d) TR116383**  
 (\*) w/C. Rod R500000      **e) TAR65507**  
    **f) TM41029**

**Use 6**      **Use 1**      **Use 6**

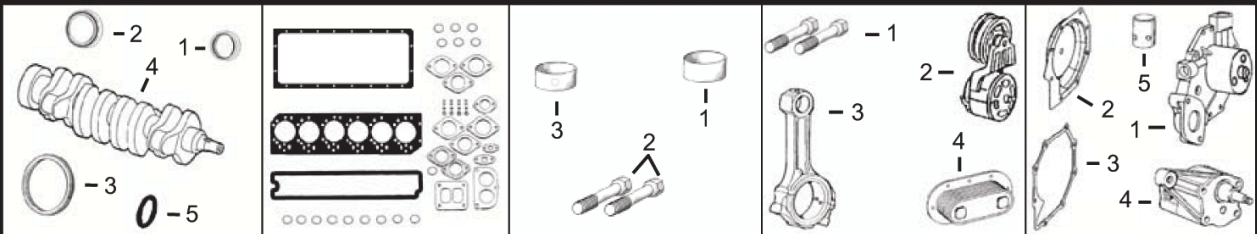

**1) Front Seal**      **1) O/H Gasket Set**      **1) Bush, Con Rod**      **1) Cyl Hd Cap Screw**      **1) Water Pump**  
**2) Rear Seal**      **2) Head Gasket Set**      **2) Bolt, Con Rod**      **2) Tensioner, Belt**      **2) Water Pump Cov**  
**3) Ring Gear**      **3) Head Gasket**      **3) Bushing, Cam**      **3) Con Rod**      **3) Water Pump Gsk**  
**4) Crankshaft**      **4) Oil Pan Gasket**      **4) Oil Cooler**      **4) Pump, Oil**      **4) Pump, Oil**  
**5) Seal**      **5) Rocker Cover Gsk**      **5) Tappet**

**1) TRE505515 (5)**      **1) TRE501456**      **1) TR123960 x6**      **1) TR85363 x18 (2)**      **1) TRE500737 (Standard Flow)**  
**2) TRE44574**      **2) TRE66085**      **2) TR114083 x12 (1)**      **2) TRE518097 (7)**      **TRE500734 (High Flow)**  
**3) TR28811 (129T)**      **3) TR116516**      **TR501124 x12 (1)**      **TRE68715 (7)**      **2) TRE508566**  
 or      **4) TR123354**      **3) TR119874 x1**      **TRE500002**      **3) TR123417**  
**4) TRE52850 (3)**      **5) TR123543**      **4) TRE59296 (5 Plates)**      **TRE56690 (7 Plates)**      **4) TRE504914**  
**5) TH35244**      **5) TR123565 x8**      **TRE59298 (9 Plates)**

**Valve, Intake**      **Valve, Exhaust**      **Insert, Valve**      **1) Seal, Valve**      **1) Spring, Valve**  
**1) Intake**      **1) Intake**      **1) Intake**      **2) Lock, Valve**      **2) Rotator, Valve**  
**2) Exhaust**      **2) Exhaust**      **2) Exhaust**      **1) TRE31617**      **1) TR26125**  
**1) TR98062 Std.**      **1) TR90692 Std.**      **1) TR98063 Std.**      **2) TR91889**      **2) TRE60005**  
**TR97490 .015**      **TR97492 .015**      **TR98335 O/S**      **1) TRE522076 180° F (7)**  
**2) TR85687 Std.**      **1) TRE60062 (Non Turbo)**      **TR93910 O/S**      **TRE528652 180° F (7)**  
**TR93910 O/S**      **TRE48786 (Turbo)**      **1) TRE540550 180° F (7)**  
**2) TRE64354 180° F (7)**      **TRE531436 (6)**      **TR92352**      **TRE68345**  
    **TR48000**      **TRE66153 (4)**

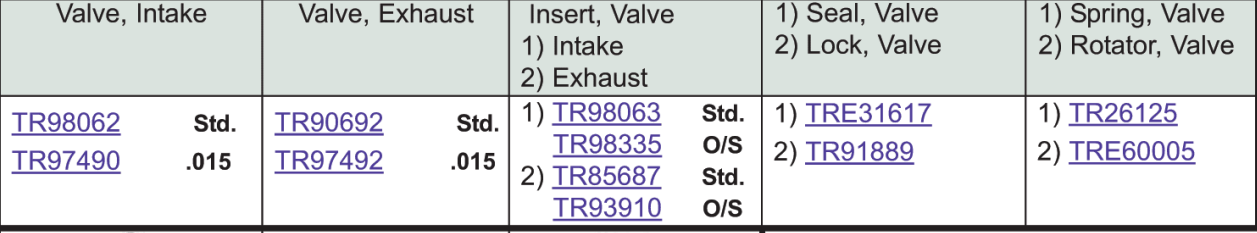

**Thermostat**      **Injector, Pencil**      **Seal, Injector**      **Fuel Transfer Pump**

**TRE522076 180° F (7)**      **TRE60062 (Non Turbo)**      **TR92352**      **TRE68345**  
**TRE528652 180° F (7)**      **TRE48786 (Turbo)**      **TR48000**      **or**  
**TRE540550 180° F (7)**      **TRE531436 (6)**      **TRE66153 (4)**

**(4) Line Connections are both threaded.**  
**(5) 1 Piece Unitized Seal and Wearsleeve; Replaces TRE59810, RE538097.**  
**(6) Use with Stanadyne DE10 Injection Pump.**  
**(7) Check application for proper usage.**  
**(8) Proper bearing journal radius must be maintained during the machining of the crankshaft to ensure proper operation.**

**(1) Use TR114083 Rod Bolts with Machine Split Connecting Rods, and use TR501124 Rod Bolts with Fractured Split Connecting Rods.**

**(2) Replace all R78558 Cap Screws with Flanged Head Cap Screw TR85363.**

**(3) Crankshaft (m) R116076, R502654.**