

PowerTech
Engine & Equipment
Model

6068D

6.8D

6 Cyl

Bore: 4.19 in
 106.5 mm
 Pin Ø: 1.375 in
 35 mm

Piston (m):
 RE59279, RE505101

Con Rod (m):
 RE123959, R500000

APPLICATIONS:

AGRICULTURAL

6205 6515
 6505 6520
 6510 SE6520
 SE6510

OEM

6.8L

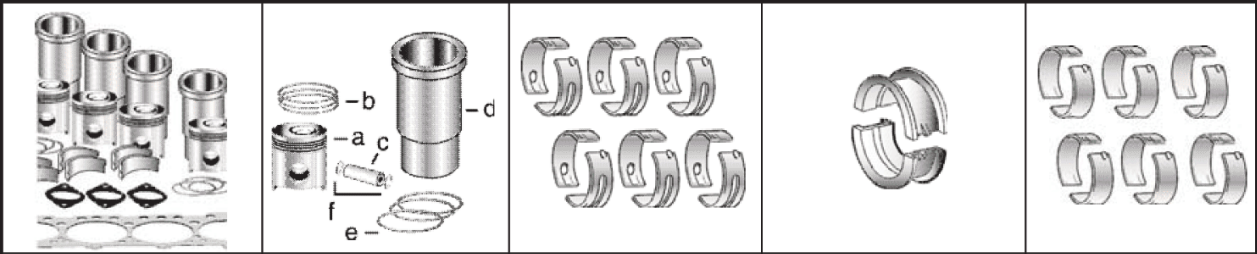

1) Engine O/H Kit Piston-Liner Kit Main Bearing Thrust Bearing Con Rod Bearing

2) Engine I/F Kit **TRE65966** (RE505110) **TRE65165** Std. **TRE65168** Std. **TRE65908** Std.

1) **TRE66095** Consists of: **TRE65911** .010 **TRE65912** .010 **TRE65909** .010
TRE66095A (*) a) **TRE59279** **TRE65165B** .020 (8) **TRE65168B** .020 (8) **TRE65908B** .020 (8)
 (*) w/C. Rod R500000 b) **TRE66271**

2) **TIK66095** c) **TR123178** **Use 6** **Use 1** **Use 6**
TIK66095A (*) d) **TR116383**
 (*) w/C. Rod R500000 e) **TAR65507**
 f) **TM41029**

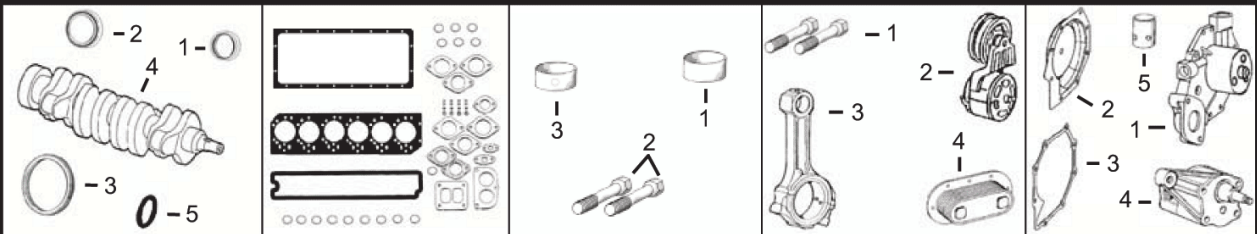

1) Front Seal 1) O/H Gasket Set 1) Bush, Con Rod 1) Cyl Hd Cap Screw 1) Water Pump
 2) Rear Seal 2) Head Gasket Set 2) Bolt, Con Rod 2) Tensioner, Belt 2) Water Pump Cov
 3) Ring Gear 3) Head Gasket 3) Bushing, Cam 3) Con Rod 3) Water Pump Gsk
 4) Crankshaft 4) Oil Pan Gasket 4) Oil Cooler 4) Pump, Oil 4) Pump, Oil
 5) Seal 5) Rocker Cover Gsk 5) Tappet

1) **TRE505515** (5) 1) **TRE501456** 1) **TR123960** x6 1) **TR85363** x18 (2) 1) **TRE500737**
 2) **TRE44574** 2) **TRE66085** 2) **TR114083** x12 (1) 2) **TRE518097** (7) (Standard Flow)
 3) **TR28811** (129T) 3) **TR116516** **TR501124** x12 (1) **TRE68715** (7) **TRE500734**
 or 4) **TR123354** 3) **TR119874** x1 **TRE500002** (High Flow)
TR114282 (142T) 5) **TR123543**

4) **TRE52850** (3) 2) **TRE52996** (5 Plates) 4) **TRE52996** (5 Plates) 2) **TRE508566**
 5) **TH35244** **TRE56690** (7 Plates) **TRE52998** (9 Plates) 3) **TR123417**
 4) **TRE504914**
 5) **TR123565** x8

Valve, Intake Valve, Exhaust Insert, Valve 1) Seal, Valve 1) Spring, Valve
 1) Intake 1) Intake 1) Intake 2) Lock, Valve 2) Rotator, Valve
 2) Exhaust 2) Exhaust

TR98062 Std. **TR90692** Std. 1) **TR98063** Std. 1) **TRE31617** 1) **TR26125**
TR97490 .015 **TR97492** .015 **TR98335** O/S 2) **TR91889** 2) **TRE60005**
 2) **TR85687** Std. 2) **TR85687** Std. **TR93910** O/S

Thermostat Injector, Pencil Seal, Injector Fuel Transfer Pump

TRE522076 180° F (7)
TRE528652 180° F (7)
TRE540550 180° F (7)
TRE64354 180° F (7)

TRE60062 (Non Turbo)
TRE48786 (Turbo)
TRE531436 (6)

TR92352
TR48000

TRE68345
 or
TRE66153 (4)

(4) Line Connections are both threaded.
 (5) 1 Piece Unitized Seal and Wearsleeve; Replaces TRE59810, RE538097.
 (6) Use with Stanadyne DE10 Injection Pump.
 (7) Check application for proper usage.
 (8) Proper bearing journal radius must be maintained during the machining of the crankshaft to ensure proper operation.

(1) Use **TR114083** Rod Bolts with Machine Split Connecting Rods, and use **TR501124** Rod Bolts with Fractured Split Connecting Rods.

(2) Replace all R78558 Cap Screws with Flanged Head Cap Screw **TR85363**.

(3) Crankshaft (m) R116076, R502654.