

**PowerTech**  
**Engine & Equipment**  
**Model**

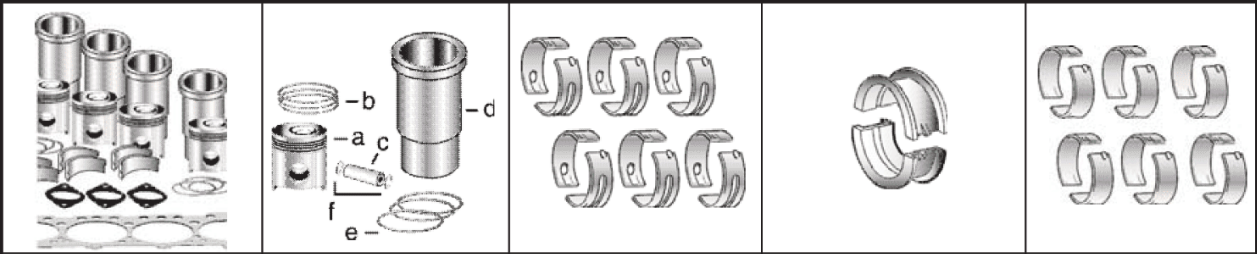

**6068D**

6.8D

6 Cyl

Bore: 4.19 in  
 106.5 mm  
 Pin Ø: 1.375 in  
 35 mm

**Piston (m):**  
 RE59279, RE505101

**Con Rod (m):**  
 RE123959, R500000

**APPLICATIONS:**

**AGRICULTURAL**

6205 6515  
 6505 6520  
 6510 SE6520  
 SE6510

**OEM**

6.8L

1) Engine O/H Kit      Piston-Liner Kit      Main Bearing      Thrust Bearing      Con Rod Bearing

2) Engine I/F Kit      **TRE65966** (RE505110)      **TRE65165** Std.      **TRE65168** Std.      **TRE65908** Std.

1) **TRE66095**      Consists of:      **TRE65911** .010      **TRE65912** .010      **TRE65909** .010  
**TRE66095A** (\*)      a) **TRE59279**      **TRE65165B** .020 (8)      **TRE65168B** .020 (8)      **TRE65908B** .020 (8)  
 (\*) w/C. Rod R500000      b) **TRE66271**

2) **TIK66095**      c) **TR123178**      **Use 6**      **Use 1**      **Use 6**  
**TIK66095A** (\*)      d) **TR116383**  
 (\*) w/C. Rod R500000      e) **TAR65507**  
 f) **TM41029**

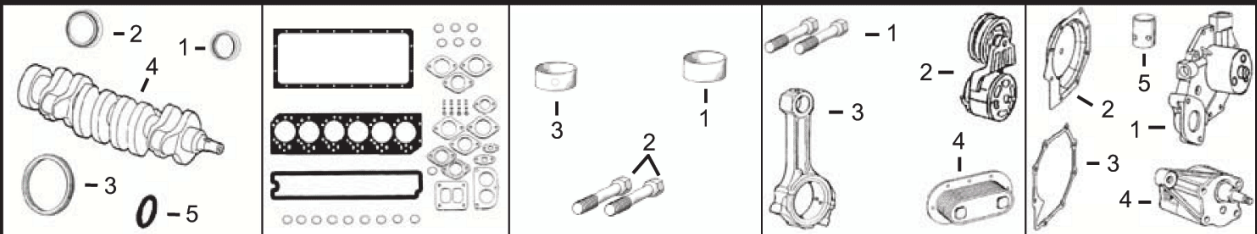

1) Front Seal      1) O/H Gasket Set      1) Bush, Con Rod      1) Cyl Hd Cap Screw      1) Water Pump  
 2) Rear Seal      2) Head Gasket Set      2) Bolt, Con Rod      2) Tensioner, Belt      2) Water Pump Cov  
 3) Ring Gear      3) Head Gasket      3) Bushing, Cam      3) Con Rod      3) Water Pump Gsk  
 4) Crankshaft      4) Oil Pan Gasket      4) Oil Cooler      4) Pump, Oil      4) Pump, Oil  
 5) Seal      5) Rocker Cover Gsk      5) Tappet

1) **TRE505515** (5)      1) **TRE501456**      1) **TR123960** x6      1) **TR85363** x18 (2)      1) **TRE500737**  
 2) **TRE44574**      2) **TRE66085**      2) **TR114083** x12 (1)      2) **TRE518097** (7)      (Standard Flow)  
 3) **TR28811** (129T)      3) **TR116516**      **TR501124** x12 (1)      **TRE68715** (7)      **TRE500734**  
 or      4) **TR123354**      3) **TR119874** x1      **TRE500002**      (High Flow)  
**TR114282** (142T)      5) **TR123543**

4) **TRE52850** (3)      4) **TRE52996** (5 Plates)      4) **TRE52996** (5 Plates)      4) **TRE52996** (7 Plates)      2) **TRE508566**  
 5) **TH35244**      5) **TRE52998** (9 Plates)      5) **TR123417**      5) **TR123565** x8      3) **TR123417**  
 3) **TR123417**      4) **TRE504914**  
 4) **TRE504914**  
 5) **TR123565** x8

Valve, Intake      Valve, Exhaust      Insert, Valve      1) Seal, Valve      1) Spring, Valve  
 1) Intake      1) Intake      1) Intake      2) Lock, Valve      2) Rotator, Valve  
 2) Exhaust      2) Exhaust

**TR98062** Std.      **TR90692** Std.      1) **TR98063** Std.      1) **TRE31617**      1) **TR26125**  
**TR97490** .015      **TR97492** .015      **TR98335** O/S      2) **TR91889**      2) **TRE60005**  
 2) **TR85687** Std.      1) **TR93910** O/S

Thermostat      Injector, Pencil      Seal, Injector      Fuel Transfer Pump

**TRE522076** 180° F (7)      **TRE60062** (Non Turbo)      **TR92352**      **TRE68345**  
**TRE528652** 180° F (7)      **TRE48786** (Turbo)      **TR48000**      or  
**TRE540550** 180° F (7)      **TRE531436** (6)      **TRE66153** (4)

(4) Line Connections are both threaded.  
 (5) 1 Piece Unitized Seal and Wearsleeve; Replaces TRE59810, RE538097.  
 (6) Use with Stanadyne DE10 Injection Pump.  
 (7) Check application for proper usage.  
 (8) Proper bearing journal radius must be maintained during the machining of the crankshaft to ensure proper operation.

(1) Use **TR114083** Rod Bolts with Machine Split Connecting Rods, and use **TR501124** Rod Bolts with Fractured Split Connecting Rods.

(2) Replace all R78558 Cap Screws with Flanged Head Cap Screw **TR85363**.

(3) Crankshaft (m) R116076, R502654.