

**PowerTech**  
**Engine & Equipment**  
**Model**



**6068T**

**6.8T**  
**6 Cyl**  
 Bore: 4.19 in  
 106.5 mm  
 Pin Ø: 1.375 in  
 35 mm

**Piston (m):**  
 RE59277, RE505100 (9)

**Con Rod (m):**  
 RE123959, R500000

**APPLICATIONS:**

**AGRICULTURAL**  
 6603  
 7455  
 7460  
 9935

**OEM**  
 6.8L

**CONSTRUCTION**

670C/CH  
 672CH  
 700H/J

<b>1) Engine O/H Kit</b>	<b>Piston-Liner Kit</b>	<b>Main Bearing</b>	<b>Thrust Bearing</b>	<b>Con Rod Bearing</b>
<b>2) Engine I/F Kit</b>	<b>TRE507920 (RE515372)</b> Consists of: a) <a href="#">TRE515372</a> b) <a href="#">TRE66820</a> c) <a href="#">TR123178</a> d) <a href="#">TR116383</a> e) <a href="#">TAR65507</a> f) <a href="#">TM41029</a>	<a href="#">TRE65165</a> Std. <a href="#">TRE65911</a> .010 <a href="#">TRE65165B</a> .020 (8)	<a href="#">TRE65168</a> Std. <a href="#">TRE65912</a> .010 <a href="#">TRE65168B</a> .020 (8)	<a href="#">TRE65908</a> Std. <a href="#">TRE65909</a> .010 <a href="#">TRE65908B</a> .020 (8)
<b>1) <a href="#">TRE66096</a> <a href="#">TRE66096A</a> (*) (*) w/C. Rod R500000</b>				
<b>2) <a href="#">TIK66096</a> <a href="#">TIK66096A</a> (*) (*) w/C. Rod R500000</b>		<b>Use 6</b>	<b>Use 1</b>	<b>Use 6</b>

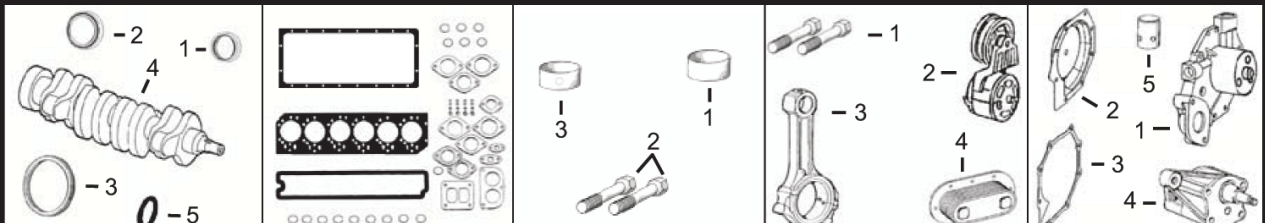

<b>1) Front Seal</b> <b>2) Rear Seal</b>	<b>1) O/H Gasket Set</b>	<b>1) Bush, Con Rod</b> <b>2) Bolt, Con Rod</b> <b>3) Bushing, Cam</b>	<b>1) Cyl Hd Cap Screw</b> <b>2) Tensioner, Belt</b> <b>3) Con Rod</b> <b>4) Oil Cooler</b>	<b>1) Water Pump</b> <b>2) Water Pump Cov</b> <b>3) Water Pump Gsk</b> <b>4) Pump, Oil</b> <b>5) Tappet</b>
<b>3) Ring Gear</b> <b>4) Crankshaft</b> <b>5) Seal</b>	<b>2) Head Gasket Set</b> <b>3) Head Gasket</b> <b>4) Oil Pan Gasket</b> <b>5) Rocker Cover Gsk</b>			

1) <a href="#">TRE505515</a> (5) 2) <a href="#">TRE44574</a> 3) <a href="#">TR28811</a> (129T) or <a href="#">TR114282</a> (142T) 4) <a href="#">TRE52850</a> (3) 5) <a href="#">TH35244</a>	1) <a href="#">TRE501456</a> 2) <a href="#">TRE66085</a> 3) <a href="#">TR116516</a> 4) <a href="#">TR123354</a> 5) <a href="#">TR123543</a>	1) <a href="#">TR123960</a> x6 2) <a href="#">TR114083</a> x12 (1) <a href="#">TR501124</a> x12 (1) 3) <a href="#">TR119874</a> x1	1) <a href="#">TR85363</a> x26 (2) 2) <a href="#">TRE518097</a> (7) <a href="#">TRE68715</a> (7) 3) <a href="#">TRE500002</a> 4) <a href="#">TRE59296</a> (5 Plates) <a href="#">TRE56690</a> (7 Plates) <a href="#">TRE59298</a> (9 Plates)	1) <a href="#">TRE500737</a> (Standard Flow) <a href="#">TRE500734</a> (High Flow) 2) <a href="#">TRE508566</a> 3) <a href="#">TR123417</a> 4) <a href="#">TRE504914</a> 5) <a href="#">TR123565</a> x12
--	--	---	--	---

Valve, Intake	Valve, Exhaust	Insert, Valve 1) Intake 2) Exhaust	1) Seal, Valve 2) Lock, Valve	1) Spring, Valve 2) Rotator, Valve
<a href="#">TR98062</a> Std. <a href="#">TR97490</a> .015	<a href="#">TR90692</a> Std. <a href="#">TR97492</a> .015	1) <a href="#">TR98063</a> Std. <a href="#">TR98335</a> O/S 2) <a href="#">TR85687</a> Std. <a href="#">TR93910</a> O/S	1) <a href="#">TRE31617</a> 2) <a href="#">TR91889</a>	1) <a href="#">TR26125</a> 2) <a href="#">TRE60005</a>

				<b>(4) Line Connections are both threaded.</b> <b>(5) 1 Piece Unitized Seal and Wearsleeve; Replaces <a href="#">TRE59810</a>, RE538097.</b> <b>(6) Use with Stanadyne DE10 Injection Pump.</b> <b>(7) Check application for proper usage.</b> <b>(8) Proper bearing journal radius must be maintained during the machining of the crankshaft to ensure proper operation.</b> <b>(9) These marking numbers RE592727, RE505100 require to use Ring Set <a href="#">TRE66271</a>.</b>
<b>Thermostat</b>	<b>Injector, Pencil</b>	<b>Seal, Injector</b>	<b>Fuel Transfer Pump</b>	
<a href="#">TRE522076</a> 180° F (7) <a href="#">TRE528652</a> 180° F (7) <a href="#">TRE540550</a> 180° F (7) <a href="#">TRE64354</a> 180° F (7)	<a href="#">TRE60062</a> (Non Turbo) <a href="#">TRE48786</a> (Turbo) <a href="#">TRE531436</a> (6)	<a href="#">TR92352</a> <a href="#">TR48000</a>	<a href="#">TRE68345</a> or <a href="#">TRE66153</a> (4)	

**(1)** Use [TR114083](#) Rod Bolts with Machine Split Connecting Rods, and use [TR501124](#) Rod Bolts with Fractured Split Connecting Rods.

**(2)** Replace all R78558 Cap Screws with Flanged Head Cap Screw [TR85363](#).

**(3)** Crankshaft (m) R116076, R502654.