

**PowerTech**  
**Engine & Equipment**  
**Model**

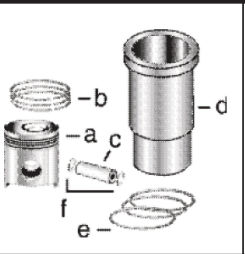

**4045T/H**

4.5T/H

4 Cyl

Bore: 4.19 in  
 106.5 mm  
 Pin Ø: 1.62 in  
 41 mm

**Piston (m):**  
 RE55512, RE505102

**Con Rod (m):**  
 R114081, R500335

**APPLICATIONS:**

**AGRICULTURAL**  
 6010 6410/L/S  
 6110/L 6510L  
 6210/L 6610S  
 6310/L/S 6605  
 6405 6610

**OEM**  
 4.5L

**CONSTRUCTION**  
 120 550H  
 444H/HCL 550G  
 TC444H 555G  
 450G 650G  
 455G

**1) Engine O/H Kit**

**Piston-Liner Kit**

**Main Bearing**

**Thrust Bearing**

**Con Rod Bearing**

**2) Engine I/F Kit**

**TRE507850 (RE505112)**

**TRE65165 Std.**

**TRE65168 Std.**

**TRE65908 Std.**

**1) TRE66094 TRE66094A (\*)**  
 (\*) w/C. Rod R500335

Consists of:

**TRE65911 .010**

**TRE65912 .010**

**TRE65909 .010**

**2) TIK66094 TIK66094A (\*)**  
 (\*) w/C. Rod R500335

- a) [TRE55512](#)
- b) [TRE66820](#)
- c) [TR123177](#)
- d) [TR116383](#)
- e) [TAR65507](#)
- f) [TR54114](#)

**TRE65165B .020 (9)**

**TRE65168B .020 (9)**

**TRE65908B .020 (9)**

**Use 4**

**Use 1**

**Use 4**

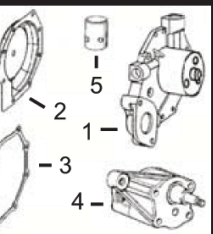
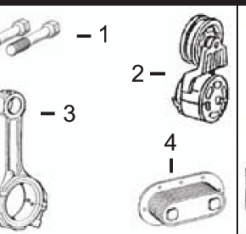
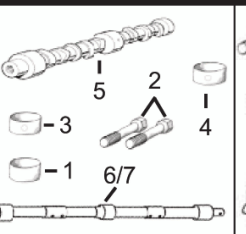
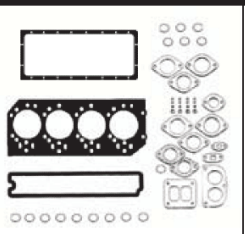
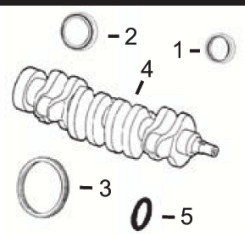

**1) Front Seal**  
**2) Rear Seal**

**1) O/H Gasket Set**

**1) Bush, Con Rod**  
**2) Bolt, Con Rod**  
**3) Bush, Bal. Shaft**  
**4) Bush, Camshaft**

**1) Cyl Hd Cap Screw**  
**2) Tensioner, Belt**  
**3) Con Rod**  
**4) Oil Cooler**

**1) Water Pump**  
**2) Water Pump Cov**  
**3) Water Pump Gsk**  
**4) Pump, Oil**  
**5) Tappet**

**3) Ring Gear**

**2) Head Gasket Set**

**5) Camshaft**

**1) TR85363 x18 (4)**

**1) TRE500737 (Standard Flow)**

**4) Crankshaft**

**3) Head Gasket**

**6) Bal. Shaft R/H**

**2) TRE518097 (10)**

**TRE500734 (High Flow)**

**5) Seal**

**4) Oil Pan Gasket**

**7) Bal. Shaft L/H**

**3) TRE500608**

**2) TRE508566**

**1) TRE505515 (8)**

**1) TRE501455**

**1) TR114082 x4**

**4) TRE59296 (5 Plates)**

**3) TR123417**

**2) TRE44574**

**2) TRE66082**

**2) TR114083 x8 (1)**

**7) TRE56690 (7 Plates)**

**4) TRE504914**

**3) TR28811 (129T)**

**3) TR116515**

**TR501124 x8 (1)**

**TRE59298 (9 Plates)**

**5) TR123565 x8**

**or TR114282 (142T)**

**4) TR123352 (2)**

**3) TR115299 x6**

**4) TRE500448**

**2) TRE508566**

**4) TRE50618 (5)**

**TR97342 (3)**

**4) TR119874 x1**

**6) TRE500448**

**3) TR123417**

**5) TH35244**

**(R123353)**

**5) TRE56375 (6)**

**6) TRE500448**

**4) TRE504914**

**Valve, Intake**

**Valve, Exhaust**

**Insert, Valve**

**1) Seal, Valve**

**1) Spring, Valve**

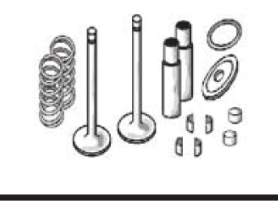

**TR98062 Std.**  
**TR97490 .015**

**TR90692 Std.**  
**TR97492 .015**

**1) Intake**  
**2) Exhaust**

**2) Lock, Valve**

**2) Rotator, Valve**

**1) TR98063 Std.**  
**TR98335 O/S**

**1) TR98063 Std.**  
**TR98335 O/S**

**2) TR85687 Std.**  
**TR93910 O/S**

**1) TRE31617**  
**2) TR91889**

**1) TR26125**  
**2) TRE60005**



**Thermostat**

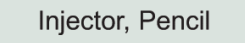

**Injector, Pencil**

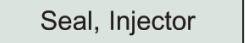

**Seal, Injector**

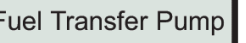

**Fuel Transfer Pump**

**TRE522076 180° F (10)**

**TRE60062 (Non Turbo)**

**TR92352**

**TRE68345**

**TRE528652 180° F (10)**

**TRE48786 (Turbo)**

**TR48000**

**or**

**TRE540550 180° F (10)**

**TRE531436 (11)**

**TRE66153 (7)**

**TRE64354 180° F (10)**

- (4) Replace all R78558 Cap Screws with Flanged Head Cap Screw [TR85363](#).
- (5) Crankshaft (m) R113596. Not to be used with applications requiring speed sensor gear.
- (6) (m) R135439, R132324, R134213.
- (7) Line Connections are both threaded.
- (8) 1 Piece Unitized Seal and Wearsleeve; Replaces TRE59810, RE538097.
- (9) Proper bearing journal radius must be maintained during the machining of the crankshaft to ensure proper operation.
- (10) Check application for proper usage.
- (11) Use with Stanadyne DE10 Injection Pump.

- (1) Use [TR114083](#) Rod Bolts with Machine Split Connecting Rods, and use [TR501124](#) Rod Bolts with Fractured Split Connecting Rods.
- (2) Use with Oil Pan code 1901, 1902 & 1903, for Steel Oil Pan.
- (3) Use with Oil Pan code 1904 & 1905, for Aluminum Oil Pan.