

**PowerTech**  
**Engine & Equipment**  
**Model**

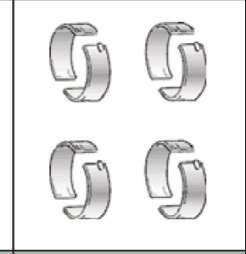
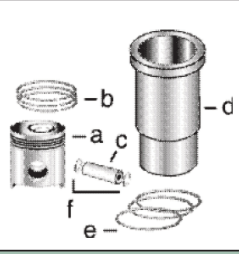

**4045D**

4.5D

4 Cyl

Bore: 4.19 in  
 106.5 mm  
 Pin Ø: 1.375 in  
 35 mm

**Piston (m):**  
 RE59279, RE505101

**Con Rod (m):**  
 R123959, R500000

**APPLICATIONS:**

**AGRICULTURAL**

- 5410      5715
- 5415      6010
- 5420/N    6110
- 5510      6610
- 5615

**OEM**

4.5L

**CONSTRUCTION**

- 210LE      486E
- 310E      488E
- 450H      550H
- 485E      650H

**1) Engine O/H Kit**

**Piston-Liner Kit**

**Main Bearing**

**Thrust Bearing**

**Con Rod Bearing**

**2) Engine I/F Kit**

**TRE65966 (RE505110)**

**TRE65165 Std.**

**TRE65168 Std.**

**TRE65908 Std.**

**1) TRE66092**  
**TRE66092A (\*)**  
 (\*) w/C. Rod R500000

Consists of:  
 a) [TRE59279](#)  
 b) [TRE66271](#)  
 c) [TR123178](#)  
 d) [TR116383](#)  
 e) [TAR65507](#)  
 f) [TM41029](#)

[TRE65911](#) .010  
[TRE65165B](#) .020 (9)

[TRE65912](#) .010  
[TRE65168B](#) .020 (9)

[TRE65909](#) .010  
[TRE65908B](#) .020 (9)

**Use 4**

**Use 1**

**Use 4**

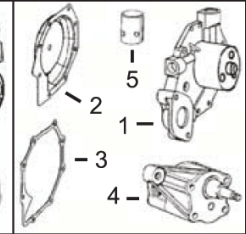
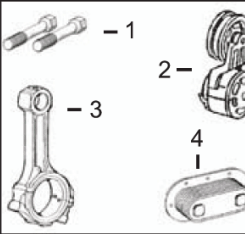
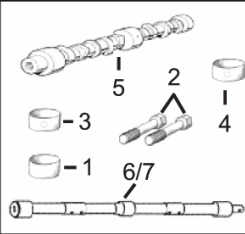
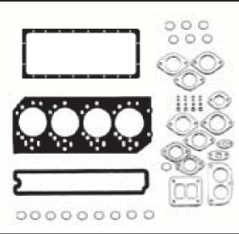
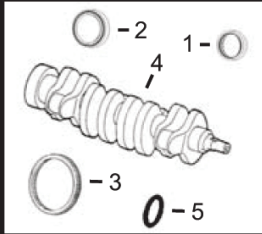

**1) Front Seal**  
**2) Rear Seal**

**1) O/H Gasket Set**

**1) Bush, Con Rod**  
**2) Bolt, Con Rod**  
**3) Bush, Bal. Shaft**  
**4) Bush, Camshaft**

**1) Cyl Hd Cap Screw**  
**2) Tensioner, Belt**  
**3) Con Rod**  
**4) Oil Cooler**

**1) Water Pump**  
**2) Water Pump Cov**  
**3) Water Pump Gsk**  
**4) Pump, Oil**  
**5) Tappet**

**3) Ring Gear**  
**4) Crankshaft**  
**5) Seal**

**2) Head Gasket Set**  
**3) Head Gasket**  
**4) Oil Pan Gasket**  
**5) Rocker Cover Gsk**

**5) Camshaft**  
**6) Bal. Shaft R/H**  
**7) Bal. Shaft L/H**

1) [TRE505515](#) (8)  
 2) [TRE44574](#)  
 3) [TR28811](#) (129T)  
 or  
[TR114282](#) (142T)  
 4) [TRE50618](#) (5)  
 5) [TH35244](#)

1) [TRE501455](#)  
 2) [TRE66082](#)  
 3) [TR116515](#)  
 4) [TR123352](#) (2)  
[TR97342](#) (3)  
 (R123353)  
 5) [TR123542](#)

1) [TR123960](#) x4  
 2) [TR114083](#) x8 (1)  
[TR501124](#) x8 (1)  
 3) [TR115299](#) x6  
 4) [TR119874](#) x1  
 5) [TRE56375](#) (6)  
 6) [TRE500448](#)  
 7) [TRE500449](#)

1) [TR85363](#) x18 (4)  
 2) [TRE518097](#) (10)  
[TRE68715](#) (10)  
 3) [TRE500002](#)  
 4) [TRE59296](#) (5 Plates)  
[TRE56690](#) (7 Plates)  
[TRE59298](#) (9 Plates)

1) [TRE500737](#)  
 (Standard Flow)  
[TRE500734](#)  
 (High Flow)  
 2) [TRE508566](#)  
 3) [TR123417](#)  
 4) [TRE504914](#)  
 5) [TR123565](#) x8

Valve, Intake

Valve, Exhaust

Insert, Valve  
 1) Intake  
 2) Exhaust

1) Seal, Valve  
 2) Lock, Valve

1) Spring, Valve  
 2) Rotator, Valve

[TR98062](#) Std.  
[TR97490](#) .015

[TR90692](#) Std.  
[TR97492](#) .015

1) [TR98063](#) Std.  
[TR98335](#) O/S  
 2) [TR85687](#) Std.  
[TR93910](#) O/S

1) [TRE31617](#)  
 2) [TR91889](#)

1) [TR26125](#)  
 2) [TRE60005](#)

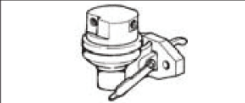

**(4) Replace all R78558 Cap Screws with Flanged Head Cap Screw [TR85363](#).**  
**(5) Crankshaft (m) R113596. Not to be used with applications requiring speed sensor gear.**  
**(6) (m) R135439, R132324, R134213.**  
**(7) Line Connections are both threaded.**  
**(8) 1 Piece Unitized Seal and Wearsleeve; Replaces TRE59810, RE538097.**  
**(9) Proper bearing journal radius must be maintained during the machining of the crankshaft to ensure proper operation.**  
**(10) Check application for proper usage.**  
**(11) Use with Stanadyne DE10 Injection Pump.**

**Thermostat**  
[TRE522076](#) 180° F (10)  
[TRE528652](#) 180° F (10)  
[TRE540550](#) 180° F (10)  
[TRE64354](#) 180° F (10)  
[TRE60062](#) (Non Turbo)  
[TRE48786](#) (Turbo)  
[TRE531436](#) (11)

**Injector, Pencil**  
[TR92352](#)  
[TR48000](#)

**Seal, Injector**  
[TRE68345](#)  
 or  
[TRE66153](#) (7)

**(1)** Use [TR114083](#) Rod Bolts with Machine Split Connecting Rods, and use [TR501124](#) Rod Bolts with Fractured Split Connecting Rods.  
**(2)** Use with Oil Pan code 1901, 1902 & 1903, for Steel Oil Pan.  
**(3)** Use with Oil Pan code 1904 & 1905, for Aluminum Oil Pan.