

**300 Series**  
**Engine & Equipment**  
**Model**  
**6068T**

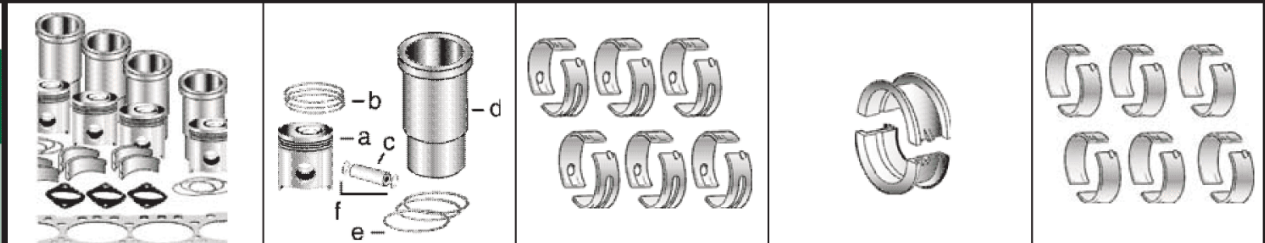

**Liter Designated**  
**6 Cyl**  
 Bore: 4.19 in  
 106.5 mm  
 Pin Ø: 1.62 in  
 41 mm

<b>1) Engine O/H Kit</b>	<b>Piston-Liner Kit</b>	<b>Main Bearing</b>	<b>Thrust Bearing</b>	<b>Con Rod Bearing</b>
<b>2) Engine I/F Kit</b>	<b>TRE53073</b> Consists of: a) <a href="#">TRE48469</a> b) <a href="#">TRE66820</a> c) <a href="#">TR124230</a> d) <a href="#">TR80500</a> e) <a href="#">TAR65507</a> f) <a href="#">TR54114</a>	<a href="#">TRE27352</a> Std. <a href="#">TRE27353</a> .010 <a href="#">TRE27360</a> .020 <a href="#">TRE27368</a> .030	<a href="#">TAT21139</a> Std. <a href="#">TAT21132</a> .010 <a href="#">TAT21134</a> .020 <a href="#">TAT21136</a> .030	<a href="#">TAR97517</a> Std. <a href="#">TAR97653</a> .010 <a href="#">TAR97654</a> .020 <a href="#">TAR97655</a> .030
<b>1) <a href="#">TOK61614</a></b>				
<b>2) <a href="#">TIK61614</a></b>		<b>Use 6</b>	<b>Use 1</b>	<b>Use 6</b>

**APPLICATIONS:**  
**AGRICULTURAL**  
 6800 7500  
 6900 7600  
 7400 9400  
 7410

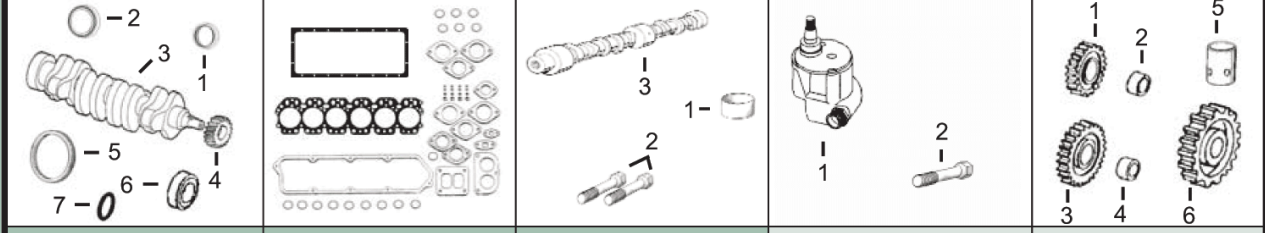

**CONSTRUCTION**  
 544B/C/D 672A/B  
 624E/EH/G 690D/E  
 640D 693D  
 643/D 750/B  
 648D 755  
 648E 755A/B  
 653 755BMIL  
 655A/B 790E  
 670A/B

<b>1) Front Seal</b> <b>2) Rear Seal</b>	<b>1) O/H Gasket Set</b>	<b>1) Bush, Con Rod</b> <b>2) Bolt, Con Rod</b>	<b>1) Pump, Oil</b> <b>2) Cyl Hd Cap Screw</b>	<b>1) Lower Gear</b> <b>2) Lower Bushing</b> <b>3) Upper Gear</b> <b>4) Upper Bushing</b> <b>5) Cam. Follower</b> <b>6) Cam. Gear</b>
<b>3) Crankshaft</b> <b>4) Crankshaft, Gear</b> <b>5) Ring Gear</b> <b>6) Sleeve, Front</b> <b>7) Packing, Sleeve</b>	<b>2) Head Gasket Set</b> <b>3) Head Gasket</b> <b>4) Oil Pan Gasket</b> <b>5) Rocker Cover Gsk</b>	<b>3) Camshaft</b>		
<b>1) <a href="#">TAR67942</a></b> <b>2) <a href="#">TRE44574</a></b> <b>3) <a href="#">TRE45517</a> (3)</b> <b>4) <a href="#">TT20094</a></b> <b>5) <a href="#">TR28811</a> (129T)</b> or <b><a href="#">TR114282</a> (142T)</b> <b>6) <a href="#">TR81989</a></b> <b>7) <a href="#">TH35244</a></b>	<b>1) <a href="#">TRE501580</a></b> <b>2) <a href="#">TRE38852</a></b> <b>3) <a href="#">TR114157</a></b> <b>4) <a href="#">TR97344</a></b> <b>5) <a href="#">TR75728</a></b>	<b>1) <a href="#">TR57451</a> x6</b> <b>2) <a href="#">TR74195</a> x12 (5)</b> <b>3) <a href="#">TR82821</a> (2)</b>	<b>1) <a href="#">TRE65580</a></b> <b>2) <a href="#">TR85363</a> x26 (4)</b>	<b>1) <a href="#">TAT24252</a> (1)</b> <b>2) <a href="#">TT26321</a></b> <b>3) <a href="#">TAT18009</a> (1)</b> <b>4) <a href="#">TT20034</a></b> <b>5) <a href="#">TT20073</a></b> <b>6) <a href="#">TT20070</a> (1)</b>

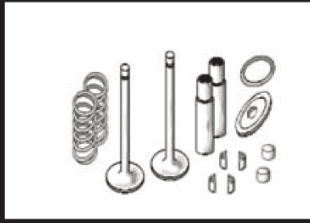

Valve, Intake	Valve, Exhaust	Insert, Valve 1) Intake 2) Exhaust	1) Seal, Valve 2) Lock, Valve	1) Spring, Valve 2) Rotator, Valve
<a href="#">TR98062</a> Std. <a href="#">TR97490</a> .015	<a href="#">TR90692</a> Std. <a href="#">TR97492</a> .015	1) <a href="#">TR98063</a> Std. <a href="#">TR98335</a> O/S 2) <a href="#">TR85687</a> Std. <a href="#">TR93910</a> O/S	1) <a href="#">TRE31617</a> 2) <a href="#">TR91889</a>	1) <a href="#">TR26125</a> 2) <a href="#">TRE60005</a>



<b>Thermostat</b>  <a href="#">TRE33705</a> 180° F	<b>Fuel Transfer Pump</b>  <a href="#">TRE42211</a>	<b>Water Pump Repair Kit</b>  Without Impeller      With Impeller  <a href="#">See Chart</a>		<b>Water Pump</b>  <a href="#">TRE41157</a>	<b>1) Seal, Injector</b> <b>2) Injector, Pencil</b>  1) <a href="#">TR60746</a> <a href="#">TR48000</a> 2) <a href="#">TRE38087</a>
--	---	--	--	---	--

(1) Helicoidal Gears.  
 (2) Threaded Type.  
 (3) Crankshaft (m) R104523.  
 (4) Replace all R78558 Cap Screws with Flanged Head Cap Screw [TR85363](#).  
 (5) When used on connecting rods marked R56187, torque bolts to 95 ft.lbs. Only.