

300 Series
Engine & Equipment
Model
6068T

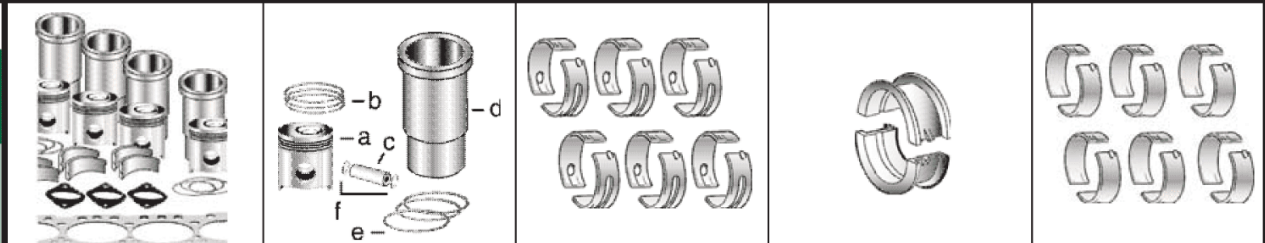

Liter Designated
6 Cyl
 Bore: 4.19 in
 106.5 mm
 Pin Ø: 1.62 in
 41 mm

1) Engine O/H Kit	Piston-Liner Kit	Main Bearing	Thrust Bearing	Con Rod Bearing
2) Engine I/F Kit	TRE53073 Consists of: a) TRE48469 b) TRE66820 c) TR124230 d) TR80500 e) TAR65507 f) TR54114	TRE27352 Std. TRE27353 .010 TRE27360 .020 TRE27368 .030	TAT21139 Std. TAT21132 .010 TAT21134 .020 TAT21136 .030	TAR97517 Std. TAR97653 .010 TAR97654 .020 TAR97655 .030
1) TOK61614				
2) TIK61614		Use 6	Use 1	Use 6

APPLICATIONS:
AGRICULTURAL
 6800 7500
 6900 7600
 7400 9400
 7410

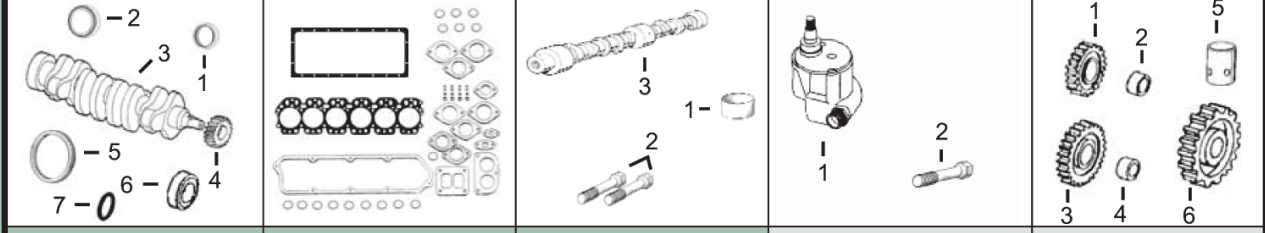

CONSTRUCTION
 544B/C/D 672A/B
 624E/EH/G 690D/E
 640D 693D
 643/D 750/B
 648D 755
 648E 755A/B
 653 755BMIL
 655A/B 790E
 670A/B

1) Front Seal 2) Rear Seal	1) O/H Gasket Set	1) Bush, Con Rod 2) Bolt, Con Rod	1) Pump, Oil 2) Cyl Hd Cap Screw	1) Lower Gear 2) Lower Bushing 3) Upper Gear 4) Upper Bushing 5) Cam. Follower 6) Cam. Gear
3) Crankshaft 4) Crankshaft, Gear 5) Ring Gear 6) Sleeve, Front 7) Packing, Sleeve	2) Head Gasket Set 3) Head Gasket 4) Oil Pan Gasket 5) Rocker Cover Gsk	3) Camshaft		
1) TAR67942 2) TRE44574 3) TRE45517 (3) 4) TT20094 5) TR28811 (129T) or TR114282 (142T) 6) TR81989 7) TH35244	1) TRE501580 2) TRE38852 3) TR114157 4) TR97344 5) TR75728	1) TR57451 x6 2) TR74195 x12 (5) 3) TR82821 (2)	1) TRE65580 2) TR85363 x26 (4)	1) TAT24252 (1) 2) TT26321 3) TAT18009 (1) 4) TT20034 5) TT20073 6) TT20070 (1)

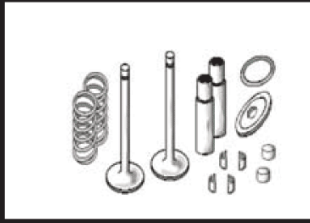

Valve, Intake	Valve, Exhaust	Insert, Valve 1) Intake 2) Exhaust	1) Seal, Valve 2) Lock, Valve	1) Spring, Valve 2) Rotator, Valve
TR98062 Std. TR97490 .015	TR90692 Std. TR97492 .015	1) TR98063 Std. TR98335 O/S 2) TR85687 Std. TR93910 O/S	1) TRE31617 2) TR91889	1) TR26125 2) TRE60005



Thermostat TRE33705 180° F	Fuel Transfer Pump TRE42211	Water Pump Repair Kit Without Impeller With Impeller See Chart		Water Pump TRE41157	1) Seal, Injector 2) Injector, Pencil 1) TR60746 TR48000 2) TRE38087
--	---	--	--	---	--

(1) Helicoidal Gears.
 (2) Threaded Type.
 (3) Crankshaft (m) R104523.
 (4) Replace all R78558 Cap Screws with Flanged Head Cap Screw [TR85363](#).
 (5) When used on connecting rods marked R56187, torque bolts to 95 ft.lbs. Only.