

PowerTech

Engine & Equipment Model

6081

High Comp. Piston

4801 4803

8.1L

Bore: 4.56 in
116 mm
Pin Ø: 1.85 in
47 mm

Con Rod (m):

R116340 (ESN > 86,536)
R501034 (ESN 86,537 >)

APPLICATIONS:

See Index

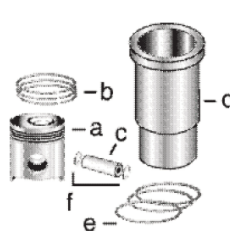

1) Engine O/H Kit	Piston-Liner Kit	Main Bearing	Thrust Bearing	Con Rod Bearing
--------------------------	-------------------------	---------------------	-----------------------	------------------------

2) Engine I/F Kit	TRE64509 Consists of:	TRE504195 Std. TRE504196 .011	TRE504198 Std. TRE504199 .011	TR116081 Std. TRE57167 .011
--------------------------	---------------------------------	--	--	--

1) TOK504201	a) TRE70688 b) TRE503528 c) TR57771 d) TR116236 e) TAR98850 f) TE1343FN	Use 6	Use 1 Thrust Washer TRE61253 Std. Use 3, Order Qty 1	Use 6
2) TIK504201				

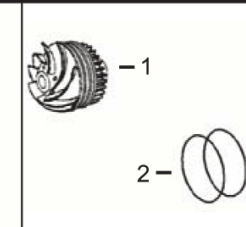
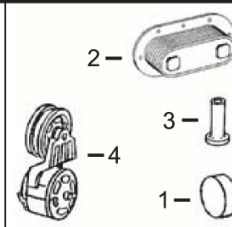
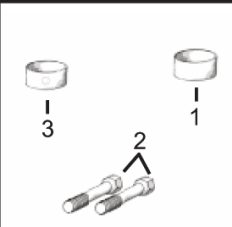
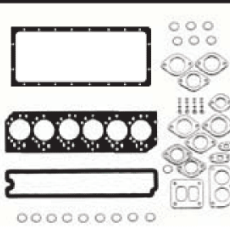
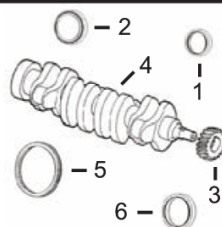

1) Front Seal 2) Rear Seal	1) O/H Gasket Set	1) Bush, Con Rod 2) Bolt, Con Rod 3) Bushing, Cam	1) Plug Camshaft 2) Oil Cooler 3) Tappet 4) Tensioner, Belt	1) Pump, Water 2) O'ring Mount Kit
---	--------------------------	--	--	---

3) Crankshaft Gear 4) Crankshaft 5) Ring Gear 6) Rear Gear	2) Head Gasket Set 3) Head Gasket 4) Oil Pan Gasket			
---	--	--	--	--

1) TAR49025 2) TRE520036 3) TR104587 4) TRE535300 (1) or TRE534314 (2) 5) TR28811 6) TR63326	1) TRE506220 2) TRE506222 3) TRE55475 4) TR71918 (3)	1) TR74008 x6 2) TR66452 x12 (4) 3) TR87561 x4	1) TR82007 2) TAR55394 3) TR110126 4) TRE518097 (9) TRE68715 (9) TRE57498 (9)	1) TRE521502 2) TRE509463
--	---	---	--	--



Valve, Intake	Valve, Exhaust	Insert, Valve 1) Intake 2) Exhaust	1) Cap, Valve 2) Lock, Valve 3) Shield, Valve	1) Spring, Valve
---------------	----------------	--	---	------------------

TR84618 Std. TR93308 .003 TR93312 .015	TR84619 Std. TR93311 .003 TR93313 .015	1) TR121193 2) TR119132	1) TT20129 2) TT20077 3) TR102882 x6 (5) TR501640 x6 (6)	1) TR91822 (7) TR502187 (8)
---	---	--	---	--



Thermostat

Pump, Oil

TAR48675 180° F

TRE60622

- (1) With helical oil pump drive gear. Do not use with HPCR fuel system.
- (2) With straight oil pump drive gear.
- (3) With Aluminum Oil Pan use **TR49377** (RE504822).
- (4) Use **TR66452** Rod Bolts with Machine Split Connecting Rods, and use **TR501035** Rod Bolts with Fractured Split Connecting Rods.
- (5) For engine ESN 199,999 and below. For Exhaust Valves only.
- (6) For engine ESN 200,000 and above. For Exhaust Valves only.
- (7) For engine ESN 199,999 and below.
- (8) For engine ESN 200,000 and above.
- (9) Check application for proper usage.