

300 Series

Engine & Equipment Model

3.152

154,766 >

O'rings on Block

3 Cyl

Bore: 3.86 in
98 mm
Pin Ø: 1.185 in
30 mm

Block (m):

R53240, R55100,
R72967, T32339

Con Rod (m):

T20007, R81410

APPLICATIONS:

AGRICULTURAL

820
830
1020
1030

CONSTRUCTION

300
300A
300B
301
301A
350A/B
380

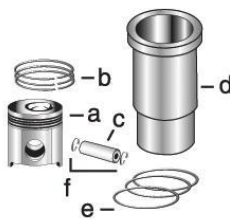

1) Engine O/H Kit

Piston-Liner Kit

Main Bearing

Thrust Bearing

Con Rod Bearing

2) Engine I/F Kit

[TAR71591](#)

Consists of:

[TRE27352](#) Std.

[TAT21139](#) Std.

[TRE27348](#) Std.

1) [TOK3591](#)

a) [TT23481](#)

[TRE27353](#) .010

[TAT21132](#) .010

[TRE27349](#) .010

2) [TIK3591](#)

b) [TAR70633](#)

[TRE27360](#) .020

[TAT21134](#) .020

[TRE27358](#) .020

c) [TT23482](#)

[TRE27368](#) .030

[TAT21136](#) .030

[TRE27364](#) .030

d) [TT32340](#)

Use 3

Use 1

Use 3

e) [TAR71617](#)

f) [TR51112](#)

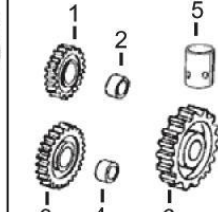
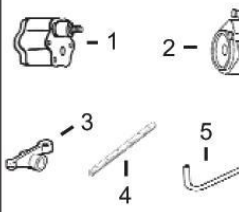
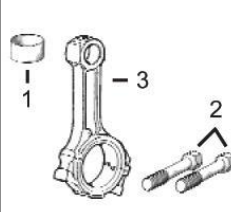
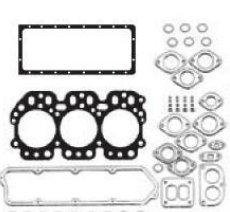
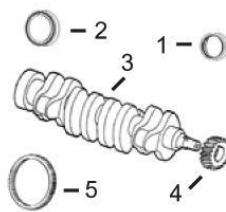

1) Front Seal
2) Rear Seal

1) O/H Gasket Set

1) Bush, Con Rod
2) Bolt, Con Rod

1) Pump, Oil
2) Oil Cooler
3) Rocker Arm
4) Rocker Shaft
5) Pump, Oil Tube

1) Lower Gear
2) Lower Bushing
3) Upper Gear
4) Upper Bushing
5) Cam. Follower
6) Cam. Gear

3) Crankshaft
4) Crankshaft, Gear
5) Ring Gear

2) Head Gasket Set
3) Head Gasket
4) Oil Pan Gasket
5) Rocker Cover Gsk

3) Con Rod

1) [TAR67942](#)
2) [TRE44574](#) (1)
3) [TAT18031](#)
4) [TT20094](#)
5) [TR114282](#) (142T)

1) [TRE38570](#)
2) [TRE38848](#)
3) [TR98460](#)
4) [TR97341](#)
5) [TR75729](#)

1) [TT23471](#) x3
2) [TR74194](#) x6 (4)
3) [TAT18005](#)

1) [TRE55343](#)
2) [TRE31929](#) (3)
3) [TRE31973](#)
4) [TR54985](#)
5) [TR113752](#)

1) [TAT24252](#)
2) [TT26321](#)
3) [TAT18009](#)
4) [TT20034](#)
5) [TT20073](#)
6) [TT20070](#)



Valve, Intake

Valve, Exhaust

Insert, Valve

1) Cap, Valve
2) Lock, Valve

1) Spring, Valve
2) Rotator, Valve
3) O'ring, Valve

[TR79623](#) Std.
[TR79628](#) .003
[TR79629](#) .015

[TR79624](#) Std.
[TR79625](#) .003
[TR79626](#) .015

1) [TR73064](#) Std.
2) [TR51734](#) Std.

1) [TT20129](#)
2) [TT20077](#)

1) [TR26125](#)
2) [TRE11410](#)
3) [TR87627](#)



1) Thermostat
2) Thermostat Cover

Fuel Transfer Pump

[TRE42211](#)



Water Pump Repair Kit

Without Impeller

With Impeller

[TRE19507](#)

[TRE62658](#)



Injector, Pencil

[TAR89564](#)



Seal

[TR60746](#)
[TR48000](#)

(1) Do not use with Flywheel Housing (m) T20300, T22991.

(2) Do not use with Housing (m) R54096, R70741, R74549.

(3) Conversion Kit [TMX386](#): Available Consists of: [TT31306](#) x1 Nipple [TR99802](#) x2 Hose.

(4) Use [TR74194](#) with C.Rod (m) T20007; use [TR80033](#) with C.Rod (m) R81410.