

400 Series
Engine & Equipment
Model

6.466A

233,593-317,858

6 Cyl

Bore: 4.56 in
 116 mm
 Pin Ø: 1.85 in
 47 mm

Con Rod (m):
 R71074 (P/N AR93341)

APPLICATIONS:

AGRICULTURAL

4840 8440
 4850 8450
 5720 8820
 5730 9940
 8430 9950

CONSTRUCTION

644C 770A/B
 690C 850B
 740A 892D
 762A/B

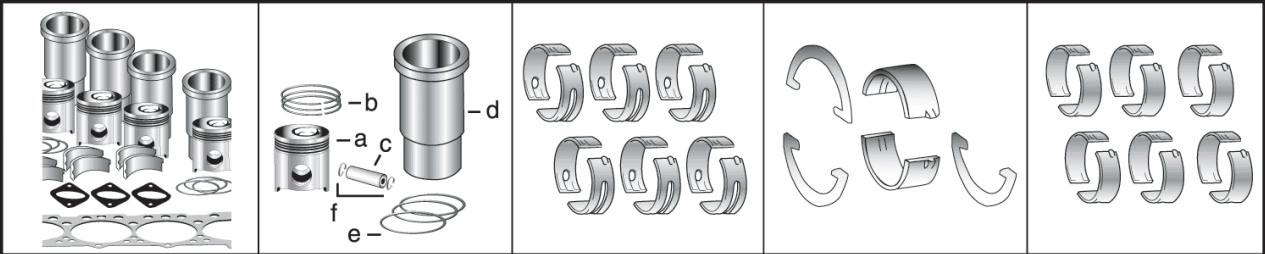

1) Engine O/H Kit **Piston-Liner Kit** **Main Bearing** **Thrust Bearing** **Con Rod Bearing**

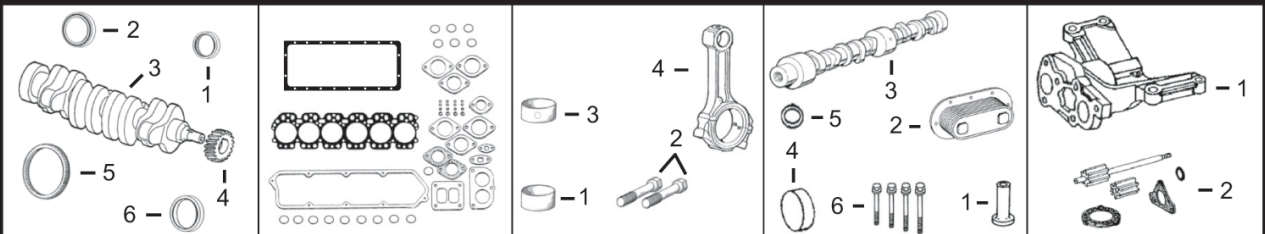

2) Engine I/F Kit	TAR100960 Consists of:	TAR74814 Std. TAR74816 .010 TAR74817 .020 TAR74818 .030	TAR77748 Std. TAR77750 .010 TAR77751 .020 TAR77752 .030	TAR73277 Std. TAR73279 .010 TAR73280 .020 TAR73281 .030
1) TRG20142	a) TAR100673	Use 6	Use 1	Use 6
2) TIK20142	b) TRE48380 c) TR57771 d) TAR63060 e) TAR98850 f) TE1343FN			

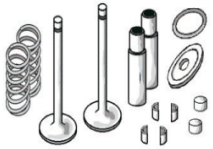

1) Front Seal **1) O/H Gasket Set** **1) Bush, Con Rod** **1) Cam Follower** **1) Pump, Oil**
2) Rear Seal **2) Head Gasket Set** **2) Bolt, Con Rod** **2) Oil Cooler** **2) Repair Kit**
3) Crankshaft **3) Head Gasket** **3) Bushing, Cam** **3) Camshaft Kit**
4) Crankshaft, Gear **4) Oil Pan Gasket** **4) Con Rod** **4) Plug, Camshaft**
5) Ring Gear **5) O'ring, Oil Cooler**
6) Rear Gear **6) Head Bolt, Kit**

1) TAR49025 2) TRE520036 3) TRE53422 (6) 4) TR26049 (23T) 5) TR28811 (129T) 6) TR63326	1) TAR98845 2) TAR98851 3) TRE47336 4) TR71918	1) TR74008 x6 2) TR66452 x12 3) TR46903 x4 4) TAR93341 x1  (1)	1) TR52773 2) TAT25038 (5) 3) TAR100385 4) TR26115 5) TR47153 6) TMX365 (3)* TMX366 (4)**	1) TRE60622 2) TMX1062 (2)
---	---	--	--	---

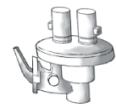
	Valve, Intake	Valve, Exhaust	Insert, Valve 1) Intake 2) Exhaust	1) Cap, Valve 2) Lock, Valve	1) Spring, Valve 2) Rotator, Valve 3) O'ring, Valve
	TR50358 Std. TR55055 .003 TR55057 .015	TR50357 Std. TR55056 .003 TR55058 .015	1) TR78702 Std. 2) TR50356 Std.	1) TT20129 2) TT20077	1) TR26125 2) TRE11410 3) TR87627

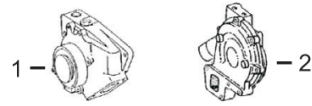
					
Thermostat	Fuel Transfer Pump	Water Pump Repair Kit		Water Pump	
		Without Impeller	With Impeller		
TAR48675 180° F	Not Used	See Chart		1) TRE55985 (m) R71224, (m) R83561 2) TRE20022 (OEM ESN 067685 >)	

(1) Shape, Conrod Bushing.
 (2) For Crankshaft driven Engine Pump, Oil Consists of: Shaft, Gears, and Gaskets.
 (3) **TMX365** Consists of: **TR88042** x6, **TR88043** x5, **TR88044** x8, **TR88045** x7. * With ESN > 317676.
 (4) **TMX366** Consists of: **TR88043** x11, **TR88044** x8, **TR88045** x7. ** With ESN 317677 >.
 (5) Some applications use **TAR55394**.
 (6) **TRE53422** will require front key **TR116311** for the front damper.