

**400 Series**  
**Engine & Equipment**  
**Model**  
**6076T/A/H**  
**Low Ring Piston**

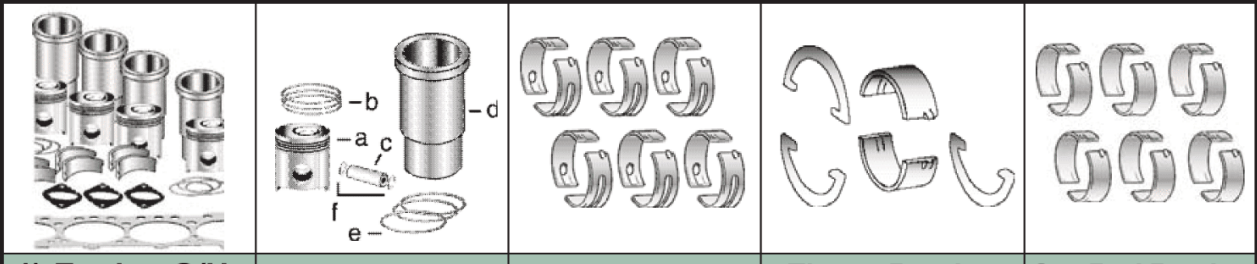

**6 Cyl**

Bore: 4.56 in  
 116 mm

Pin Ø: 1.85 in  
 47 mm

1) Engine O/H Kit	Piston-Liner Kit	Main Bearing	Thrust Bearing	Con Rod Bearing
<b>2) Engine I/F Kit</b>	<b>TRE60297</b> Consists of:	TAR74814 Std. TAR74816 .010 TAR74817 .020 TAR74818 .030	TAR77748 Std. TAR77750 .010 TAR77751 .020 TAR77752 .030	TAR73277 Std. TAR73279 .010 TAR73280 .020 TAR73281 .030
<b>1) TRE60299</b>	a) TRE57731 (1)	<b>Use 6</b>	<b>Use 1</b>	<b>Use 6</b>
<b>2) TIK60299</b>	b) TRE48380 c) TR57771 d) TAR63060 e) TAR98850 f) TE1343FN			
			<b>Thrust Washer</b> TAR77747 Std. TAR77753 .007 <b>Use 3, Order Qty 1</b>	

**Con Rod (m):**  
 R71074 (P/N AR93341)

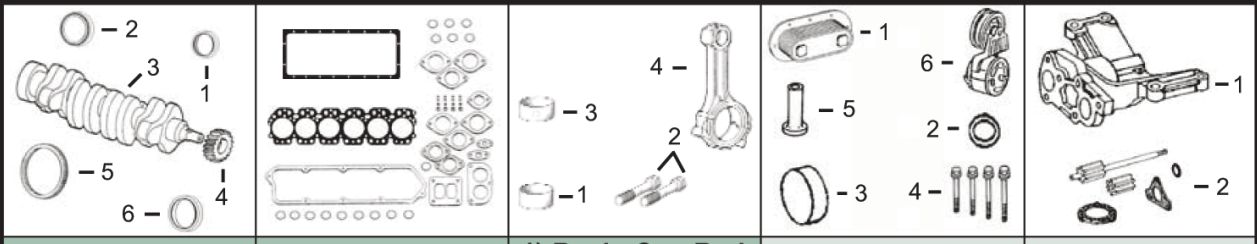

**APPLICATIONS:**

**AGRICULTURAL**  
 4955 8560  
 4960 8570

**CONSTRUCTION**  
 892E (1)

1) Front Seal 2) Rear Seal	1) O/H Gasket Set	1) Bush, Con Rod 2) Bolt, Con Rod 3) Bushing, Cam	1) Oil Cooler 2) O'ring, Oil Cooler 3) Plug, Camshaft 4) Head Bolt Kit 5) Tappet 6) Tensioner, Belt	1) Pump, Oil 2) Repair Kit
3) Crankshaft 4) Crankshaft, Gear 5) Ring Gear 6) Rear Gear	2) Head Gasket Set 3) Head Gasket 4) Oil Pan Gasket	4) Con Rod		
1) TAR49025 2) TRE520036 3) TRE53201 (2)(5) or TRE53422 (3)(5) 4) TR105488 (4) 5) TR28811 (129T) 6) TR63326	1) TRE35647 2) TRE29859 3) TRE47336 4) TR71918	1) TR74008 x6 2) TR66452 x12 3) TR87561 x4 4) TAR93341 x1	1) TAR55394 (7) 2) TR47153 3) TR82007 4) TMX366 (6) 5) TR110126 (8) 6) TRE57498 (9) TRE68715 (9)	1) TRE60622 (10) 2) TMX1062

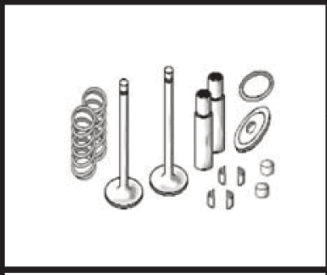

Valve, Intake	Valve, Exhaust	Insert, Valve 1) Intake 2) Exhaust	1) Cap, Valve 2) Lock, Valve 3) Shield, Valve	1) Spring, Valve 2) Rotator, Valve
TR84618 Std. TR93308 .003 TR93312 .015	TR84619 Std. TR93311 .003 TR93313 .015	1) TR84977 Std. 2) TR84976 Std.	1) TT20129 2) TT20077 3) TR102882	1) TR91822 2) TRE11410

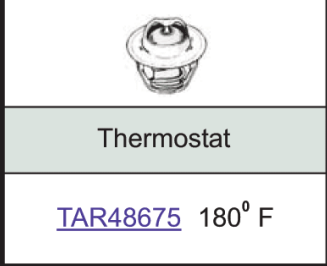

Thermostat	Fuel Transfer Pump	Water Pump Repair Kit		Water Pump
TAR48675 180° F	N/A	Without Impeller	With Impeller	TRE55985 (m) R71224, (m) R83561 (9) or TRE68230 (HIGH FLOW)
		See Chart		

(1) Low Ring Piston.  
 (2) Long snout (3.4in.) C/S (m) R87544, RE53201.  
 (3) Short snout (3in) C/S (m) RE53203, R63451, R104855.  
 (4) TRE53422 Use Helicoidal front gear.  
 (5) Require front key TR116311 for the front damper.  
 (6) Use with blocks marked R109806 and below.  
 (7) ESN > 100664 Use: TAT25038. Not for use with ESN 500,000 >.  
 (8) ESN 192401 >  
 (9) Check application for proper usage.  
 (10) If housing is marked (m) R124746 or R504071 or ESN 500 000 > use TRE63115R (Reman Unit).