

300 Series
Engine & Equipment
Model

4045D

Liter Designated

4 Cyl

Bore: 4.19 in
 106.5 mm
 Pin Ø: 1.625 in
 41 mm

APPLICATIONS:

AGRICULTURAL
 6100
 SE6100

CONSTRUCTION

340D
 455E
 344E 490D
 410C/D 493D
 440C 510B
 450E/G

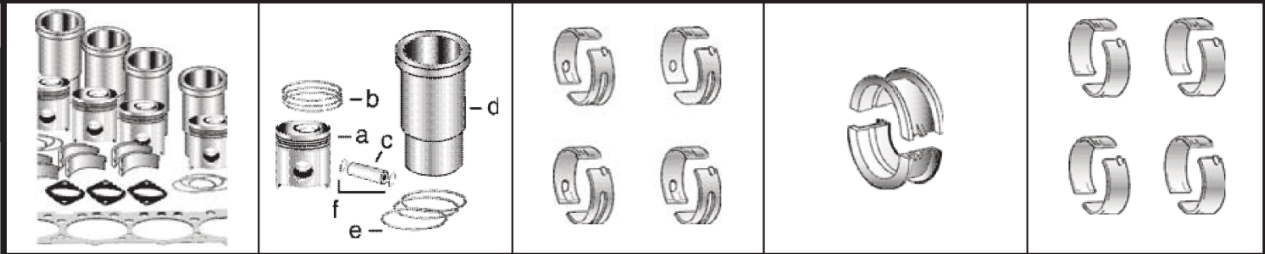

1) Engine O/H Kit	Piston-Liner Kit	Main Bearing	Thrust Bearing	Con Rod Bearing
2) Engine I/F Kit	TRE28966 Consists of:	TRE27352 Std.	TAT21139 Std.	TAR97517 Std.
1) TRE63694	a) TRE28919	TRE27353 .010	TAT21132 .010	TAR97653 .010
2) TIK63694	b) TRE66820	TRE27360 .020	TAT21134 .020	TAR97654 .020
	c) TR124230	TRE27368 .030	TAT21136 .030	TAR97655 .030
	d) TR80500			
	e) TAR65507			
	f) TR54114	Use 4	Use 1	Use 4

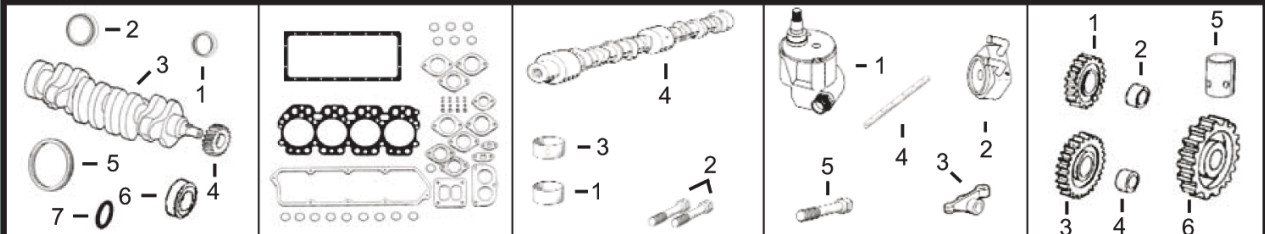

1) Front Seal 2) Rear Seal	1) O/H Gasket Set	1) Bush, Con Rod 2) Bolt, Con Rod 3) Bush, Bal. Shaft	1) Pump, Oil 2) Oil Cooler 3) Rocker Arm 4) Rocker Shaft 5) Cyl Hd Cap Screw	1) Lower Gear 2) Lower Bushing 3) Upper Gear 4) Upper Bushing 5) Cam. Follower 6) Cam. Gear
3) Crankshaft 4) Crankshaft, Gear 5) Ring Gear 6) Sleeve, Front 7) Packing, Sleeve	2) Head Gasket Set 3) Head Gasket 4) Oil Pan Gasket 5) Rocker Cover Gsk	4) Camshaft		
1) TAR67942 2) TRE44574 3) TRE56792 (*) 4) TT20094 5) TR28811 (129T) or TR114282 (142T) 6) TR81989 7) TH35244	1) TRE501568 2) TRE38851 3) TR125863 4) TR97342 5) TR73521	1) TR57451 x4 2) TR74195 x8 (7) 3) TR57160 x6 4) TR82820 (4)	1) TRE65580 (1) 2) TRE31929 (6) 3) TRE31973 4) TR54987 5) TR85363 x18 (5)	1) TAT24252 2) TT26321 3) TAT18009 4) TT20034 5) TT20073 6) TT20070

Valve, Intake	Valve, Exhaust	Insert, Valve 1) Intake 2) Exhaust	1) Seal, Valve 2) Lock, Valve	1) Spring, Valve 2) Rotator, Valve
TR98062 Std. TR97490 .015	TR90692 Std. TR97492 .015	1) TR98063 Std. TR98335 O/S 2) TR85687 Std. TR93910 O/S	1) TRE31617 2) TR91889	1) TR26125 2) TRE60005

1) Thermostat 2) Thermostat Cover	Fuel Transfer Pump	Water Pump Rep Kit a) Without Impeller b) With Impeller	Water Pump	Water Pump	1) Seal, Injector 2) Injector, Pencil
1) TAR48675 180° F (2) 2) TT23620	TRE42211 TRE38009 (3)	See Chart	TAR97708 (m) R73604 TRE60489 (m) R100812, (m) R127337, (m) R127918, (m) R55164	TRE41157	1) TR60746 TR48000 2) TRE38087

(*) Crankshaft (m) R54501. This Engines model may also use crankshaft **TRE54883** 60mm Snout; (m) R90825, R120009. PLEASE VERIFY.
 (1) Saran engines use **TRE55343** Standard flow.
 (2) Saran engines may use **TRE64354**.
 (3) Saran Engines.
 (4) Threaded Type. For Late 4039 models **TRE55901** Kit (Camshaft, Tappets and **TR119874** Bushing) is available.
 (5) Replace all R78558 Cap Screws with Flanged Head Cap Screw **TR85363**.
 (6) Always verify Oil Cooler Type.
 (7) When used on connecting rods marked R56187, torque bolts to 95 ft.lbs.