

# 300 Series

Engine & Equipment Model

## 4039T

Liter Designated

4 Cyl

Bore: 4.19 in  
106.5 mm  
Pin Ø: 1.625 in  
41 mm

Con Rod (m):

R80032, R122191,  
R113612

### APPLICATIONS:

#### AGRICULTURAL

5500N 6300  
5700 6300L  
6200 SE6200  
6200L SE6300

#### CONSTRUCTION

300D (Turbo)  
310C (Turbo)  
315C/D (Turbo)  
515B

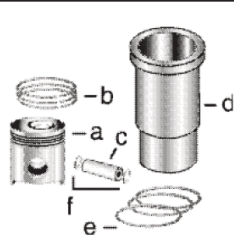

1) Engine O/H Kit	Piston-Liner Kit	Main Bearing	Thrust Bearing	Con Rod Bearing
-------------------	------------------	--------------	----------------	-----------------

2) Engine I/F Kit	<b>TRE33115</b> Consists of:	<b>TRE27352</b> Std.	<b>TAT21139</b> Std.	<b>TRE27348</b> Std.
-------------------	---------------------------------	----------------------	----------------------	----------------------

1) <b>TRE54709</b>	a) <b>TRE19278</b>	<b>TRE27353</b> .010	<b>TAT21132</b> .010	<b>TRE27349</b> .010
	b) <b>TRE66820</b>	<b>TRE27360</b> .020	<b>TAT21134</b> .020	<b>TRE27358</b> .020
2) <b>TIK54709</b>	c) <b>TR124230</b>	<b>TRE27368</b> .030	<b>TAT21136</b> .030	<b>TRE27364</b> .030

Use 4

Use 1

Use 4

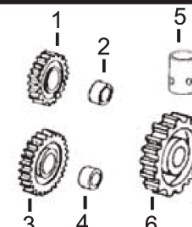
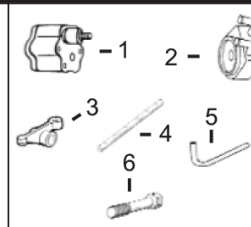
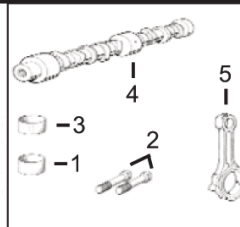
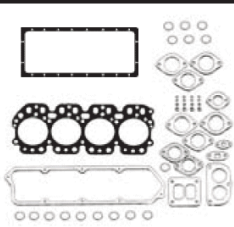
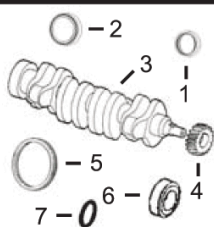

1) Front Seal 2) Rear Seal	1) O/H Gasket Set	1) Bush, Con Rod 2) Bolt, Con Rod 3) Bush, Bal. Shaft	1) Pump, Oil 2) Oil Cooler 3) Rocker Arm 4) Rocker Shaft 5) Pump, Oil Tube 6) Cyl Hd Cap Screw	1) Lower Gear 2) Lower Bushing 3) Upper Gear 4) Upper Bushing 5) Cam. Follower 6) Cam. Gear
-------------------------------	-------------------	---	---	--

3) Crankshaft 4) Crankshaft, Gear 5) Ring Gear 6) Sleeve, Front 7) Packing, Sleeve	2) Head Gasket Set 3) Head Gasket 4) Oil Pan Gasket 5) Rocker Cover Gsk	4) Camshaft 5) Con Rod		
1) <b>TAR67942</b> 2) <b>TRE44574</b> 3) <b>TAT18030</b> or <b>TRE20585</b> 4) <b>TT20094</b> 5) <b>TR114282</b> (142T) 6) <b>TR81989</b> 7) <b>TH35244</b>	1) <b>TRE501579</b> 2) <b>TRE38851</b> 3) <b>TR125863</b> 4) <b>TR97342</b> 5) <b>TR73521</b> or <b>TR106796</b> (2)	1) <b>TR57451</b> x4 2) <b>TR80033</b> x8 3) <b>TR57160</b> x6 (4) 4) <b>TR82820</b> (8) 5) <b>TRE58347</b>	1) <b>TRE55343</b> (3) 2) <b>TRE31929</b> 3) <b>TRE31973</b> 4) <b>TR54987</b> 5) <b>TR113752</b> 6) <b>TR85363</b> x18 (1)	1) <b>TAT24252</b> (6) 2) <b>TT26321</b> 3) <b>TAT18009</b> 4) <b>TT20034</b> (6) 5) <b>TT20073</b> 6) <b>TT20070</b> (6)



Valve, Intake

**TR98062** Std.  
**TR97490** .015

Valve, Exhaust

**TR90692** Std.  
**TR97492** .015

Insert, Valve

1) Intake  
2) Exhaust  
1) **TR98063** Std.  
**TR98335** O/S  
2) **TR85687** Std.  
**TR93910** O/S

1) Seal, Valve

2) Lock, Valve  
1) **TRE31617**  
2) **TR91889**

1) Spring, Valve

2) Rotator, Valve  
1) **TR26125**  
2) **TRE60005**

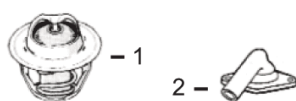

1) Thermostat  
2) Thermostat Cover

1) **TAR48675** 180° F (5)  
2) **TT23620**

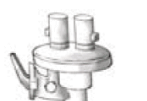

Fuel Transfer Pump

**TRE42211**  
**TRE38009** (7)



Water Pump Rep Kit  
a) Without Impeller  
b) With Impeller

See Chart



Water Pump

**TAR97708** (m) R73604  
**TRE60489** (m) R100812, (m) R127337,  
(m) R127918, (m) R55164,

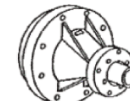

Water Pump

**TRE41157**

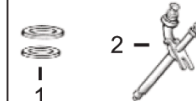

1) Seal, Injector  
2) Injector, Pencil

1) **TR60746**  
**TR48000**  
2) **TRE38087**

(1) Replace all R78558 Cap Screws with Flanged Head Cap Screw **TR85363**.

(2) Saran engines, O'ring not included in Gasket Set. Order separately.

(3) May use High Capacity Pump, Oil **TRE65580**.

(4) **TR91708** (Outer Diam. 2.00 mm / 0.078 in ) Larger and **TR57160R** (Inner Diam 0.5 mm / 0.020 in ) Smaller, are also available.

(5) Saran Engines may use **TRE64354**.

(6) Helicoidal Gears.

(7) Saran Engines.

(8) Threaded Type. For Late 4039 models **TRE55901** Kit (Camshaft, and **TR119874** Bushing) is available.