

**300 Series**  
**Engine & Equipment**  
**Model**

**4045T**

Liter Designated

4 Cyl

Bore: 4.19 in  
 106.5 mm  
 Pin Ø: 1.625 in  
 41 mm

**APPLICATIONS:**  
**AGRICULTURAL**  
 6400 6500L  
 6400L 6700  
 6500 SE6400

**CONSTRUCTION**  
 340D 510C  
 344G 510D  
 410C/D (T) 540D  
 440C 548D  
 444E/G 550/A/B/G  
 448D 555/A/B/G  
 450E/G 590D  
 455E/G 595D  
 490E 610B/C  
 495D 650G

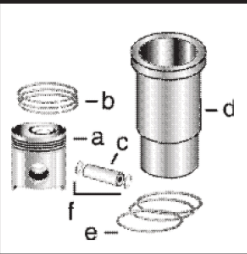

1) Engine O/H Kit

Piston-Liner Kit

Main Bearing

Thrust Bearing

Con Rod Bearing

2) Engine I/F Kit

**TRE53073**  
 Consists of:

**TRE27352** Std.

**TAT21139** Std.

**TAR97517** Std.

1) **TRE61612**

a) **TRE48469**

**TRE27353** .010

**TAT21132** .010

**TAR97653** .010

2) **TIK61612**

b) **TRE66820**

**TRE27360** .020

**TAT21134** .020

**TAR97654** .020

c) **TR124230**

**TRE27368** .030

**TAT21136** .030

**TAR97655** .030

d) **TR80500**

**Use 4**

**Use 1**

**Use 4**

e) **TAR65507**

f) **TR54114**

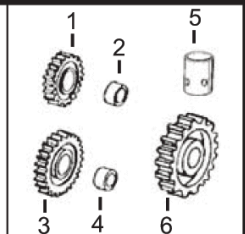
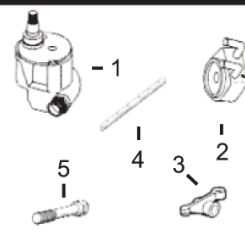
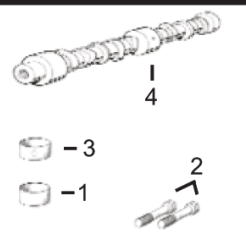
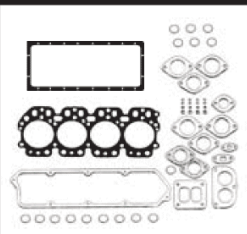
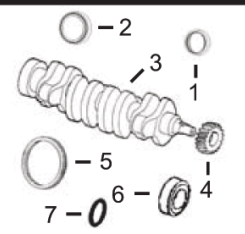

1) Front Seal  
 2) Rear Seal

1) O/H Gasket Set

1) Bush, Con Rod  
 2) Bolt, Con Rod  
 3) Bush, Bal. Shaft

1) Pump, Oil  
 2) Oil Cooler  
 3) Rocker Arm  
 4) Rocker Shaft  
 5) Cyl Hd Cap Screw

1) Lower Gear  
 2) Lower Bushing  
 3) Upper Gear  
 4) Upper Bushing  
 5) Cam. Follower  
 6) Cam. Gear

3) Crankshaft  
 4) Crankshaft, Gear  
 5) Ring Gear  
 6) Sleeve, Front  
 7) Packing, Sleeve

2) Head Gasket Set  
 3) Head Gasket  
 4) Oil Pan Gasket  
 5) Rocker Cover Gsk

4) Camshaft

1) **TAR67942**  
 2) **TRE44574**  
 3) **TRE56792** (\*)  
 4) **TT20094**  
 5) **TR28811** (129T)  
 or  
**TR114282** (142T)  
 6) **TR81989**  
 7) **TH35244**

1) **TRE501568**  
 2) **TRE38851**  
 3) **TR125863**  
 4) **TR97342**  
 5) **TR73521**

1) **TR57451** x4  
 2) **TR74195** x8 (7)  
 3) **TR57160** x6  
 4) **TR82820** (4)

1) **TRE65580** (1)  
 2) **TRE31929** (6)  
 3) **TRE31973**  
 4) **TR54987**  
 5) **TR85363** x18 (5)

1) **TAT24252**  
 2) **TT26321**  
 3) **TAT18009**  
 4) **TT20034**  
 5) **TT20073**  
 6) **TT20070**

Valve, Intake

Valve, Exhaust

Insert, Valve  
 1) Intake  
 2) Exhaust

1) Seal, Valve  
 2) Lock, Valve

1) Spring, Valve  
 2) Rotator, Valve

**TR98062** Std.  
**TR97490** .015

**TR90692** Std.  
**TR97492** .015

1) **TR98063** Std.  
**TR98335** O/S.  
 2) **TR85687** Std.  
**TR93910** O/S.

1) **TRE31617**  
 2) **TR91889**

1) **TR26125**  
 2) **TRE60005**

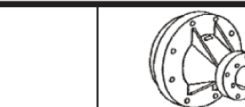
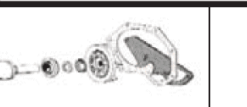
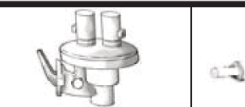

1) Thermostat  
 2) Thermostat Cover

Fuel Transfer Pump

Water Pump Rep Kit  
 a) Without Impeller  
 b) With Impeller

Water Pump

1) Seal, Injector  
 2) Injector, Pencil

1) **TAR48675** 180° F (2)  
 2) **TT23260**

**TRE42211**  
**TRE38009** (3)  
 See Chart

**TAR97708** (m) R73604  
**TRE60489** (m) R100812, (m) R127337,  
 (m) R127918, (m) R55164

**TRE41157**

1) **TR60746**  
**TR48000**  
 2) **TRE38087**

(\*) Crankshaft (m) R54501. This Engines model may also use crankshaft **TRE54883** 60mm Snout; (m) R90825, R120009. PLEASE VERIFY.  
 (1) Saran engines use **TRE55343** Standard flow.  
 (2) Saran engines may use **TRE64354**.  
 (3) Saran engines  
 (4) Threaded Type. For Late 4039 models **TRE55901** Kit (Camshaft, Tappets and **TR119874** Bushing) is available.  
 (5) Replace all R78558 Cap Screws with Flanged Head Cap Screw **TR85363**.  
 (6) Always verify Oil Cooler Type.  
 (7) When used on connecting rods marked R56187, torque bolts to 95 ft.lbs.